

25
YEARS

SERVING
BEACONSFIELD
SINCE 1998



39 Elmers Court, Post Office Lane, Beaconsfield

Guide Price £369,950

Ashington Page

Spacious one bedroom, one bathroom and one reception room apartment with private roof terrace, ideally located in Beaconsfield New Town with no onward chain. Situated on the third floor, the apartment benefits from its own private roof terrace area offering views across the town. The New Town high street is a few minutes' walk away, with its choice of shops, bars, restaurants and station with direct links to London Marylebone

EPC : C

Leasehold : 105 years remaining. (125 from 2004)

Service charge: Approx (tbc) pa plus any top up's

Ground rent: £350 pa

Council Tax D

These particulars are for guidance only. They are prepared and issued in good faith and are intended to give a fair summary of the property. Any description should not be relied on as a statement or representation of fact or that the property, or its services, are in good condition. The photographs show only certain parts of the property at the time they were taken. Any areas, measurements or distance given are approximate only. Any reference to alterations to, or use of, any part of the property is not a statement that any necessary planning, building regulations or other consent has been obtained. These matters must be verified by an intending purchaser. All statements contained in these particulars in relation to the property are made without responsibility of Ashington Page or its clients. Neither Ashington Page (nor any joint agents) nor any of their employees has any authority to make or give any representation or warranty whatsoever in relation to the property

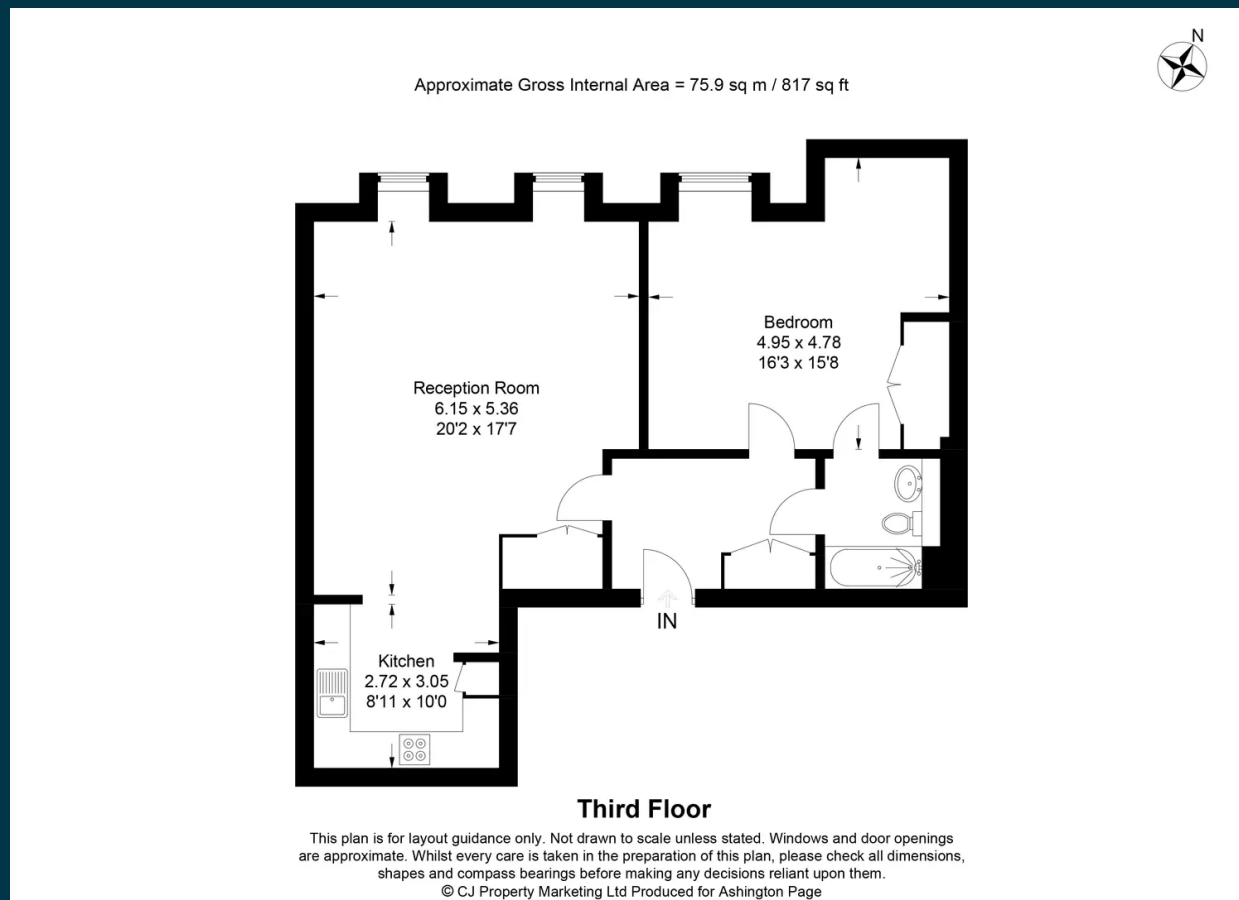

01494 680018
info@ashingtonpage.co.uk
www.AshingtonPage.co.uk

