



Queensland Avenue, Chapelfields, Coventry CV5 8FG

Guide Price: £240,000





## Queensland Avenue

Chapelfields, Coventry

Renovated throughout, this period 3-bed property, with a blend of charming features & modern finishes, has a stunning Minton tile floor, 2 reception rooms & stylish kitchen. Generous bedrooms, renovated to high standard. Envidable location in central Earlsdon. Private rear garden with garage.

Council Tax band: D

Tenure: Freehold

EPC Energy Efficiency Rating: C

- Lovely period home with three first floor bedrooms
- Minton tile flooring leading to two lovely reception rooms
- Newly fitted, modern and stylish kitchen
- First floor WC
- Renovated throughout to a high standard
- Great location just a stone's throw from central Earlsdon
- Fantastic rear garden







### Ground Floor

Approx. 48.1 sq. metres (517.8 sq. feet)

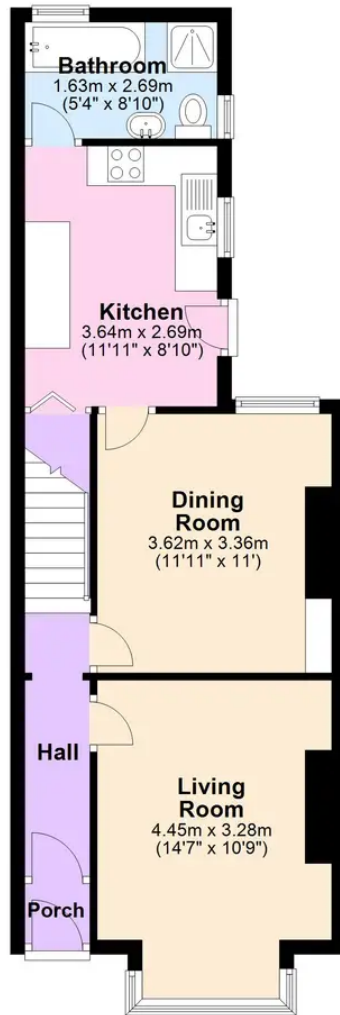

### First Floor

Approx. 41.6 sq. metres (447.7 sq. feet)



Total area: approx. 89.7 sq. metres (965.5 sq. feet)

This floor plan is for illustrative purposes only and should be used as such by any prospective purchaser. Whilst every attempt has been made to ensure the accuracy of this plan, measurements of doors, windows, rooms and other items are approximate and no responsibility is taken for any error, omission or mis-statement.  
Plan produced using PlanUp.

## Coopers Estate Agents

Coopers, 22 New Union Street - CV1 2HN

024 7655 2841 • [sales@coopersestateagents.com](mailto:sales@coopersestateagents.com) • [www.coopersestateagents.com/](http://www.coopersestateagents.com/)

Coopers Chartered Surveyors Ltd, 22 New Union Street, Coventry, West Midlands

CV1 2HN, 024 7655 2841, [sales@coopers-cov.com](mailto:sales@coopers-cov.com). Company Registration

Number: 6725089 / VAT number: 940 3555 34