

56 California Crescent, California

£350,000 Freehold

GUIDE PRICE: £350,000-£375,000. Stunning detached bungalow with luxury fittings, beautiful views, LED lighting, jacuzzi-style bath, and terraced hot tub area. Spacious interiors, converted garage, and prime location. Ideal for those seeking a premium living experience.

Council Tax band: C

Tenure: Freehold

GUIDE PRICE: £350,000-£375,000. Stunning detached bungalow with luxury fittings, beautiful views, LED lighting, jacuzzi-style bath, and terraced hot tub area. Spacious interiors, converted garage, and prime location. Ideal for those seeking a premium living experience.

LOCATION

This bungalow, located in California, Norfolk, is a coastal gem offering residents stunning ocean views and a tranquil atmosphere. This crescent-shaped neighbourhood boasts well-maintained landscapes and diverse architecture, creating a perfect blend of coastal charm and modern living. Just a short distance from the beach, it provides easy access to local amenities, making it an ideal spot for those seeking a peaceful seaside retreat.

CALIFORNIA CRESCENT, CALIFORNIA

Introducing this stunning detached bungalow, is unique within the market, boasting a combination of luxury, style, and a premium living experience. Located

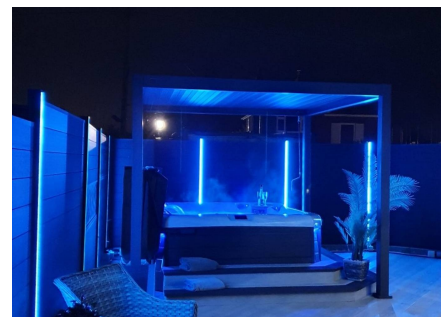

GUIDE PRICE: £350,000-£375,000. Stunning detached bungalow with luxury fittings, beautiful views, LED lighting, jacuzzi-style bath, and terraced hot tub area. Spacious interiors, converted garage, and prime location. Ideal for those seeking a premium living experience.

LOCATION

This bungalow, located in California, Norfolk, is a coastal gem offering residents stunning ocean views and a tranquil atmosphere. This crescent-shaped neighbourhood boasts well-maintained landscapes and diverse architecture, creating a perfect blend



GUIDE PRICE: £350,000-£375,000. Stunning detached bungalow with luxury fittings, beautiful views, LED lighting, jacuzzi-style bath, and terraced hot tub area. Spacious interiors, converted garage, and prime location. Ideal for those seeking a premium living experience.

LOCATION

This bungalow, located in California, Norfolk, is a coastal gem offering residents stunning ocean views and a tranquil atmosphere. This crescent-shaped neighbourhood boasts well-maintained landscapes and diverse architecture, creating a perfect blend of coastal charm and modern living. Just a short distance from the beach, it provides easy access to local amenities, making it an ideal spot for those seeking a peaceful seaside retreat.

CALIFORNIA CRESCENT, CALIFORNIA

Introducing this stunning detached bungalow, is unique within the market, boasting a combination of luxury, style, and a premium living experience. Located in a sought-after area, this three-bedroom property offers a seamless blend of modern aesthetics and practicality.

As you enter, you are greeted by an exquisite Howdens fitted kitchen, adorned with sleek quartz worktops, the perfect space for culinary delights. The integrated appliances, including a wine cooler, ensure convenience while entertaining guests. LED lighting throughout enhances the elegance and creates a warm ambience throughout the property.

The spacious living area features a beautiful entrance sunroom, which leads you into the lobby and introduces you to the rest of the house. Every corner has been thoughtfully designed to maximise comfort and functionality. Marvel at the jacuzzi-style bathtub in the luxury bathroom, creating a haven of relaxation.

The property boasts three generously sized double bedrooms, offering ample space for personalisation. The en-suite cloakroom adds convenience and privacy for you and your guests. With a beautifully presented modern aesthetic, every detail has been carefully considered to create an inviting and stylish atmosphere.

Step outside and be captivated by the breathtaking sea views from the rear of the property. The conservatory, a delightful spot during the day with beautiful sea views, becomes a stargazing haven during the night-time. Immerse yourself in nature's beauty



GROUND FLOOR

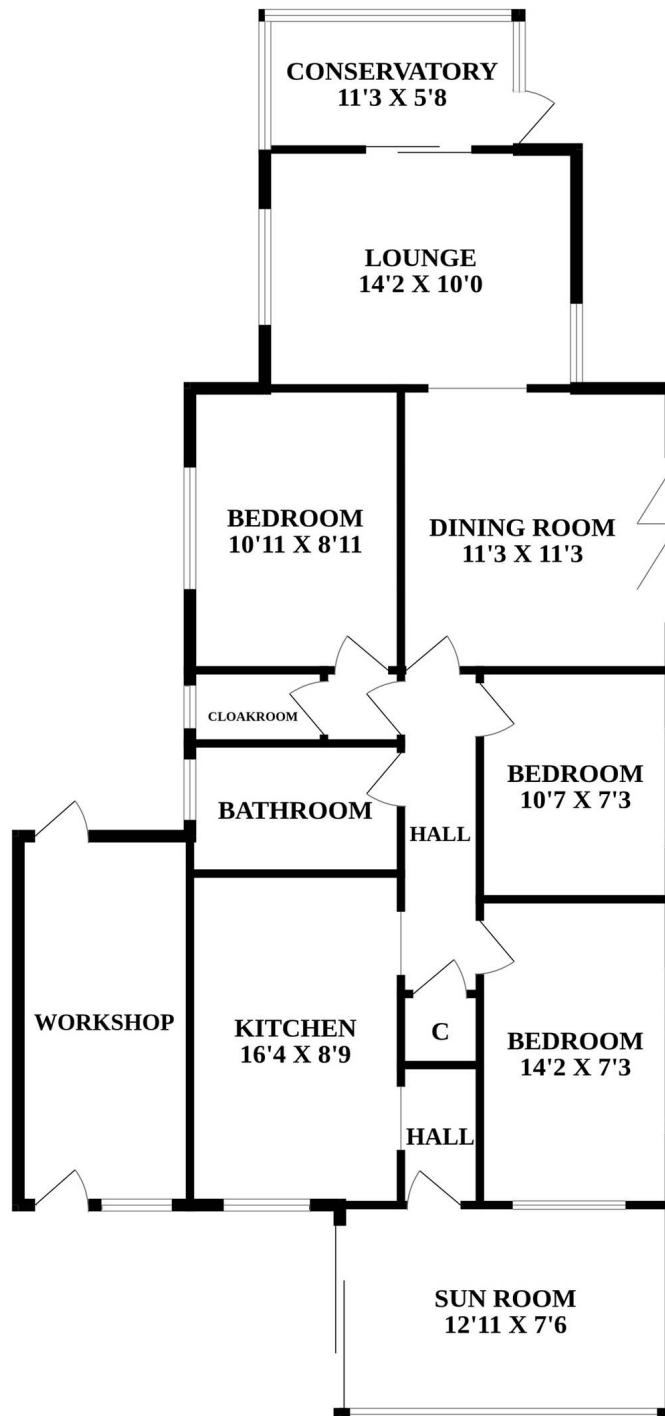

Whilst every attempt has been made to ensure the accuracy of the floorplan contained here, measurements of doors, windows, rooms and any other items are approximate and no responsibility is taken for any error, omission or mis-statement. This plan is for illustrative purposes only and should be used as such by any prospective purchaser. The services, systems and appliances shown have not been tested and no guarantee as to their operability or efficiency can be given.
Made with Metropix ©2023

You can include any text here. The text can be modified upon generating your brochure.

You can include any text here. The text can be modified upon generating your brochure.

