



MILE



Waldo Road, London NW10 £1,100,000 Freehold

Welcome to this stunning architecturally designed Victorian mid-terrace house nestled on Waldo Road. Boasting an incredibly high specification throughout, this residence offers the epitome of modern comfort within a charming Victorian facade. Spanning across 1657 square feet, this meticulously crafted home features three generously proportioned double bedrooms and two bathrooms (further third guest WC) across three floors providing ample living space. This period home benefits from a south-facing garden, bathed in sunlight throughout the day, offering an inviting outdoor oasis for a fresco dining, entertaining guests, or simply unwinding amidst nature's tranquillity. You are unlikely to see a better house this year, from its elegant architectural design to its premium finishes and thoughtful layout, this Victorian home presents a rare opportunity. Situated on this quiet residential road, any potential home owner can relish in the peace and serenity of their surroundings while remaining conveniently close to the vibrant amenities and attractions London has to offer.

- Victorian home
- Three double bedrooms
- Incredibly high spec
- South facing garden
- 1657 sq ft
- Two bathrooms
- 27ft kitchen diner
- Hammersmith & Fulham borough
- Close to shops and restaurants

Waldo Road, NW10 6AU

Approx Gross Internal Area = 154 sq.m / 1657 sq.ft

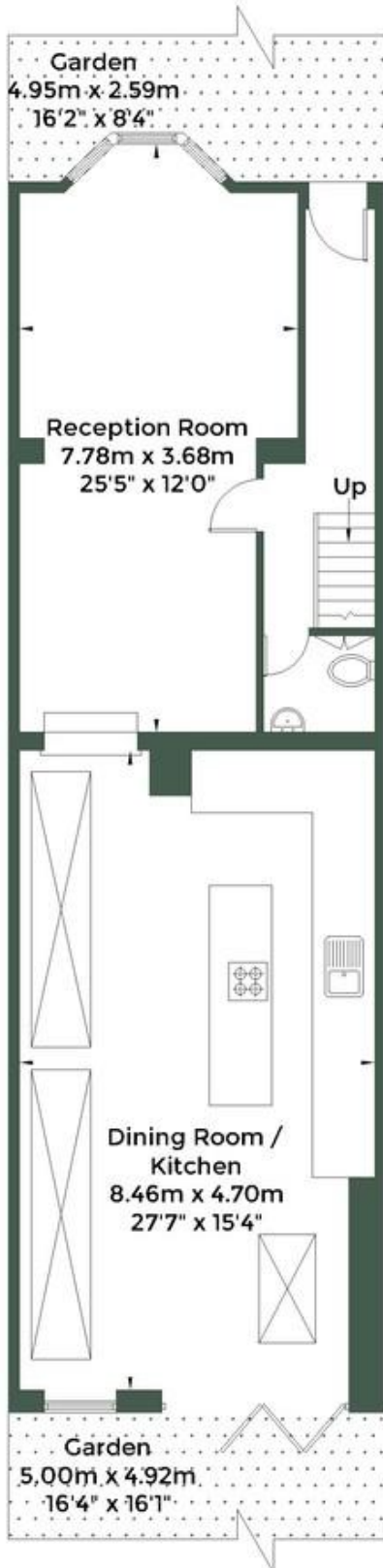

Ground Floor



First Floor



Second Floor



MONEY LAUNDERING REGULATIONS 2003: Intending purchasers will be asked to produce identification documentation at a later stage and we would ask for your co-operation in order that there will be no delay in agreeing the sale.

General: While we endeavour to make our sales particulars fair, accurate and reliable, they are only a general guide to the property and, accordingly, if there is any point which is of particular importance to you, please contact the office and we will be pleased to check the position for you, especially if you are contemplating travelling some distance to view the property.

Measurements: These approximate room sizes are only intended as general guidance. You must verify the dimensions carefully before ordering carpets or any built-in furniture.

Services: Please note we have not tested the services or any of the equipment or appliances in this property, accordingly we strongly advise prospective buyers to commission their own survey or service reports before finalising their offer to purchase.