



**5 Marine Court,**  
The Esplanade, Frinton-on-Sea, Essex, CO13 9AT

FINE & COUNTRY









## PROPERTY DESCRIPTION

Introducing a captivating two-bedroom apartment, seamlessly available with no onward chain, and meticulously presented to showcase unparalleled elegance. Nestled within a discreet enclave, this residence boasts panoramic sea views that will undoubtedly steal your breath away.

As you approach, the property reveals its exclusivity with a side entrance shared only with two other apartments, ensuring a private and serene ambiance. Step inside and discover a haven of tranquility, where the meticulous attention to detail is evident in every corner. As a unique feature, this property comes with its own utility cupboard at the top of the stairs.

The focal points of this residence are the lovely reception/dining room and the south/east-facing balcony, a spacious retreat perfect for unwinding while basking in the awe-inspiring vistas that stretch across the beach and beyond. Picture yourself enjoying your morning coffee or entertaining guests against the backdrop of the sun-kissed waves.

The modern and well-equipped kitchen is a culinary delight, featuring an electric oven with an overhead extractor hood, an induction hob, and ample storage units. It is designed to cater to the needs of both seasoned chefs and everyday cooks, ensuring a seamless culinary experience.

The principal bedroom is a sanctuary of natural light and open space, providing an inviting atmosphere to retreat at the end of the day. The bathroom exudes sophistication with a "D" shaped bath, shower over, and a curved splashback screen, adding a touch of luxury to your daily routine.

Beyond the confines of the apartment, practical amenities include a garage and off-street parking, offering convenience and security. Immerse yourself in the well-maintained communal gardens, a peaceful oasis where nature meets sophistication.

Perfectly situated within walking distance of local shops, vibrant coffee shops/bars, and delectable restaurants, this residence caters to the desire for a dynamic lifestyle. Moreover, the proximity to the beach, with its endless possibilities for relaxation and recreation, complements the allure of coastal living.

For those with an eye on the city, the nearby train station provides quick and frequent links to London, seamlessly connecting you to the bustling heart of the capital. Embrace the fusion of coastal serenity and urban accessibility – your new home awaits.



















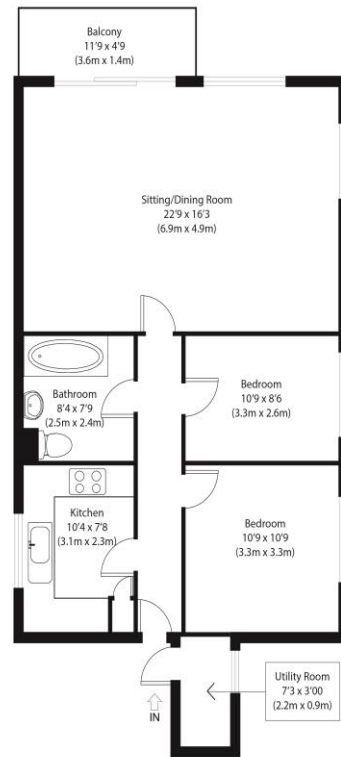

Second Floor  
Approximate Gross Internal Area  
920 sq ft (85 sq m)

Disclaimer: Floorplan measurements are approximate and are for illustrative purposes only. While we do not doubt the floor plan accuracy and completeness, you or your advisors should conduct a careful, independent investigation of the property in respect of monetary valuation. copyright www.sghphoto.co.uk

FINE & COUNTRY