



11 Clifton Grove, Paignton

Paignton

£225,000

ABSOLUTE



11 Clifton Grove

Paignton, Paignton

Delightful 3-bed terraced home with modern charm and wheelchair access. Spacious lounge with fireplace, kitchen/diner, modern bathroom, fitted wardrobes. On-street parking, patio, tiered garden, close to town, no onward chain. A blend of comfort and practicality.

Council Tax band: B

Tenure: Freehold

EPC Energy Efficiency Rating:

EPC Environmental Impact Rating:

- Three bedroom terraced
- No onward chain
- Modern facias and well maintained
- Accessible ramp for wheelchair access
- Spacious lounge with fireplace
- Kitchen/diner
- Modern bathroom
- Fitted wardrobes in the main bedrooms
- Cul de sac location close to town
- Council tax band B/ EPC rating C



11 Clifton Grove

Paignton, Paignton

Quiet cul de sac off Clifton Road providing a modern family home with the convenience of being close to the Paignton town centre and local transport services like the train and bus station. Council tax band B/ EPC rating C

Absolute Sales & Lettings

Absolute Sales & Lettings, 27 Hyde Road - TQ4 5BP

01803 890110

paignton@movewithabsolute.co.uk

<http://www.movewithabsolute.co.uk>



Ground Floor

Approx. 39.5 sq. metres (424.7 sq. feet)

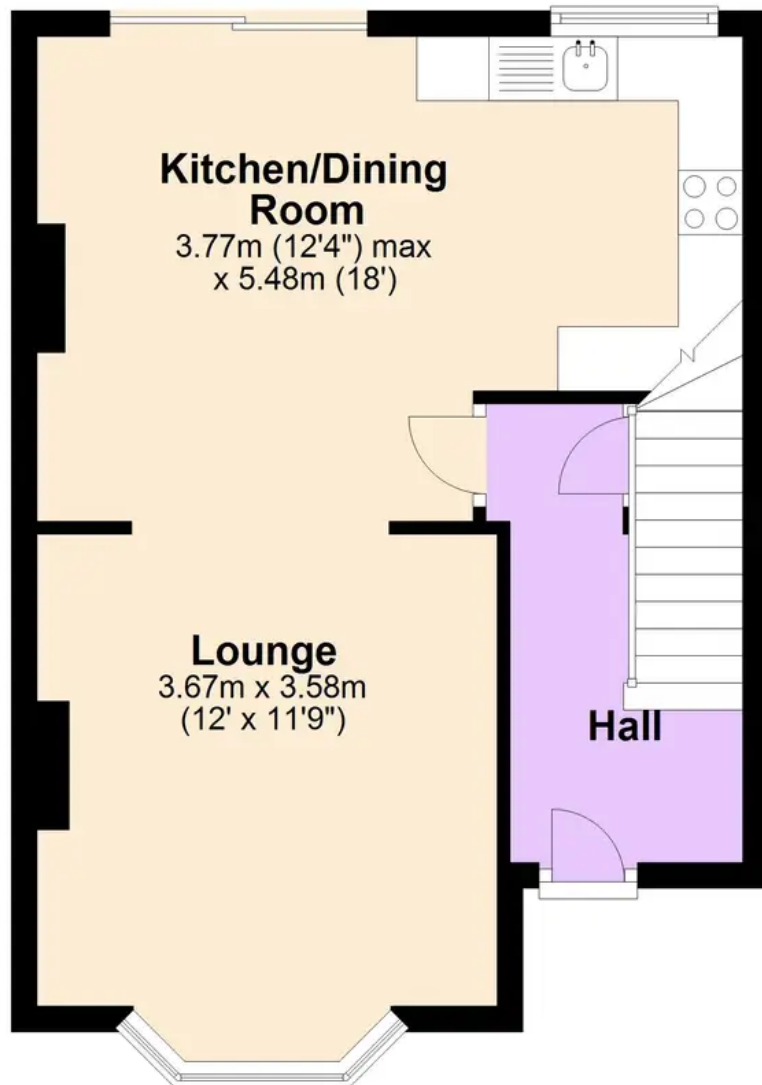

First Floor

Approx. 41.1 sq. metres (442.1 sq. feet)

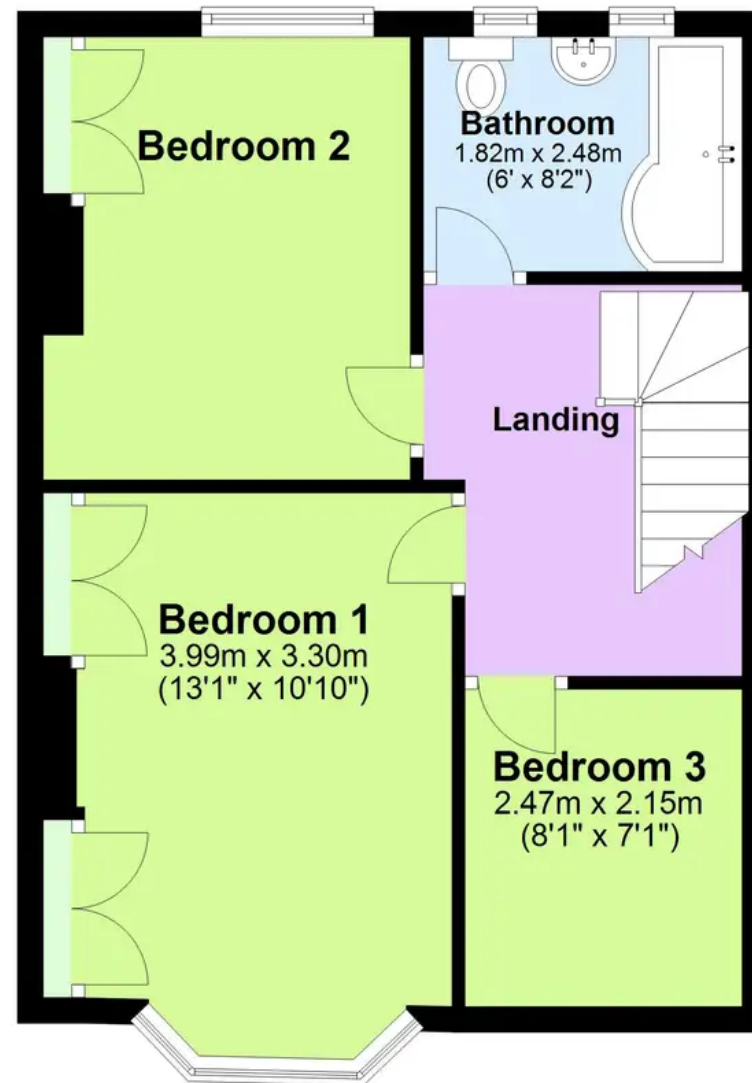

Total area: approx. 80.5 sq. metres (866.8 sq. feet)

Approx
Plan produced using PlanUp.

