

Ensign House, Battersea Reach
London, SW18 1TR

PROPERTY SUMMARY

A stunning and unique three bedroom apartment located on the eleventh floor of this award winning riverside development. This apartment covers in excess of 1200sqft with 1 parking space included in the sale. Battersea reach offer an onsite residence only gym and 24 hour concierge service.







Ensign House,
Juniper Drive, SW18
Approximate Gross Internal Area
112.46 sq m / 1,211 sq ft

(CH = Ceiling Heights)

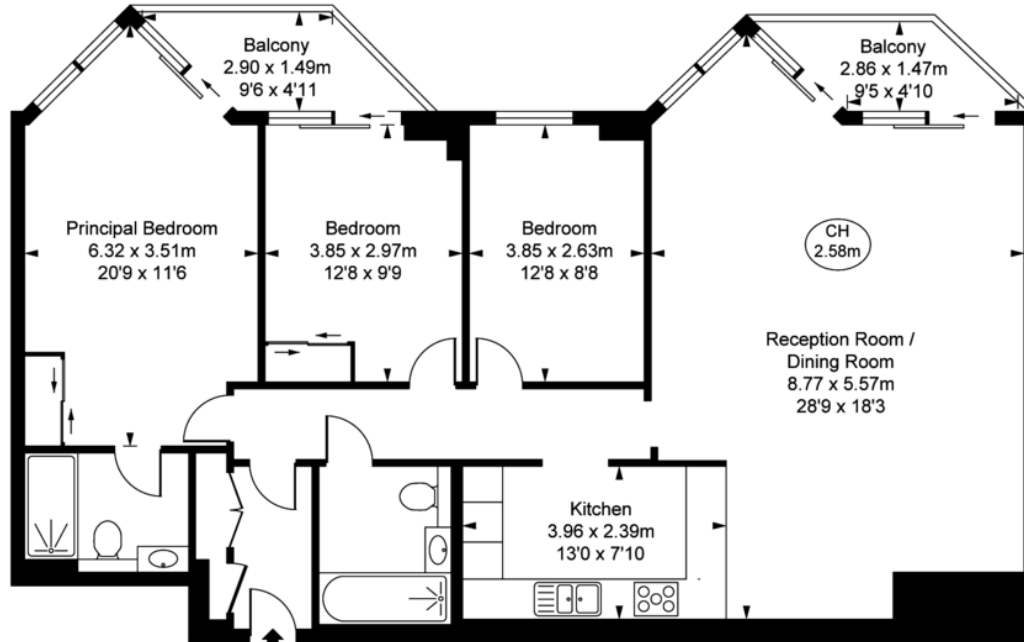

Eleventh Floor

This plan is not to scale. It is for guidance and not for valuation purposes.
All measurements and areas are approximate only, and have been prepared in accordance with the current edition of the RICS Code of Measuring Practice.
© Fulham Performance

LOCAL AUTHORITY
Wandsworth Borough Council

TENURE
Freehold

COUNCIL TAX BAND
Band

VIEWINGS
By prior appointment only

Energy Efficiency Rating		Current	Potential
Very energy efficient - lower running costs			
(92-100)	A		
(81-91)	B		
(69-80)	C	71	71
(55-68)	D		
(39-54)	E		
(21-38)	F		
(1-20)	G		
Not energy efficient - higher running costs			
England, Scotland & Wales		EU Directive 2002/91/EC	

Agents Note: Whilst every care has been taken to prepare these particulars, they are for guidance purposes only. All measurements are approximate and are for general guidance purposes only and whilst every care has been taken to ensure their accuracy, they should not be relied upon and potential buyers/tenants are advised to recheck the measurements



4 Vicentia Court
Bridges Wharf
London
SW11 3GY

02073522455
info@hgproperty.co.uk
www.hgproperty.co.uk