



South View Terrace, Plymouth, PL4 9DJ

£210,000 Freehold EPC:TBC





## South View Terrace

Charming 3-bedroom Victorian house in Plymouth's desirable St. Judes. Property features lounge, dining room, kitchen, and bathroom. Freehold with potential for updates. Courtyard garden, ideal location near amenities and city centre. Offers invited for this characterful home with enhancement opportunities.

Council Tax band: B

Tenure: Freehold

- Mid Terrace Late Victorian House
- 3 Bedrooms
- Lounge
- Dining Room
- Kitchen
- Bathroom
- Courtyard Garden
- Freehold
- Situated in St. Judes, Plymouth
- Convenient Location





## South View Terrace

Introducing this charming mid-terraced late Victorian house set within the desirable location of St. Jude's in Plymouth. This well-proportioned property boasts three bedrooms, a lounge, dining room, kitchen, and bathroom, offering ample living space suitable for a variety of lifestyles.

Upon entering, you are greeted by a welcoming lounge, perfect for relaxing or entertaining guests. The dining room provides a separate area for family meals or social gatherings. The kitchen, though requiring modernisation, presents an opportunity for the new owners to create a space tailored to their taste and needs. Completing the accommodation on the first floor are three bedrooms, each offering a comfortable retreat for occupants.

This property is offered as freehold, providing buyers with security and flexibility. The bathroom, like the kitchen, could benefit from updating, presenting a chance for the new owners to add their personal touch. A courtyard garden at the rear offers a private outdoor space, ideal for enjoying moments of tranquillity or al fresco dining. Although requiring some care, the courtyard holds potential to be transformed into a delightful area for relaxation and enjoyment.



South View Terrace, Plymouth, PL4

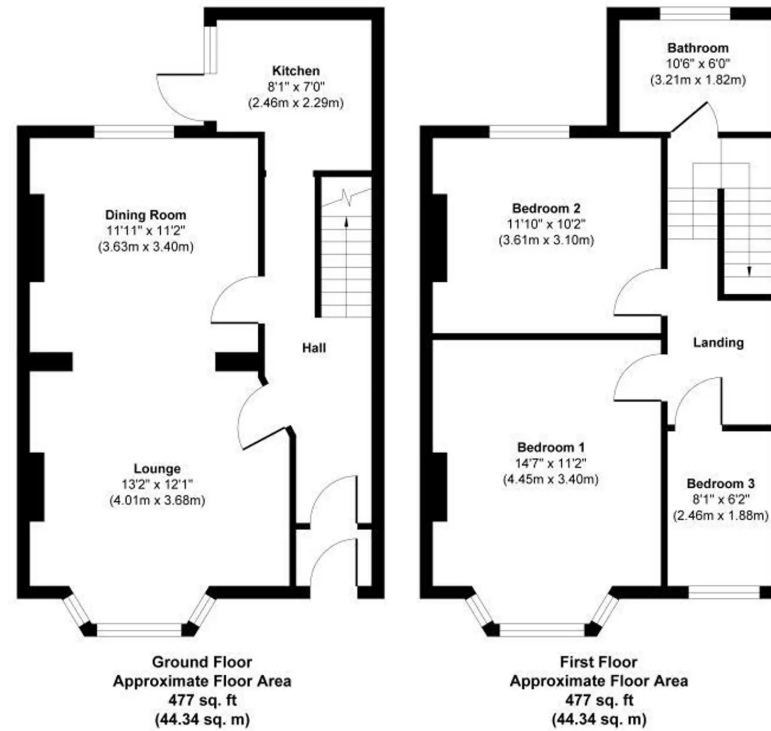

Approx. Gross Internal Floor Area 954 sq. ft / 88.68 sq. m  
Illustration for identification purposes only, measurements are approximate, not to scale

# Atwell Martin

Atwell Martin, 65 Southside Street – PL1 2LA

01752 202121

[plymouthsales@atwell-martin.co.uk](mailto:plymouthsales@atwell-martin.co.uk)

[plymouth.atwellmartin.co.uk/](http://plymouth.atwellmartin.co.uk/)

Atwell Martin Plymouth endeavour to ensure the accuracy of property details produced and displayed. Please note that we have not tested any apparatus, equipment, fixtures, fittings or services and so cannot verify that they are connected, in working order or fit for purpose. It is imperative that the buyer of any property makes such checks, prior to purchase so as to satisfy themselves of the properties suitability for their purchase. .