

HOME  TRUTHS



118 Towngate, Ecclestone

PR7 5QS



£975 pcm



Three bedroom semi-detached property with private garden overlooking countryside and detached garage situated in the sought after village of Ecclestone and close to all local amenities including shops and schools. Available to let immediately.

Step through the entrance hall into the spacious lounge with bay fronted window and feature gas fireplace with tiled surround. The second reception room which could be utilised as a dining room has double doors which can separate both rooms or allow it to be open plan. The kitchen has a range of wall and base units with contrasting work surfaces, stainless steel sink unit, free standing electric cooker and hob and under counter fridge.

Carpeted stairs lead to the first floor with two good sized double bedrooms, one with built in wardrobes and a comfortable single. The new bathroom suite comprises a panelled bath with shower over, wash hand basin and wc.

The garden is mainly laid to lawn with patio area. The detached garage is a great space for additional storage and has light and power for additional white goods. There are extra storage sheds with extra power and heating facilities.



The property has been neutrally decorated throughout and is available now. This property requires a deposit of £1125 including holding deposit of £225. The Zero Deposit Scheme is also available.

Council Tax Band: C

EPC Rating: E

- Three bedrooms
- Two reception rooms
- Garage and storage sheds
- Lovely views to the rear
- New boiler and bathroom suite
- Available now
- Zero Deposit Scheme available



HOME  TRUTHS

Eccleston Branch
265 The Green, Eccleston, PR7 5TF
01257 451673

Coppull Branch
244 Spendmore Lane, Coppull, PR7 5DE
01257 794588

www.hometruthslancs.co.uk
office@hometruthslancs.co.uk



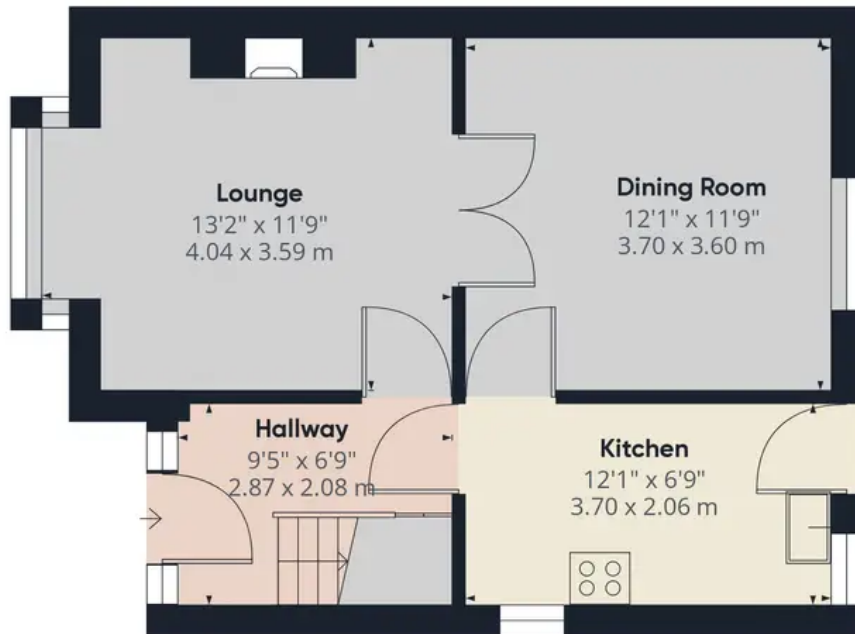

Floor 1

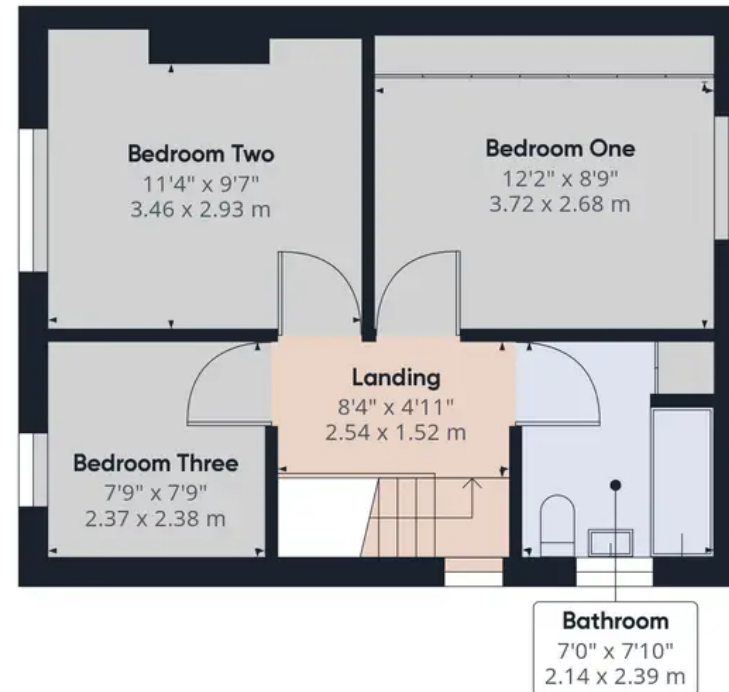

Floor 2

Approximate total area⁽¹⁾
853.71 ft²
79.31 m²

(1) Excluding balconies and terraces

While every attempt has been made to ensure accuracy, all measurements are approximate, not to scale. This floor plan is for illustrative purposes only.