

## Stockwell Road, Stockwell, London, SW

Approximate Area = 409 sq ft / 38 sq m

For identification only - Not to scale

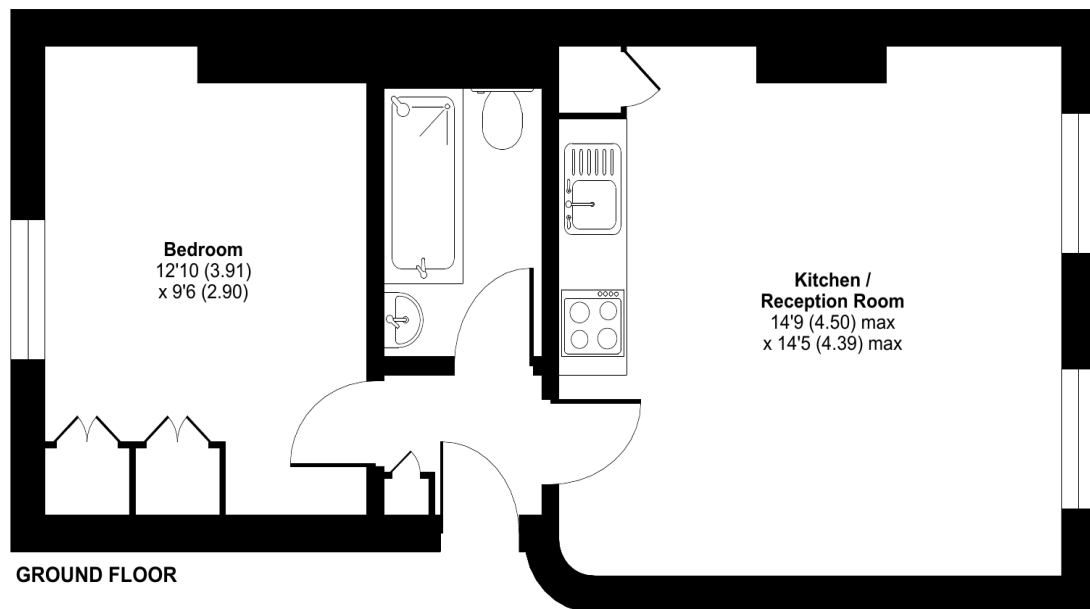

Certified  
Property  
Measurer

Floor plan produced in accordance with RICS Property Measurement Standards incorporating International Property Measurement Standards (IPMS2 Residential). © richcom 2024. Produced for Independent London Ltd. REF: 1086496

Furnished: No

Garden: No

Bedrooms: 1

Bathrooms: 1

Parking: Permit

Location: Stockwell

Type: Period

Council Tax Band: C

EPC Rating: C

Nearest Transport:

Stockwell for Northern Line

Brixton, Trains, South Eastern

Buses

2, N2, P5, 50, 88, 155, N155,

196, 333 and 345

All rooms have been measured with electronic laser and are approximate measurements only. None of the services to the above property have been tested by ourselves, and we cannot guarantee that the installations described in the details are in perfect working order. Independent London Lettings for themselves, and for the vendors or lessors, produce these brochures in good faith, and are a guideline only. They do not constitute any part of a contract and are correct to the best of our knowledge at the time of going to press.

Independent London

6-8 Cole Street, Trinity Village,

London SE1 4YH

t: 020 7099 6373

e: hello@independentlondon.net

[independentlondon.co.uk](https://www.independentlondon.co.uk)

Landlords ask for The 5% Let Only

Service from Independent London

independent  
london.



Right place. Right people.