



Oakwood homes[®]
putting people first

Property brochure



GAINSBOROUGH DRIVE
HERNE BAY
KENT
CT6 6QJ

Price: £550,000

3 Bedrooms

1 Reception

2 Bathrooms

1 Garage

EPC D

Tenure FREEHOLD
Council Tax E



birchington@oakwoodhomes.biz



01843 842233



www.oakwoodhomes.biz

Sales | Lettings | Property Management | Land Acquisition | Development Consultancy | New Homes | Mortgages | Conveyancing

Oakwood homes is a trading name of Oakwood homes Estate Agents Ltd whose registered office is at Stockwell House, Cecil Square, Margate, Kent CT9 1BD



Oakwood homes[®]
putting people first

Property brochure



The Property

A chain free three bedroom detached bungalow in a cul-de-sac location of Beltinge village with cliff top walks and fresh sea air on your doorstep! If you are looking to get away from the rat race and enjoy some seaside living this could be the home for you. The property is designed with flexible living in mind with large lounge in excess of 23' (7.01m) located to the front, a bedroom/office, leading off to a conservatory with access to the garden, family bathroom, double bedroom to the front and master bedroom with en-suite. The kitchen/diner in excess of 25' (7.62m) offers a fantastic social aspect to the home, ideal for a family with children or couples looking to host. Opening onto a conservatory, this lends itself to an alternative dining room or a garden room to sit and enjoy the view. Outside to the front there is a drive way for several vehicles and a detached garage with an electric door. The rear private garden is a fantastic size for a family with children, or green fingered viewers, with a lawn and seating patio areas. A large workshop with power and light, makes a fantastic man cave. With so much space on offer, this would make a fabulous family home, is ideal for home workers, or down sizers looking to accommodate family visits. The local village has an array of shops, a village pub and there is a highly recommended primary school located in nearby Reculver. Herne Bay town is a bus or car ride away, and its possible to walk or cycle all the way along the beautiful coastline too. What are you waiting for? Call Oakwood homes to book your viewing!

Location

Herne Bay is a seaside town in Kent, located 6 miles north of Canterbury with its stunning Cathedral and bustling High Street and its many shops, popular bars and restaurants. Just 4 miles to the east is the town of Whitstable which has a wealth of lovely shops and popular seafood restaurants which the town is renowned for. Herne Bay itself neighbours the ancient villages of Herne and Reculver and is part of the City of Canterbury local government district.

Accommodation

Entrance Porch	
Lounge	23'6" (7.16m) x 15'9" (4.80m)
Bedroom 3/office	10'5" (3.17m) x 9'5" (2.87m)
Conservatory	12'3" (3.73m) x 7'5" (2.26m)
Bedroom 2	13'3" (4.04m) x 9' (2.74m) not in to built in wardrobes
Bathroom	5'7" (1.70m) x 9' (2.74m)
Main Bedroom	16' (4.88m) x 9'5" (2.87m) not in to built in wardrobes
En-Suite	9'4" (2.84m) x 5'8" (1.73m)
Kitchen/Diner	25' (7.62m) x 11' (3.35m)
Conservatory	14'4" (4.37m) 9'5" (2.87m)

OUTSIDE

Driveway to front for several cars leading to the garage 16'9" (5.11m) x 10' (3.05m) with power and light. Rear garden is laid to lawn and patio with two seating areas. Large timber workshop with power and light



birchington@oakwoodhomes.biz



01843 842233



www.oakwoodhomes.biz

Sales | Lettings | Property Management | Land Acquisition | Development Consultancy | New Homes | Mortgages | Conveyancing

Oakwood homes is a trading name of Oakwood homes Estate Agents Ltd whose registered office is at Stockwell House, Cecil Square, Margate, Kent CT9 1BD



Oakwood homes[®]
putting people first

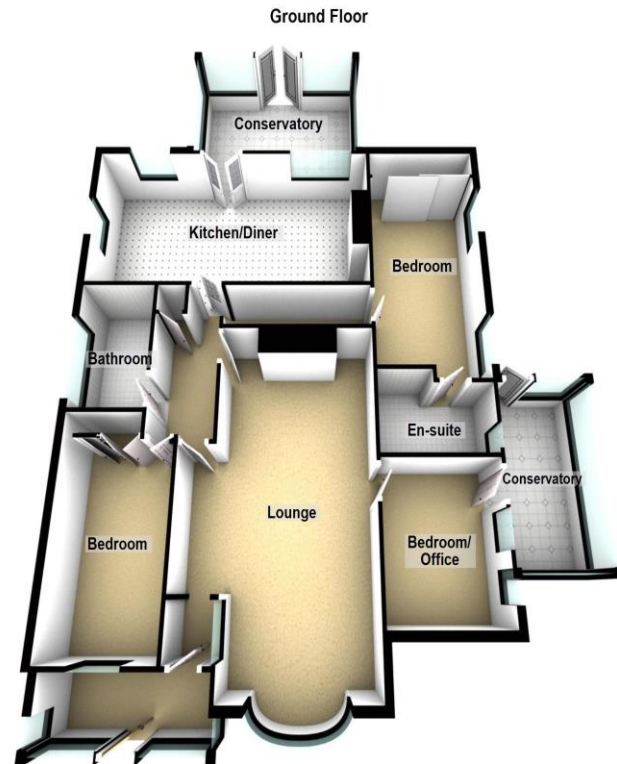

© Copyright Oakwood homes - Not to be reproduced or copied without permission. All rights reserved.
Plan produced using PlanUp.

Property brochure

Key Features

- Chain free! Short walk to the beach
- Fantastic flexible living space
- Detached garage
- Driveway
- Workshop
- A superb family home
- En-suite off master bedroom
- Kitchen/diner in excess of 25' (7.62m)
- Excellent sized plot

Need a mortgage..?

For impartial advice, why not talk to one of our qualified mortgage advisors?

0800 035 0353



Agent's Note: None of the appliances or services have been tested and prospective purchasers should satisfy themselves as to their condition. BIR0020173/20240220/AWDP



birchington@oakwoodhomes.biz



01843 842233



www.oakwoodhomes.biz



Sales | Lettings | Property Management | Land Acquisition | Development Consultancy | New Homes | Mortgages | Conveyancing
Oakwood homes is a trading name of Oakwood homes Estate Agents Ltd whose registered office is at Stockwell House, Cecil Square, Margate, Kent CT9 1BD