



- Two bedroom apartment
- Ground floor
- Master bedroom with ensuite
- Long Lease

Flat 10 Willow Court, Springwell Lane, Rickmansworth, WD3 8UZ

Guide Price £365,000

Andrews Residential are delighted to present to the market this spacious two-bedroom two-bathroom ground floor apartment. Located in a quiet semi rural location close to Rickmansworth this beautiful property benefits from tranquil side settings. Offered to the market with the benefit of NO ONWARD CHAIN- internal viewings are strongly recommended to avoid disappointment.



Property Description

PROPERTY

The accommodation briefly comprises of a spacious reception room with French patio doors leading to the communal grounds, modern fitted kitchen, master bedroom with ensuite shower room and a further bedroom and family bathroom.

OUTSIDE

Outside are well maintained communal grounds with waterside views, allocated parking space and visitors parking.

LOCATION

The property is in a quiet residential development with a waterside view overlooking the Grand Union Canal. The property is in a semi rural location but offers easy access to Rickmansworth with its superb transport facilities, Metropolitan line station and a variety of bars, restaurants, and shops. The property is also a short distance away from the M25 motorway providing easy access to Heathrow Airport & additional motorway networks.

TENURE

Leasehold Sale

100 years remaining on the lease

Council Tax Band: E

Ground rent: £200 per year

Service Charge: £2824.35 for 1st January – 31st December 2023.

EPC rating: C





Willow Court WD3

Approximate Gross Internal Floor Area = 73.9 sq m / 796 sq ft

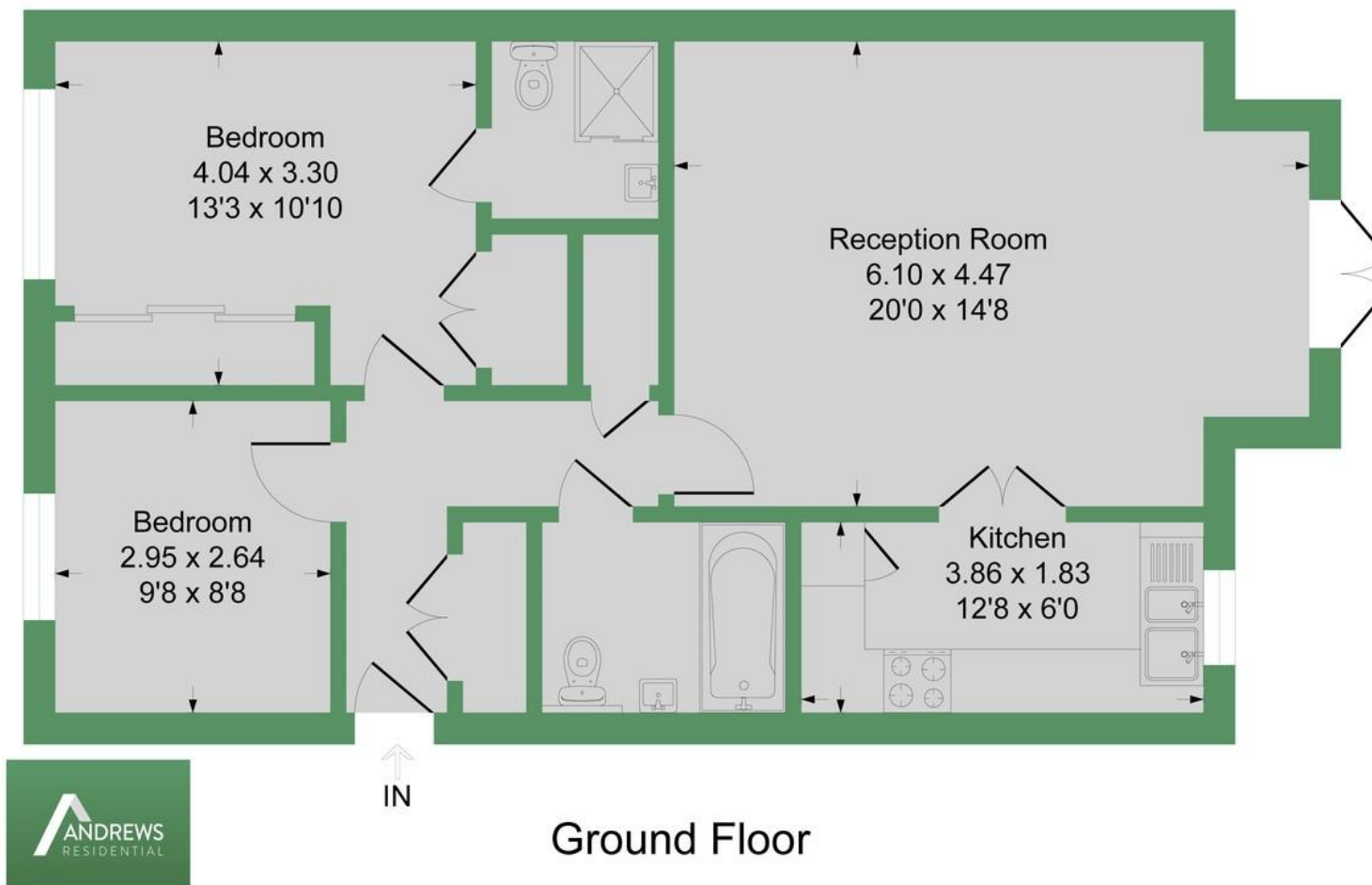

Illustration for identification purposes only, measurements are approximate, not to scale.

Hillingdon office
11 Crescent Parade
Hillingdon
UB10 0LG

Uxbridge office
41 Belmont Road
Uxbridge
UB8 1QT

Hillingdon office 01895 231311
Uxbridge office 01895 707777
info@andrewsresidential.co.uk
www.andrewsresidential.co.uk

Agents Note: Whilst every care has been taken to prepare these sales particulars, they are for guidance purposes only. All measurements are approximate and for general guidance purposes only and whilst every care has been taken to ensure their accuracy, they should not be relied upon and potential buyers are advised to recheck the measurements.