

Approx Gross Internal Area
45 sq m / 487 sq ft

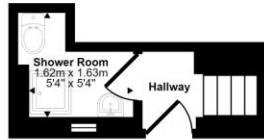

Ground Floor
Approx 5 sq m / 54 sq ft



First Floor
Approx 40 sq m / 433 sq ft

This floorplan is only for illustrative purposes and is not to scale. Measurements of rooms, doors, windows, and any items are approximate and no responsibility is taken for any error, omission or mis-statement. Icons of items such as bathroom suites are representations only and may not look like the real items. Made with Made Snappy 360.

OUTSIDE

The property is accessed via a gated and covered walkway between commercial properties leading to a communal patio area and the shared entrance.

DIRECTIONS

From the roundabout on St Crispins Road, turn onto Pitt Street and follow the road round before turning right onto Magpie Road. Turn right onto Edward Street continue on this road before turning left onto Magdalen Street, where the property can be found on the right-hand side.

LOCAL AUTHORITY

Norwich

COUNCIL TAX BAND

TBC

Energy Efficiency Rating Current D 55 Potential B 82



01603 760 770
hello@dragonflylettings.com
www.dragonflylettings.com
Unit 4 Dragonfly Lane, Cringleford, Norfolk, NR4 7FF

Whilst we have endeavoured to ensure these details are a fair and accurate representation of the property at the point of listing, please note that they are for guidance purposes only and we do not seek advice from or liaise with management companies, planning departments or building control in their preparation. We strongly advise that you inspect the property and surrounding area on Google maps and street view prior to viewing. Please also note the photographs do not infer that items shown are included, the measurements quoted are approximate and the fixtures, fittings and appliances have not been tested, therefore no guarantee can be given that they are in working order. If there is any point which is of particular importance to you then please obtain professional confirmation of it.



This apartment is conveniently located near amenities and the city centre. Whilst it shares the entrance and kitchen with another tenant, it provides its occupants with their own private bedroom, lounge, and shower room. Don't miss the opportunity to see it for yourself - call now to schedule a viewing!

Zipfels Court

Magdalen Street | Norwich | Norfolk | NR3 1LN

£550 pcm

Shared apartment in a convenient location

Shared entrance access and shared first floor kitchen with utility area

Private first floor 15'4 lounge, 11' bedroom and ground floor shower room

Gas central heating

Ideally located for amenities, situated close to Anglia Square and the city centre

Accessed via gated and covered walkway between commercial buildings

On-street permit parking nearby

Communal patio area

Council tax included

Available end of March 2024!

