



7 Damgate Lane, Martham

£270,000

Spacious 3-bed property with versatile living space including lounge/diner, kitchen/breakfast room, utility room. Bedrooms offer ample storage. Garage, driveway, and landscaped gardens with summer house.

Council Tax band: C

ENTRANCE HALL

Part glazed UPVC entrance door with glazed side panel, stairs to first floor, storage heater, power point, telephone point, electric meter cupboard, doors leading off.

GROUND FLOOR BEDROOM 3/STUDY

Window to front aspect, storage heater, power points.

BATHROOM

Opaque glazed window to side aspect, fully tiled walls, tiled shower cubicle, panelled bath, pedestal wash hand basin, W.C, wall mounted mirror, storage heater.

LOUNGE/DINER

Double aspect with windows to front and rear, storage heaters, wall lights, power points, brick built fireplace with brick hearth and tiled mantle, cupboard to side.

KITCHEN/BREAKFAST ROOM



ENTRANCE HALL

Part glazed UPVC entrance door with glazed side panel, stairs to first floor, storage heater, power point, telephone point, electric meter cupboard, doors leading off.

GROUND FLOOR BEDROOM 3/STUDY

Window to front aspect, storage heater, power points.

BATHROOM

Opaque glazed window to side aspect, fully tiled walls, tiled shower cubicle, panelled bath, pedestal wash hand



ENTRANCE HALL

Part glazed UPVC entrance door with glazed side panel, stairs to first floor, storage heater, power point, telephone point, electric meter cupboard, doors leading off.

GROUND FLOOR BEDROOM 3/STUDY

Window to front aspect, storage heater, power points.

BATHROOM

Opaque glazed window to side aspect, fully tiled walls, tiled shower cubicle, panelled bath, pedestal wash hand basin, W.C, wall mounted mirror, storage heater.

LOUNGE/DINER

Double aspect with windows to front and rear, storage heaters, wall lights, power points, brick built fireplace with brick hearth and tiled mantle, cupboard to side.

KITCHEN/BREAKFAST ROOM

Windows to side and rear aspect, range of base and wall mounted units with tiled splash backs, stainless steel drainer sink, power points, electric cooker point, storage heater, part glazed door to:

UTILITY ROOM

Windows to side and rear aspect, part glazed door to front, storage heater, fitted work surface, power points, plumbing for washing machine.

FIRST FLOOR LANDING

Loft access, doors leading off:

BEDROOM 1

Window to front aspect, airing cupboard housing immersion, built in wardrobe, power points, TV point, wall mounted electric



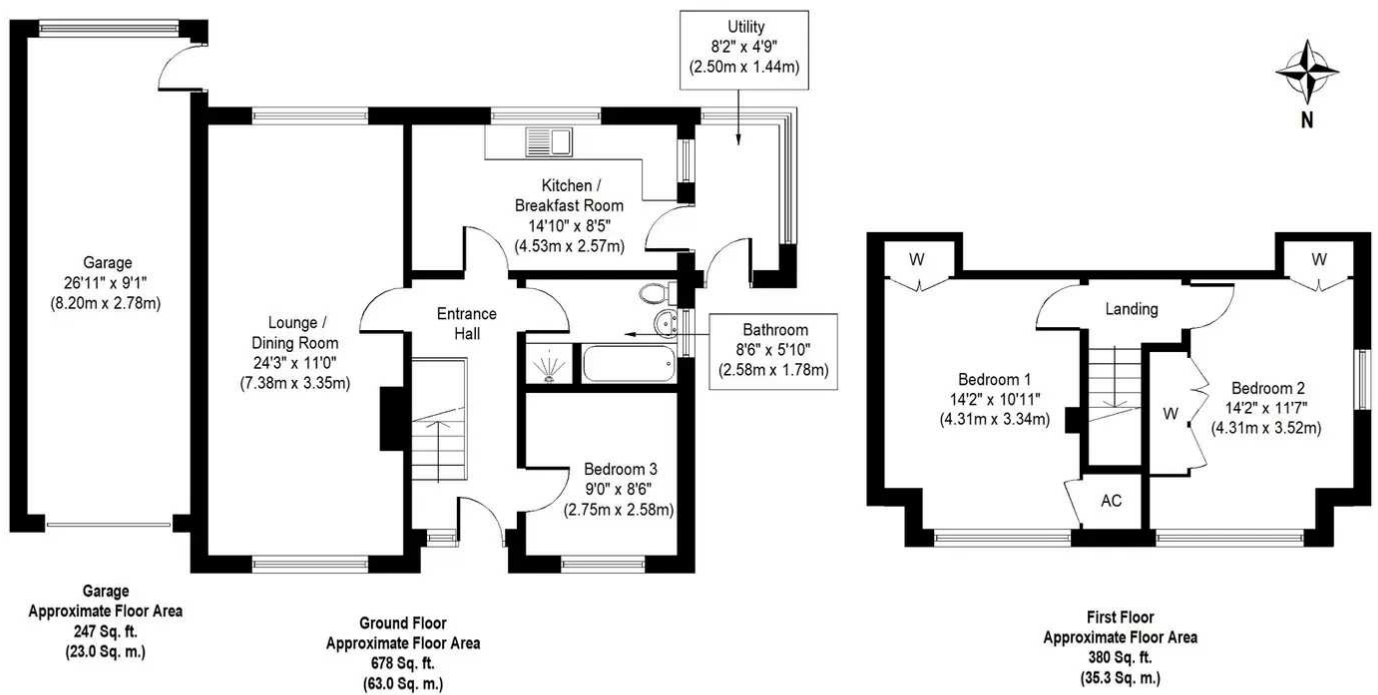

Whilst every attempt has been made to ensure the accuracy of the floor plan contained here, measurements of doors, windows, rooms and any other items are approximate and no responsibility is taken for any error, omission, or mis-statement. The measurements should not be relied upon for valuation, transaction and/or funding purposes. This plan is for illustrative purposes only and should be used as such by any prospective purchaser or tenant. The services, systems and appliances shown have not been tested and no guarantee as to their operability or efficiency can be given.

You can include any text here. The text can be modified upon generating your brochure.

You can include any text here. The text can be modified upon generating your brochure.

