



Seymours



Rosemary Gardens Camberley, GU17 0NJ £500,000

Arrange a viewing: 01276 534100

Property Details

- 3 bedrooms
- 1 baths
- EPC Rating TBC
- 1151 sqft (inc garage)
- Blackwater Station (0.7 miles)

- No onward chain
- Three bedrooms
- Bathroom
- Living room
- Dining room
- Mature rear garden
- Driveway and garage
- Near to local shops and amenities
- Countryside close by

NO ONWARD CHAIN A detached three-bedroom home which benefits from an attractive mature rear garden as well as a garage and driveway parking. The property is very conveniently located for Blackwater and the local shops and amenities as well railway station and good local schools. There is also attractive countryside close by at Hawley woods, Yateley common and The Meadows.

01276 534100 / james@seymours-blackwater.co.uk



Rosemary Gardens

Approximate Gross Internal Area = 94.2 sq m / 1014 sq ft
Garage = 12.7 sq m / 137 sq ft
Total = 106.9 sq m / 1151 sq ft

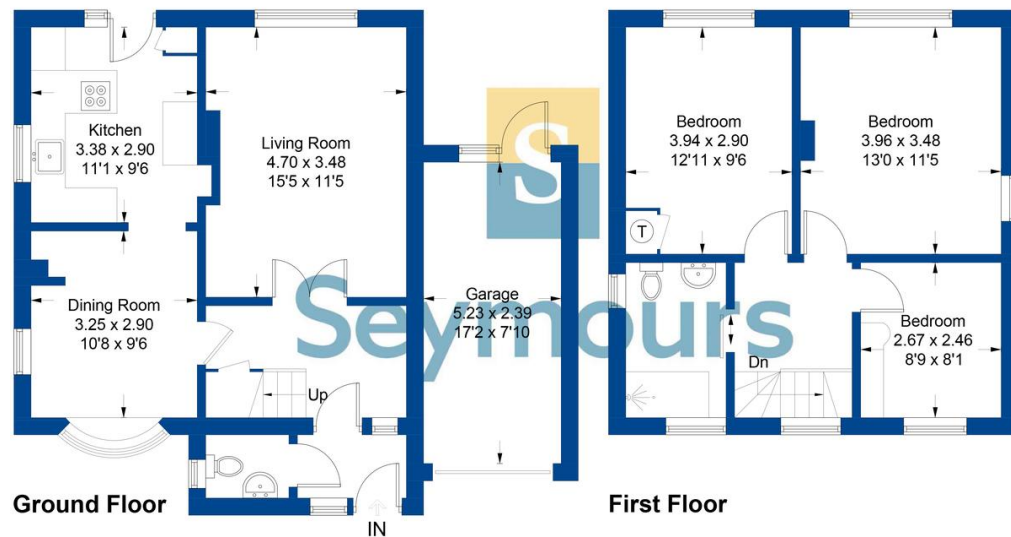

Illustration for identification purposes only, measurements are approximate, not to scale. FloorplansUsketch.com © 2024 (ID1054207)