



Seymours



# Lambert Crescent Camberley, GU17 0PW £380,000

Arrange a viewing: 01276 534100

## Property Details

- 2 bedrooms
- 0 baths
- EPC Rating TBC
- 1092 sqft (inc garage)
- Blackwater (1.1 miles)

- Semi-detached chalet
- Two double bedrooms
- Living room
- Conservatory
- Kitchen
- Mature rear garden
- Garage and driveway
- excellent location near end of close
- Convenient for Blackwater and the shops and amenities

This two bedroom chalet has a large Living room as well as a spacious conservatory and a kitchen. There is also a downstairs shower room. To the rear of property is a mature rear garden and the property does also benefit from driveway parking and a garage. It is well situated being towards the end of this popular close in Blackwater. There are decent local amenities too with a range of shops, amenities and a railway station at Blackwater as well as good local schools and attractive countryside close by.

[01276 534100](tel:01276534100) / [james@seymours-blackwater.co.uk](mailto:james@seymours-blackwater.co.uk)



## Lambert Gardens

Approximate Gross Internal Area = 78.6 sq m / 846 sq ft  
Workshop & Garage = 22.9 sq m / 246 sq ft  
Total = 101.5 sq m / 1092 sq ft (Excluding Eaves)

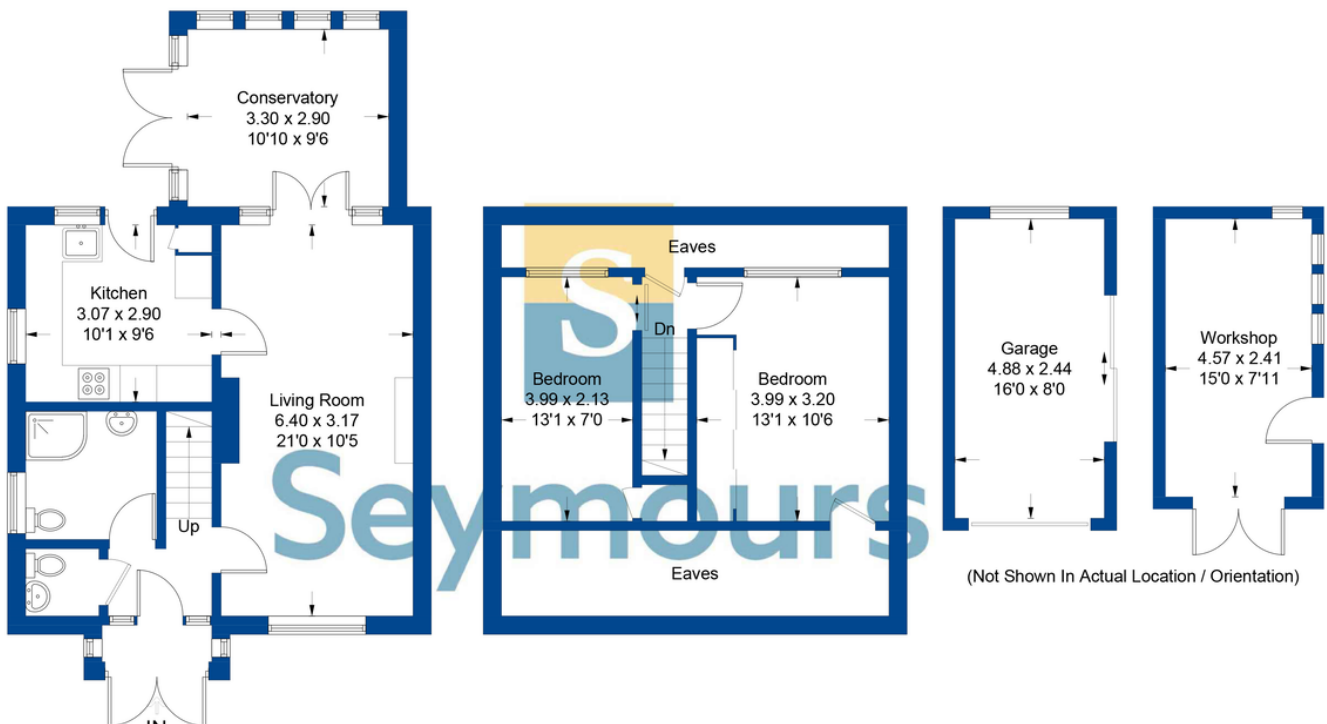

Illustration for identification purposes only, measurements are approximate, not to scale. FloorplansUsketch.com © 2024 (ID1054208)