



3 Bedroom Mid Terraced House £270,000

12 Austen Crescent, Swindon, SN3 6JE

mcfarlane
property.com

3 Bedroom Mid Terraced House Swindon, Swindon East

- BEAUTIFULLY PRESENTED
 - THOUGHTFULLY EXTENDED
 - KITCHEN/ DINING ROOM
 - THREE BEDROOMS
 - FULLY ENCLOSED REAR GARDEN
 - GAS CENTRAL HEATING
 - DOUBLE GLAZING
 - MODERN KITCHEN AND BATHROOM
-



An immaculately presented and thoughtfully extended family home with accommodation comprising sitting room, kitchen/ dining room, three bedrooms, family bathroom and fully enclosed rear garden.



A beautifully presented townhouse offering modernised and improved accommodation to include a single storey extension to the rear. The property offers generous accommodation throughout with the ground floor comprising a dual aspect sitting room, kitchen/ dining room with integrated appliances and useful breakfast island, a WC/ utility room and a welcoming entrance hall. To the first floor there are three bedrooms and the modern family bathroom with three piece suite.

To the rear of the property there is a fully enclosed, low maintenance garden and access to the parking.





Ground Floor

Approx. 52.7 sq. metres (567.3 sq. feet)

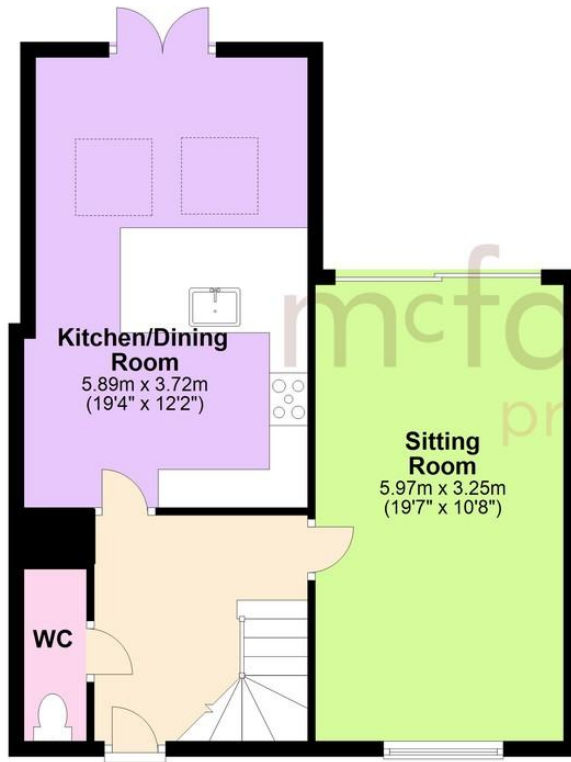

First Floor

Approx. 42.2 sq. metres (454.3 sq. feet)



Total area: approx. 94.9 sq. metres (1021.7 sq. feet)

We 
where you
LIVE

Our team are friendly, experienced and are all local. They know it better than they do their own living rooms and can help you find what you're looking for because **we love where we live.**

We would be delighted to show you around this property.

**Because every home
needs a personal touch.**

**If you would like to view this
property then please get in touch.**

📞 01793 296880

✉ oldtown@mcfarlaneproperty.com

mcfarlaneproperty.com

mcfarlane
property.com

Cricklade.

102 High Street
Cricklade SN6 6AA

📞 01793 751044

Marlborough.

106 High Street
Marlborough SN8 1LT

📞 01672 514380

Old Town.

28-30 Wood Street
Swindon SN1 4AB

📞 01793 296880

Swindon.

The Village Centre,
Redhouse SN25 2FW

📞 01793 296600

Agents Note: Whilst every care has been taken to prepare these sales particulars, they are for guidance purposes only. All measurements are approximate and are for general guidance purposes only and whilst every care has been taken to ensure their accuracy, they should not be relied upon and potential buyers are advised to recheck the measurements