



**Beverley Road, Ruislip**

**£575,000**

Ruislip

**Lr** LAWRENCE RAND

# Beverley Road

Ruislip, Ruislip

Council Tax band: D

Tenure: Freehold

EPC Energy Efficiency Rating: D

EPC Environmental Impact Rating: E

- Extended Terrace Home
- 3 Double Bedrooms
- Office/Bedroom 4
- Ground Floor Shower Room
- First Floor Bathroom
- Modern Fitted Kitchen
- Good Size Garden
- Outbuilding & Storage
- Driveway Parking
- Close to Shops, Schools & Station





Lr LAWRENCE RAND



Lr LAWRENCE RAND



Lr LAWRENCE RAND



Lr LAWRENCE RAND



**Ground Floor** Building 1

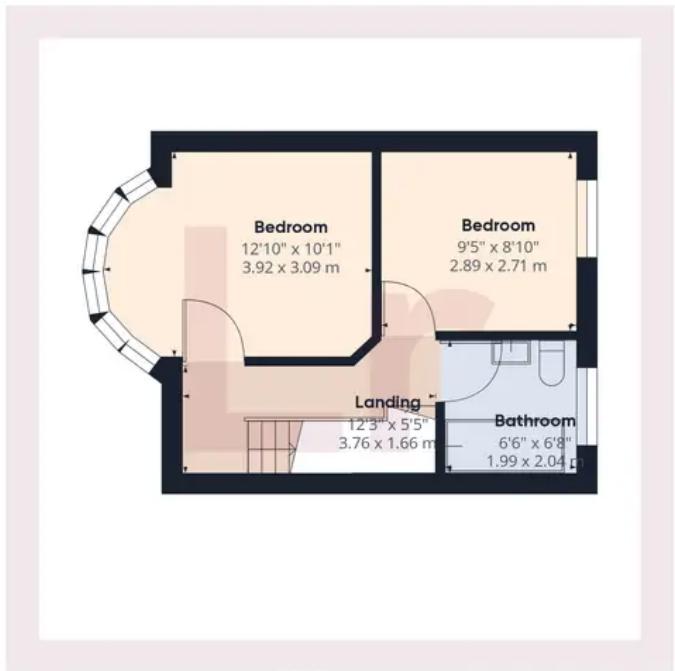

**Floor 1** Building 1

**Approximate total area<sup>(1)</sup>**

954.01 ft<sup>2</sup>

88.63 m<sup>2</sup>

**Reduced headroom**

7.59 ft<sup>2</sup>

0.71 m<sup>2</sup>

(1) Excluding balconies and terraces

Reduced headroom  
(below 1.5m/4.92ft)

While every attempt has been made to ensure accuracy, all measurements are approximate, not to scale. This floor plan is for illustrative purposes only.

**GIRAFFE360**



**Floor 2** Building 1



**Ground Floor** Building 2



## Lawrence Rand

Lawrence Rand, 106 Victoria Road - HA4 0AL

01895 632211

[Info@lawrence-rand.co.uk](mailto:Info@lawrence-rand.co.uk)

[www.lawrence-rand.co.uk/](http://www.lawrence-rand.co.uk/)



**LAWRENCE RAND**