

FINDING YOU A HOME
SINCE 1972
B



2 Le Jardin De La Rai, Springfield Road, St. Helier
£550,000

BROADLANDS
FINDING YOU A HOME SINCE 1972

2 Le Jardin De La Rai, Springfield Road

St. Helier, Jersey

- Two bedroom mews home
- Town outskirts
- Safe enclosed outside space at the rear
- Parking for 2 cars in tandem plus visitor spaces
- Immediate vacant possession, no onward chain
- Perfect starter home or downsize
- Sole agent
- Contact James on 07829835076 or james@broadlandsjersey.com
- Contact Harry on 07797751557 or harry@broadlandsjersey.com



2 Le Jardin De La Rai, Springfield Road

St. Helier, Jersey

A well presented and surprisingly spacious 2 bedroom mews house. Forming part of a small select development of just 7 similar properties this could be an ideal first home or downsize. Just moments from a convenience store and within walking distance of all major schools and colleges this really is a very convenient location. A good size living room / diner has double doors leading out to the private outside space. Both bedrooms upstairs are good sized doubles with plenty of storage space in each.

Parking is provided for 2 cars with ample further visitor parking.





Living

Large lounge and dining space that runs the whole depth of the property. Separate kitchen with fully integrated appliances. Double doors from the lounge open onto the private and fully enclosed outside space at the rear.

Sleeping

On the first floor are two good sized double bedrooms, each with plenty of wardrobe space. Both are serviced by the main bathroom.

Outside

Rear enclosed garden accessed off the lounge, would make for the ideal entertaining space with some astro or decking. Parking for 2 cars in tandem at the front of the property plus visitor spaces.

Services

All mains services. Gas boiler. Fully double glazed. Air conditioning.





GROUND FLOOR
351 sq.ft. (32.6 sq.m.) approx.

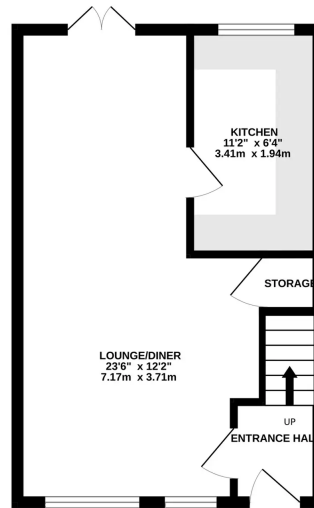

1ST FLOOR
351 sq.ft. (32.6 sq.m.) approx.

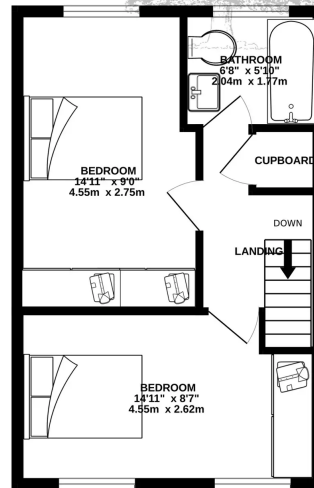

TOTAL FLOOR AREA : 702 sq.ft. (65.2 sq.m.) approx.

Whilst every attempt has been made to ensure the accuracy of the floorplan contained here, measurements of doors, windows, rooms and any other items are approximate and no responsibility is taken for any error, omission or mis-statement. This plan is for illustrative purposes only and should be used as such by any prospective purchaser. The services, systems and appliances shown have not been tested and no guarantee as to their operability or efficiency can be given.
Made with Metropix ©2024



Broadlands

Broadlands Estates, Library Place - JE2 3NL

01534 880770 • enquiries@broadlandsjersey.com • www.broadlandsjersey.com/

BROADLANDS

FINDING YOU A HOME SINCE 1972