

FINDING YOU A HOME
SINCE 1972
B



Unit 4, 10A Sligo Lane, Aquila Road, St Helier

Guide Price **£445,000**

BROADLANDS

FINDING YOU A HOME SINCE 1972

Unit 4,10A Sligo Lane, Aquila Road

St Helier, Jersey

Top floor apartment briefly comprising of an open plan kitchen/lounge diner with a bespoke fitted kitchen and integrated appliances, 2 double bedrooms and a house bathroom. The apartment benefits from vaulted ceilings providing natural light.

- 2nd floor 2 bedroom apartment
- Bespoke fitted kitchen and bathroom
- Superb courtyard setting on the outskirts of town
- Vacant and available immediately
- Contact Tony on 07797726677 or Tony@broadlandsjersey.com



**Living**

Open plan kitchen/lounge diner with vaulted ceiling. Bespoke fitted kitchen with integrated appliances.

Sleeping

2 double bedrooms with storage, main bedroom benefits from a sliding door with a juliet balcony. House bathroom with feature bath and overhead shower and vaulted ceiling.

Services

All mains. Electric heating. Bespoke floor coverings and carpets. Fibre broadband. Large external storeroom with security keypad. Separate communal bin store.



SECOND FLOOR
667 sq.ft. (62.0 sq.m.) approx.

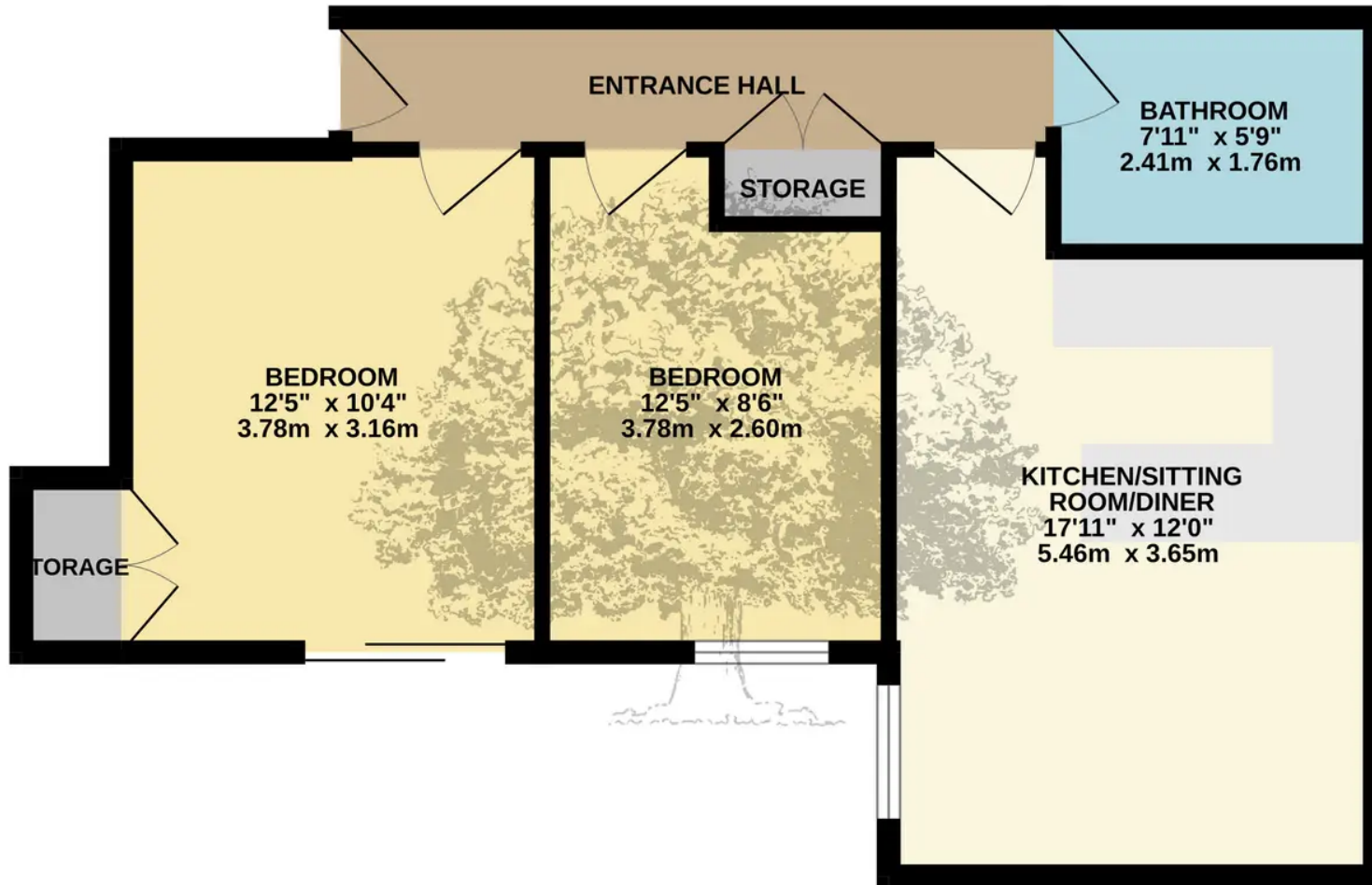

TOTAL FLOOR AREA : 667sq.ft. (62.0 sq.m.) approx.

Whilst every attempt has been made to ensure the accuracy of the floorplan contained here, measurements of doors, windows, rooms and any other items are approximate and no responsibility is taken for any error, omission or mis-statement. This plan is for illustrative purposes only and should be used as such by any prospective purchaser. The services, systems and appliances shown have not been tested and no guarantee as to their operability or efficiency can be given.
Made with Metropix ©2024



FINDING YOU A HOME
SINCE 1972
B

Broadlands

Broadlands Estates, Library Place - JE2 3NL

01534 880770 • enquiries@broadlandsjersey.com • www.broadlandsjersey.com/

BROADLANDS

FINDING YOU A HOME SINCE 1972