



2 Bedroom Apartment **£145,000**  
16 Kingshill Court, Kingshill Road, Swindon, SN1 4LD

**mcfarlane**  
property.com



## 2 Bedroom Apartment Swindon, Old Town

---

- No onward chain
  - Open plan living
  - First floor apartment
  - Two Double Bedrooms
  - Allocated Parking
  - Electric Heating
  - Fitted Wardrobe
- 



McFarlane Sales & Lettings are delighted to offer this spacious first floor apartment located in the sought after area of Old Town, just a short walk from local shops, restaurants, and other amenities. The property briefly comprises of entrance hall, open plan living room with modern fitted kitchen, master bedroom with fitted wardrobes, a second bedroom and a family bathroom with shower over the bath. Further benefits include one allocated parking space, secure phone entry system and electric heating. This property is a perfect opportunity for first time buyers looking to settle down in Old Town, additionally, investors will appreciate the fantastic rental potential that this property has to offer.



## Ground Floor

Approx. 58.2 sq. metres (626.3 sq. feet)

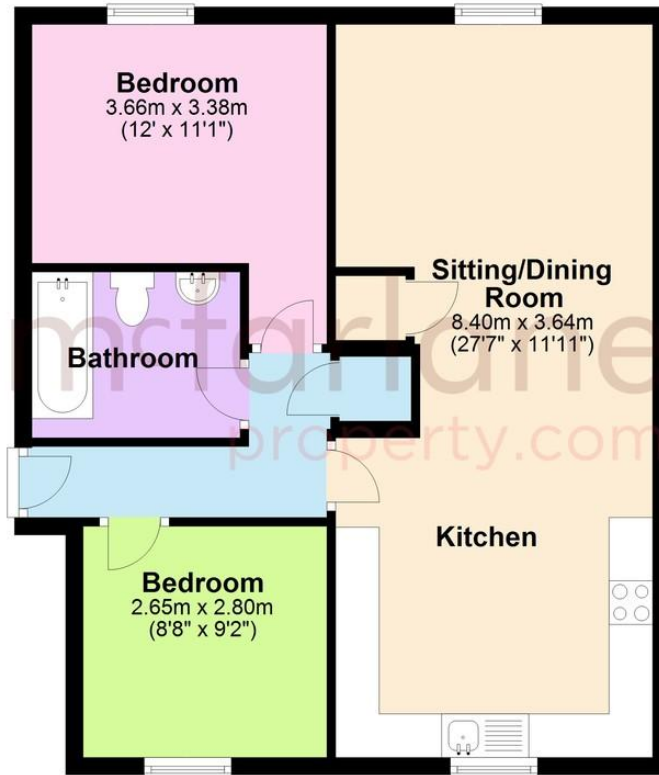

Total area: approx. 58.2 sq. metres (626.3 sq. feet)

We   
where you  
**LIVE**

Our team are friendly, experienced and are all local. They know it better than they do their own living rooms and can help you find what you're looking for because **we love where we live.**

We would be delighted to show you around this property.

**Because every home  
needs a personal touch.**

**If you would like to view this  
property then please get in touch.**

📞 01793 296880

✉️ [oldtown@mcfarlaneproperty.com](mailto:oldtown@mcfarlaneproperty.com)

[mcfarlaneproperty.com](http://mcfarlaneproperty.com)

**mcfarlane**  
property.com

### **Cricklade.**

102 High Street  
Cricklade SN6 6AA

📞 01793 751044

### **Marlborough.**

106 High Street  
Marlborough SN8 1LT

📞 01672 514380

### **Old Town.**

28-30 Wood Street  
Swindon SN1 4AB

📞 01793 296880

### **Swindon.**

The Village Centre,  
Redhouse SN25 2FW

📞 01793 296600

Agents Note: Whilst every care has been taken to prepare these sales particulars, they are for guidance purposes only. All measurements are approximate and are for general guidance purposes only and whilst every care has been taken to ensure their accuracy, they should not be relied upon and potential buyers are advised to recheck the measurements