



59 Netherwood Park

Livingston, West Lothian, EH54 8RW



Property Summary

This two-bedroom semi-detached house forms part of a popular development in Livingston. It offers well-proportioned rooms that are bright and airy, and it benefits from a southwest-facing aspect. Furthermore, the home provides private parking for two cars and it is flanked by landscaped gardens, which have manicured lawns. The rear garden also features a patio for summer dining and it is fully enclosed for the safety of pets and children. Whilst the property would benefit from cosmetic upgrades, it remains an excellent opportunity for buyers.

Extras: all fitted floor and window coverings, light fittings, and a gas cooker to be included in the sale.

Property Features

- A semi-detached house in popular Livingston
- Convenient setting close to Dechmont Law
- Near amenities, schools, and transport links
- Bright, dual-aspect entrance porch
- Southwest-facing living room with storage
- Fitted dining kitchen with garden access
- Naturally-lit landing
- Two double bedrooms with wardrobes
- Bright three-piece bathroom
- Well-maintained front and rear gardens
- Private driveway and attached garage
- Gas central heating and double glazing
- EPC Rating - C



Floorplan

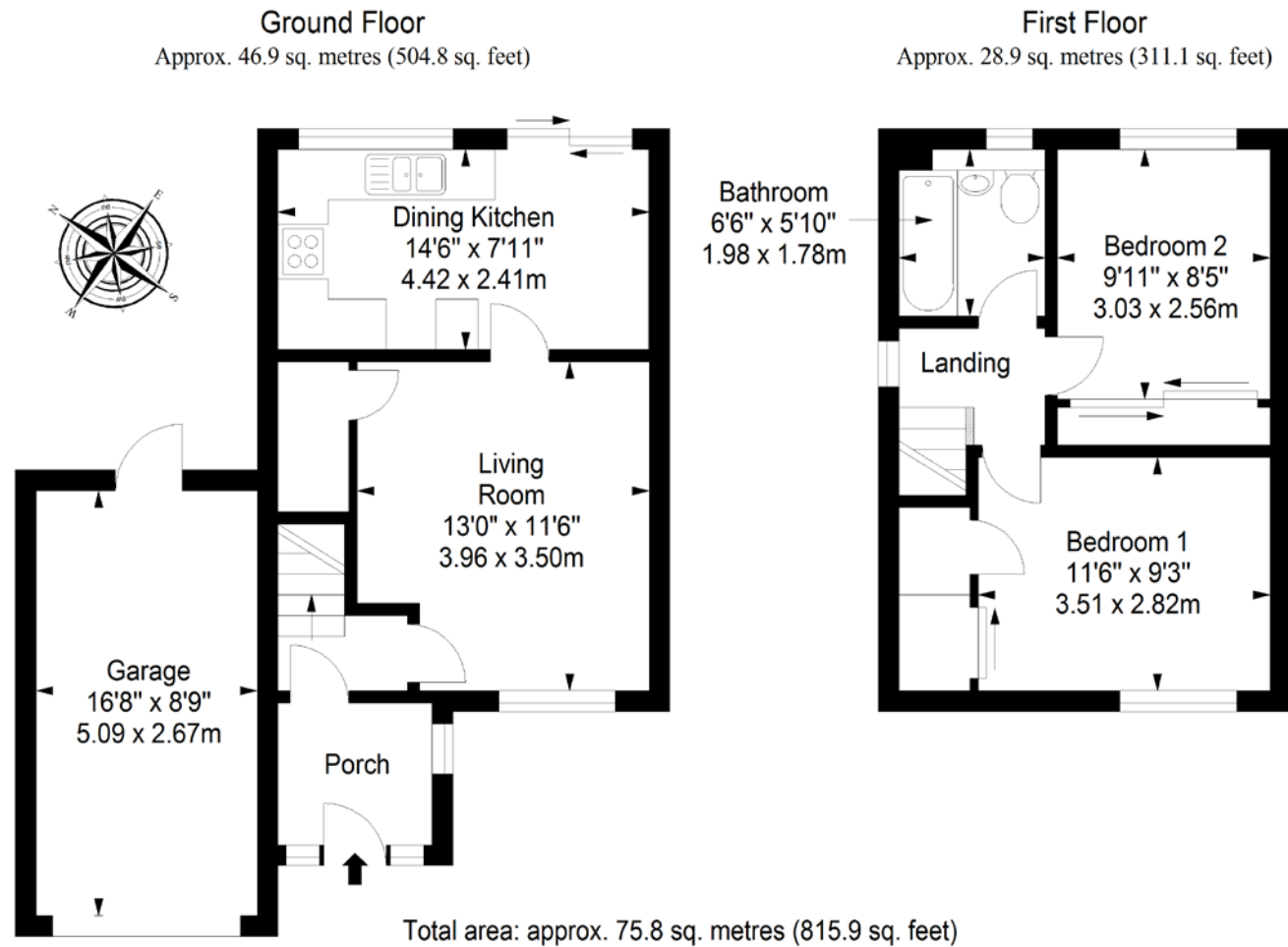

All Enquiries to our Property Department:

01501 740345 | ss@sneddons-ssc.co.uk | www.sneddonmorrison.co.uk
14 East Main Street, Whitburn, West Lothian EH47 0RB

IMPORTANT: The selling agents for themselves and for the sellers of the above property give notice that these particulars are for guidance only and their accuracy is not guaranteed. These particulars will not form part of any contract and interested parties should satisfy themselves in all aspects prior to submitting offers. The sellers do not bind themselves to accept the highest offer. S1106