

25
YEARS

SERVING
BEACONSFIELD
SINCE 1998



Plot 2, 2 Knottocks Drive, Beaconsfield

Guide Price £4,795,000

Ashington Page

Plot 2, 2 Knottocks Drive is an exceptional brand new home, of circa 8500 square feet including a detached double garage and is ready to move into now.

Built by Concierge (www.conciergegroup.uk) who are based in Beaconsfield and to a very high specification throughout. Built to enjoy the approximate 8,500 square feet over four floors, from the "WOW" basement right through to the top floor it has been designed to enjoy the outstanding space for the entire modern family.

Freehold

EPC TBA

HP9 2AH

These particulars are for guidance only. They are prepared and issued in good faith and are intended to give a fair summary of the property. Any description should not be relied on as a statement or representation of fact or that the property, or its services, are in good condition. The photographs show only certain parts of the property at the time they were taken. Any areas, measurements or distance given are approximate only. Any reference to alterations to, or use of, any part of the property is not a statement that any necessary planning, building regulations or other consent has been obtained. These matters must be verified by an intending purchaser. All statements contained in these particulars in relation to the property are made without responsibility of Ashington Page or its clients. Neither Ashington Page (nor any joint agents) nor any of their employees has any authority to make or give any representation or warranty whatsoever in relation to the property

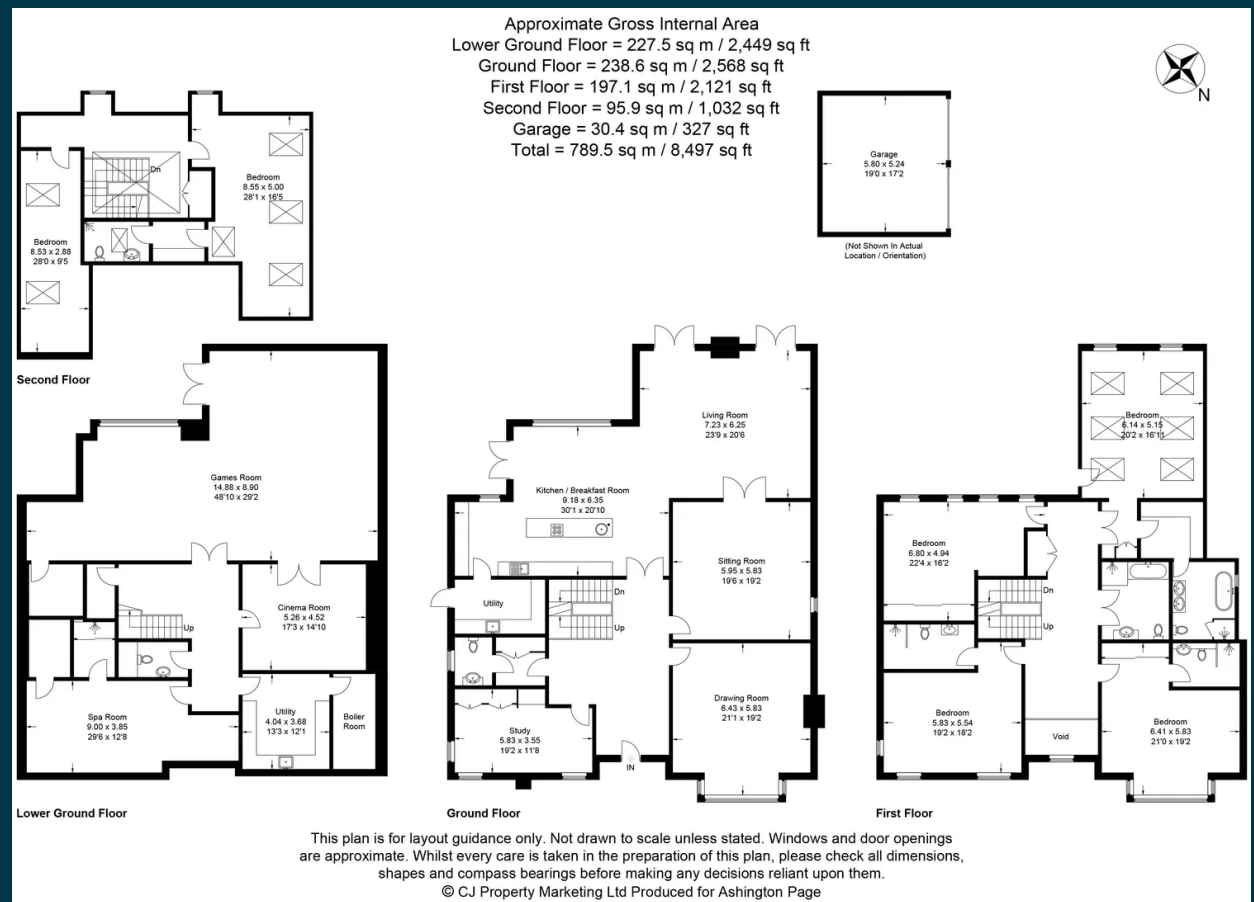

01494 680018
 info@ashingtonpage.co.uk
 www.AshingtonPage.co.uk

