



THE ASPEN VI

HOMES 144, 186, 200 & 201

Four bedroom home

The detached Aspen VI enjoys exceptionally well-designed living space including a separate lounge and kitchen / dining area opening on to the garden through French doors, plus a utility room, cloakroom and a large study. Upstairs are four bedrooms, three of which are double including bedroom 1 with en suite - plus a family bathroom.



Bedroom 1	3800mm x 3705mm	12'5" x 12'2"
En suite	1850mm x 2640mm	6'1" x 8'7"
Bedroom 2	3020mm x 3635mm	9'9" x 11'9"
Bedroom 3	2300mm x 3635mm	7'5" x 11'9"
Bedroom 4	2605mm x 3955mm	8'5" x 13'0"
Bathroom	2275mm x 2640mm	7'5" x 8'7"

FIRST FLOOR

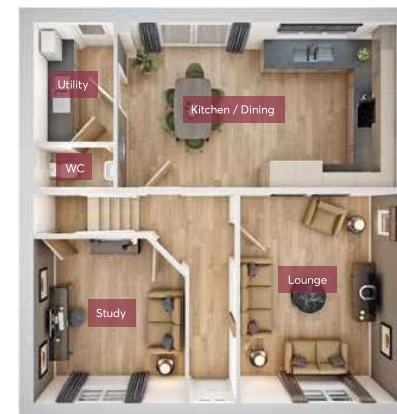

Lounge	3515mm x 4635mm	11'5" x 15'2"
Kitchen / Dining	6205mm x 3650mm	20'4" x 12'0"
Utility	1780mm x 2640mm	5'8" x 8'7"
Study	3350mm x 3635mm	11'0" x 11'2"
WC	1780mm x 945mm	5'8" x 3'1"

GROUND FLOOR

All images used are for illustrative purpose only. Dimensions given are illustrative for this house type and individual properties may differ. Please check with your Sales Executives in respect of individual properties. We give maximum dimensions within each room and these may include areas of fixtures and fittings including fitted furniture. These dimensions should not be used for carpet or flooring sizes, appliance spaces or items of furniture. All images, photographs and dimensions are not intended to be relied upon for, nor to form part of any contract unless specifically incorporated in writing into the contract.