



The Cottage, Christ Church Oval, Harrogate

Harrogate

Guide Price £895,000



MYRINGS



The Cottage, Christ Church Oval

Harrogate, Harrogate

The Cottage offers a rare and unique opportunity to acquire a period detached residence built circa 1890 standing in about 0.25 of an acre of wonderful secret mature walled gardens with a separate stone built sun room and detached garage situated on a quiet tree lined Oval just off the Park Parade stray parkland.

Council Tax band: G

Tenure: Freehold

- PERIOD FEATURES
- POTENTIAL TO EXTEND
- CLOSE TO PARK PARADE STRAY PARKLAND
- SITTING BEHIND ELECTRIC GATES
- LOVELY MATURE WALLED GARDENS OF ABOUT 0.25 ACRE



MYRINGS



Christ Church Oval, Harrogate, HG1

Approximate Area = 1730 sq ft / 160.7 sq m (excludes carport)

Garage = 300 sq ft / 27.8 sq m

Outbuildings = 367 sq ft / 34 sq m

Total = 2397 sq ft / 222.5 sq m

For identification only - Not to scale

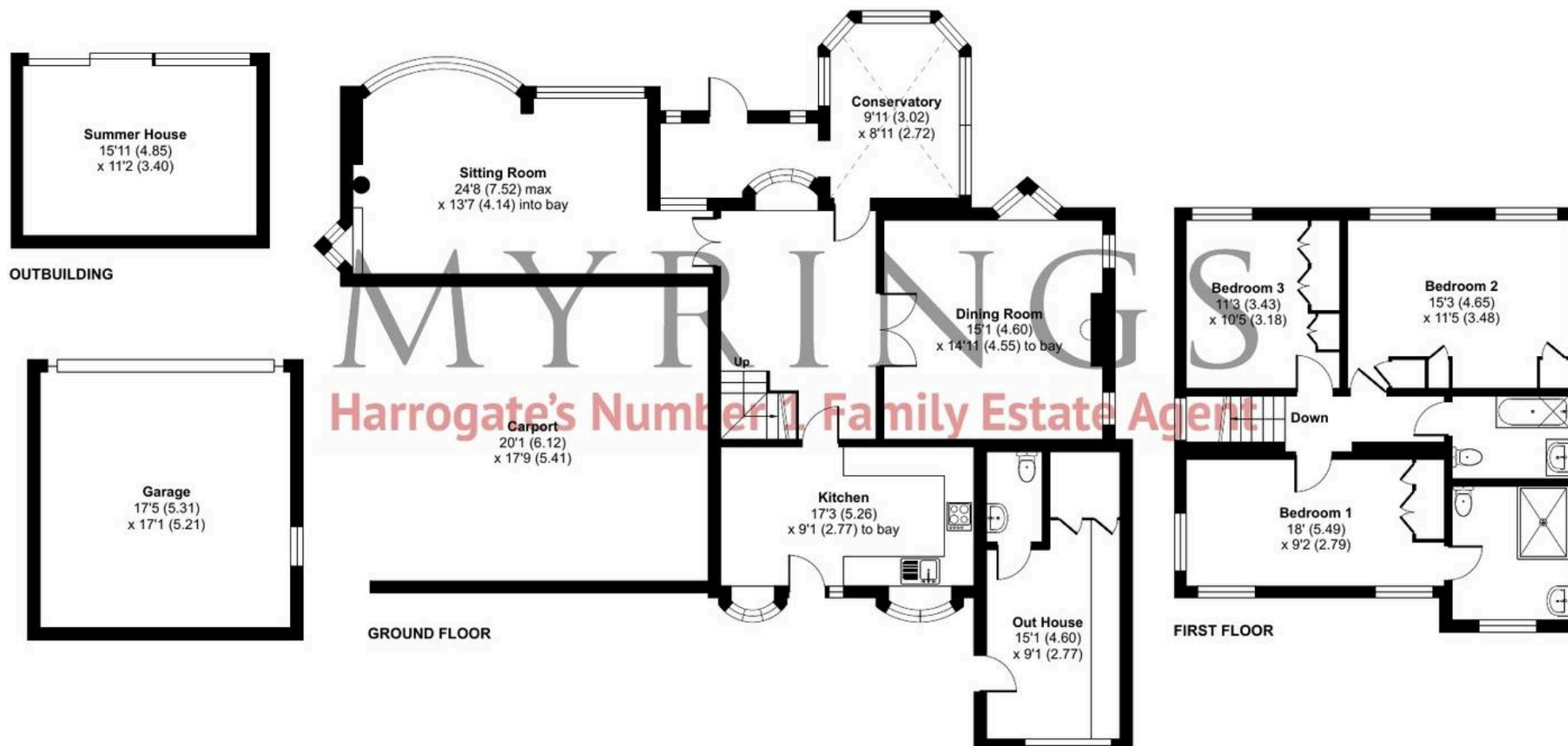
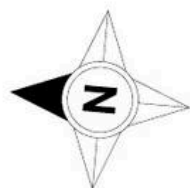





Myrings Estate Agents

Myrings Estate Agents Ltd, 10 Princes Square - HG1 1LX

01423

566400

▪ enquiries@myringsestateagents.com ▪ <http://myringsestateagents.com/>

