



3, Gatefield Cottages | Hayes Lane | Slinfold | RH13 0SS





## 3, Gatefield Cottages

Hayes lane | Slinfold | RH13 0SS

£335,000

A Slinfold village character cottage situated towards the village end of Hayes Lane which is very accessible to the centre with its local store and public house. The property has much charm with many period doors still in evidence and fireplaces plus having double glazed windows and gas fired heating to radiators. At the front of the cottage is a good sized area of garden with two allocated parking spaces. To the rear is a courtyard garden that is easy to maintain. As you enter the cottage a small entrance hall opens through to the sitting room that is currently used as a dining room and has a centrepiece fireplace. Towards the rear of the cottage is the real heart of the property with a well fitted kitchen opening to a family area that currently houses two sofas and this is an ideal place to relax and cook a meal. The ground floor also has a utility room and cloakroom. The first floor landing gives access to two good sized bedrooms and there is a very large bathroom with a full suite, including a shower cubicle.



### Entrance

Front door leading to:

### Entrance Hall

Double glazed window, wood laminate floor, open plan to:

### Sitting Room

Aspect to the front with double glazed window, radiator, centrepiece character fireplace with quarry tiled hearth, two storage cupboards to either side with display shelving over, wood laminate flooring, door to:

### Inner Hall

Wood laminate floor and staircase to first floor and door to:

### Kitchen/Family Room

This area of the cottage is of a good size and runs the full width of the property and in more detail comprises: a well fitted kitchen with worksurface having an inset sink unit with mixer tap having base cupboard under, space and plumbing for washing machine, further matching worksurfaces with base cupboards and drawers beneath and space for domestic appliances, extractor over cooker space, several eye-level cupboards, fitted shelving, cupboard concealing

gas fired boiler and there is a large opening through to:

### Family Area

This area of the cottage currently houses two sofas and is an ideal place to sit and relax and being connected directly to the kitchen is a real centre of the property. In this area there is wood laminate flooring, two radiators and a space for a fridge/freezer.

### Utility Room

Work top with base cupboards under, space for washing machine, shelving, double glazed windows, door to outside.

### Cloakroom

WC, corner wash hand basin with tiled splash back, radiator.

### Landing

Access to roof space, shelved cupboard.

### Bedroom One

Double glazed window, radiator.

### Bedroom Two

Double glazed window, radiator.

### Bathroom

This large room has a full suite and comprises: step-in tiled shower cubicle with mixer shower, panelled bath with twin

hand grips, mixer tap and hand held shower attachment, pedestal wash hand basin with tiled splash back, w.c., recess housing base unit with large shelf above and further base cupboard above, radiator, light provided by sun pipe.

### 2 Parking Spaces

The property is set back from Hayes Lane by a good area of front garden and towards the front boundary is a parking space to accommodate a good sized car. Additional Parking is very close-by and visible from the cottage.

### Front Garden

A good sized front garden almost entirely laid to lawn with a decked area adjacent the property.

### Rear Courtyard

Almost entirely paved and enclosed by a combination of brick garden walling and garden fencing.

**EPC RATING=C**  
**COUNCIL TAX= D**

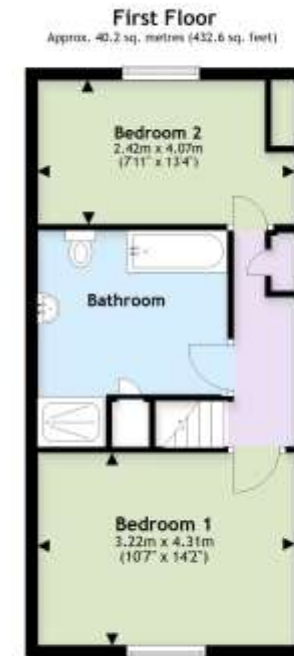

Total area: approx. 86.9 sq. metres (935.8 sq. feet)

Illustration for identification purposes only - Not to scale - Created for Fowlers Estate Agents  
Plan produced using PlanUp.



*"We'll make you feel at home..."*



Managing Director:  
Marcel Hoad

Fowlers 74 High Street, Billingshurst, West Sussex, RH14 9QS www.fowleronline.co.uk billingshurst@fowleronline.co.uk 01403 786787

**Important Notice**

1. Fowlers wish to inform all prospective purchasers that these sales particulars do not form part of any contract and have been prepared in good faith to give a fair overall viewing of the property.
2. We have not undertaken a structural survey, nor tested that the services, appliances, equipment or facilities are in good working order.
3. Fowlers cannot verify that any necessary consents have been obtained for conversions, extensions and other alterations such as underpinning, garaging and conservatories etc.

4. Any area, boundary, distances or measurements referred to are given as a guide only and should not be relied upon. If such details are fundamental to a purchase, please contact this office for further information.

5. The photographs shown in these details show only certain aspects of the property at the time they were taken. Certain aspects therefore may have changed and it should not be assumed that the property remains precisely as displayed in the photographs.
6. Fowlers cannot verify whether the property and its grounds are subject to any restrictive covenants, rights of way, easements etc., and purchasers are advised to make further enquiries to satisfy themselves on these points.