



3 Bedroom Top Floor Apartment £240,000

Marbeck Close, Redhouse, Swindon, Wiltshire, SN25 2LT

mcfarlane  
property.com

## 3 Bedroom Top Floor Apartment North Swindon

- 
- NO ONWARD CHAIN
  - Three bedroom apartment
  - Split over 2 floors
- 

Available with NO ONWARD CHAIN. A unique opportunity to buy a 3 BEDROOM APARTMENT with accommodation OVER TWO FLOORS and a private access from the communal stairs to the master suite. With TWO ENSUITES to the double bedrooms as well as a large living area with SOLID WOOD FLOORING open to the modern kitchen. In addition, this property has a single bedroom and family bathroom and an internal stairs leads you to the MASSIVE MASTER SUITE.

Council Tax Band D

Council Tax Estimate £2,198



## Property description

### BUILDING ENTRANCE

You enter the building either from the rear parking area on Marbeck close or the front entrance on Eastbury Way. The ground floor communal area has stairs to all floors and a lift to the 3rd floor.

### ENTRANCE HALL

A nice and spacious area providing access to bedrooms 2 & 3, the family bathroom and the living area as well as a handy storage cupboard. From here there are also stairs to the 4th floor.

### LIVING ROOM

An amazing spacious room with space for both living and dining furniture and views across North Swindon and out to the country. With two large windows this is a light and bright space and has stunning solid wood flooring. The living room leads to the kitchen area

### KITCHEN

With a modern fitted kitchen with a range of base and wall units as well as an eye level oven, electric hob with extractor and stainless-steel kitchen sink. The kitchen is currently laid out for disabled access and has space for an American style fridge freezer. With attractive grey floor tiles and cream metro style wall tiles to complement the cream units and wooden worktops.

### BEDROOM 2

A great sized double bedroom with tiled floor to the rear of the property.



#### BEDROOM 2 ENSUITE

With a double shower, wash hand basin and WC.

#### BEDROOM 3

A handy third bedroom or perhaps a perfect home office.

#### FAMILY BATHROOM

Situated to the rear of the property with a panel bath with mixer shower attachment, wash hand basin and WC

#### BEDROOM 1

An amazing space with so many options! You could simply use this as your master suite with dressing room to the side and ensuite. Perhaps a guest room, maybe you work from home, and you want a private space away from the home. Perhaps you have a teenager or adult child living at home that would enjoy their own living space the options are endless. With the large open space of the room, the walk-in wardrobe/store, the ensuite shower room and on top of this it has its own front door that takes you to the top floor landing with stairs to the floor below.

#### EXTERNALLY

There is a small communal front garden onto Eastbury Way. To the rear of the property there is the car park where the apartment has an allocated space as well as the bin stores and a bike shed.

#### LEASEHOLD

Lease remaining 81 years

Service charge £2100 p.a.

Ground Rent £175 p.a.





We   
where you  
**LIVE**

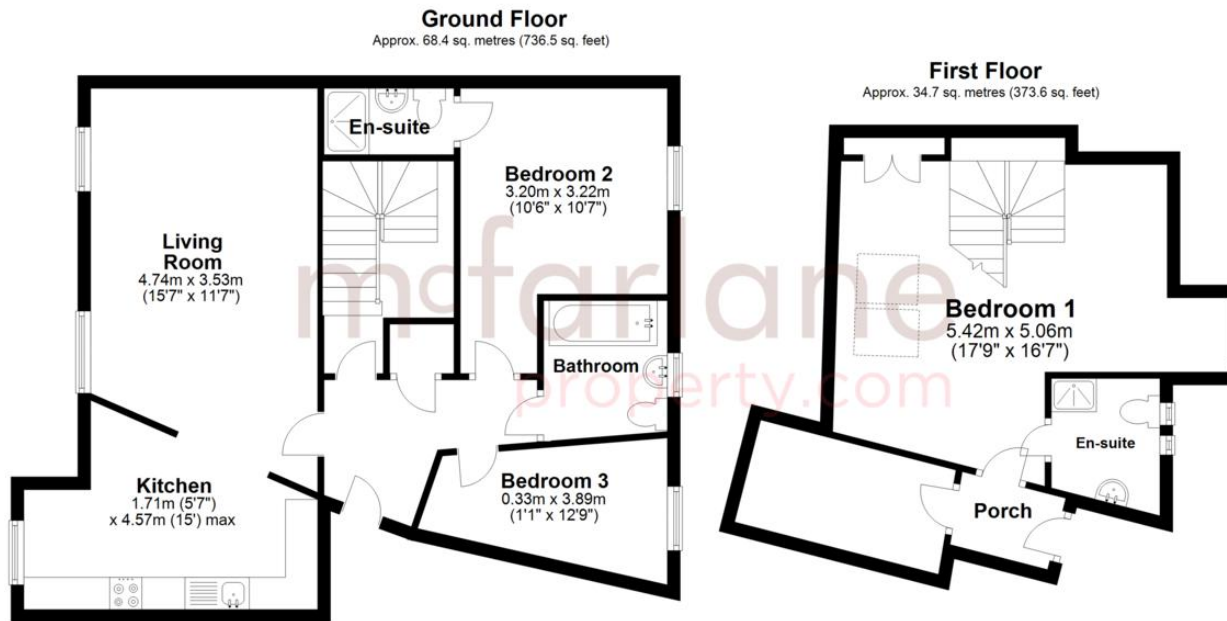

Total area: approx. 103.1 sq. metres (1110.2 sq. feet)

Our team are friendly, experienced and are all local. They know it better than they do their own living rooms and can help you find what you're looking for because **we love where we live.**

We would be delighted to show you around this property.

**Because every home  
needs a personal touch.**

**If you would like to view this  
property then please get in touch.**

 01793 296600

 [swindon@mcfarlaneproperty.com](mailto:swindon@mcfarlaneproperty.com)

[mcfarlaneproperty.com](http://mcfarlaneproperty.com)

**mcfarlane**  
property.com

**Cricklade.**  
102 High Street  
Cricklade SN6 6AA  
 01793 751044

**Marlborough.**  
106 High Street  
Marlborough SN8 1LT  
 01672 514380

**Old Town.**  
28-30 Wood Street  
Swindon SN1 4AB  
 01793 296880

**Swindon.**  
The Village Centre,  
Redhouse SN25 2FW  
 01793 296600

Agents Note: Whilst every care has been taken to prepare these sales particulars, they are for guidance purposes only. All measurements are approximate are for general guidance purposes only and whilst every care has been taken to ensure their accuracy, they should not be relied upon and potential buyers are advised to recheck the measurements