

H&G

Orbis
WHARF



Orbis WHARF

A stylish, well presented, two bedroom apartment with wraparound terrace in this award winning riverside development.

The well-presented, dual aspect apartment offers 920 sq ft of accommodation and benefits from a wonderful wraparound roof terrace, the perfect place to entertain and enjoy the views across the river and district.

Comprising a spacious open plan kitchen/reception room, master bedroom with en suite shower room, second double bedroom, bathroom and wrap around roof terrace.

The property benefits from secure underground allocated parking for one car.

For Sale

£795,000 (leasehold)









Bridges WHARF

The development offers a 24hr concierge service, 5-star hotel (with restaurants, bar and spa) and secure underground parking.

The property is within easy reach of a range of shops, cafes and restaurants off Battersea Square, Wandsworth Town, Clapham Junction and the open spaces of Battersea Park. The nearest transport is provided by Clapham Junction mainline station offering services into Victoria and Waterloo. There is also a good range of bus services providing easy access to Chelsea, Victoria and the southern suburbs.

A Thames Clipper river bus service is now in operation at Plantation Wharf pier located just a few hundred yards away. The service offers a weekday timetable into Blackfriars and Canary Wharf to the east and Putney to the west.

H&G

020 7352 2455

info@hgproperty.co.uk

www.hgproperty.co.uk

4 Vicentia Court, Bridges Wharf

ORBIS WHARF SW11

Approx. Gross Internal Floor Area
918 Sq. ft/85.26 Sq. m

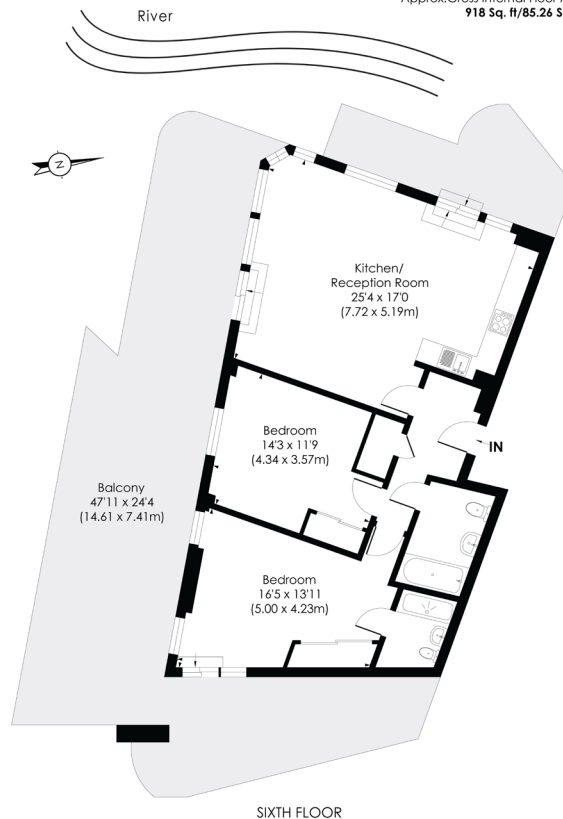

pixangle
PROPERTY MARKETING

© Pixangle Property Marketing Ltd, info@pixangle.com Tel: 0208 870 2118
This floor plan has been prepared for illustration purposes only. In accordance with the latest RICS code of measuring and is not to scale.
All measurements and areas are approximate and whilst every effort has been made to ensure the accuracy of the plan contained here, no responsibility is taken for any error, omission or misstatement.