



2 Bedroom Apartment **£135,000**

15 Torun Way, Haydon End, Swindon, SN25 1TA

mcfarlane
property.com

2 Bedroom Apartment Swindon, North Swindon

- NO ONWARD CHAIN
 - GROUND FLOOR APARTMENT
 - TWO BEDROOMS
 - SPACIOUS LIVING/ DINING ROOM
 - SEPARATE KITCHEN
 - ONE ALLOCATED PARKING SPACE
 - SECURE ENTRY PHONE SYSTEM
-



Offered to market with No Onward Chain McFarlane Sales & Lettings are delighted to offer this spacious ground floor apartment in Haydon End, North Swindon. The property is situated within walking distance of local amenities and comprises of entrance hall, spacious living/dining room, modern fitted kitchen, two good size bedrooms and a modern family bathroom. Further benefits include secure phone entry system, one allocated parking space and electric heating.

Lease: 135 years remaining.

Service Charge: £999 per annum.

Ground Rent: £165 per annum.



Ground Floor

Approx. 49.6 sq. metres (534.1 sq. feet)

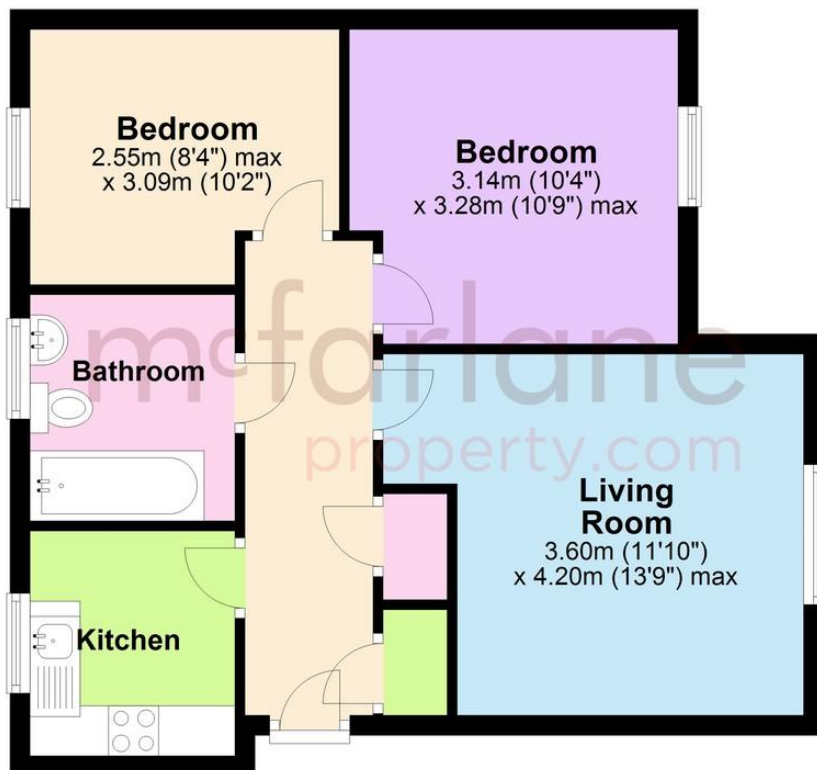

Total area: approx. 49.6 sq. metres (534.1 sq. feet)

We 
where you
LIVE

Our team are friendly, experienced and are all local. They know it better than they do their own living rooms and can help you find what you're looking for because **we love where we live.**

We would be delighted to show you around this property.

**Because every home
needs a personal touch.**

**If you would like to view this
property then please get in touch.**

📞 01793 296880

✉️ oldtown@mcfarlaneproperty.com

mcfarlaneproperty.com

mcfarlane
property.com

Cricklade.

102 High Street
Cricklade SN6 6AA

📞 01793 751044

Marlborough.

106 High Street
Marlborough SN8 1LT

📞 01672 514380

Old Town.

28-30 Wood Street
Swindon SN1 4AB

📞 01793 296880

Swindon.

The Village Centre,
Redhouse SN25 2FW

📞 01793 296600

Agents Note: Whilst every care has been taken to prepare these sales particulars, they are for guidance purposes only. All measurements are approximate are for general guidance purposes only and whilst every care has been taken to ensure their accuracy, they should not be relied upon and potential buyers are advised to recheck the measurements