

25
YEARS

SERVING
BEACONSFIELD
SINCE 1998



52 Baring Road, Beaconsfield

Guide Price £999,950

Ashington Page

A charming four-bedroom end of terrace property of great character situated about 250 metres from the centre of the new town and the nearby fast train service to London Marylebone. Waitrose is at the end of the road and there is a good selection of shops, restaurants, and bars in the local High Street. The property is in catchment for excellent local primary, secondary and grammar schools. The rear garden is approximately 100 feet in depth and there is off street parking and a garage.

Freehold

EPC D

Council Tax F

These particulars are for guidance only. They are prepared and issued in good faith and are intended to give a fair summary of the property. Any description should not be relied on as a statement or representation of fact or that the property, or its services, are in good condition. The photographs show only certain parts of the property at the time they were taken. Any areas, measurements or distance given are approximate only. Any reference to alterations to, or use of, any part of the property is not a statement that any necessary planning, building regulations or other consent has been obtained. These matters must be verified by an intending purchaser. All statements contained in these particulars in relation to the property are made without responsibility of Ashington Page or its clients. Neither Ashington Page (nor any joint agents) nor any of their employees has any authority to make or give any representation or warranty whatsoever in relation to the property

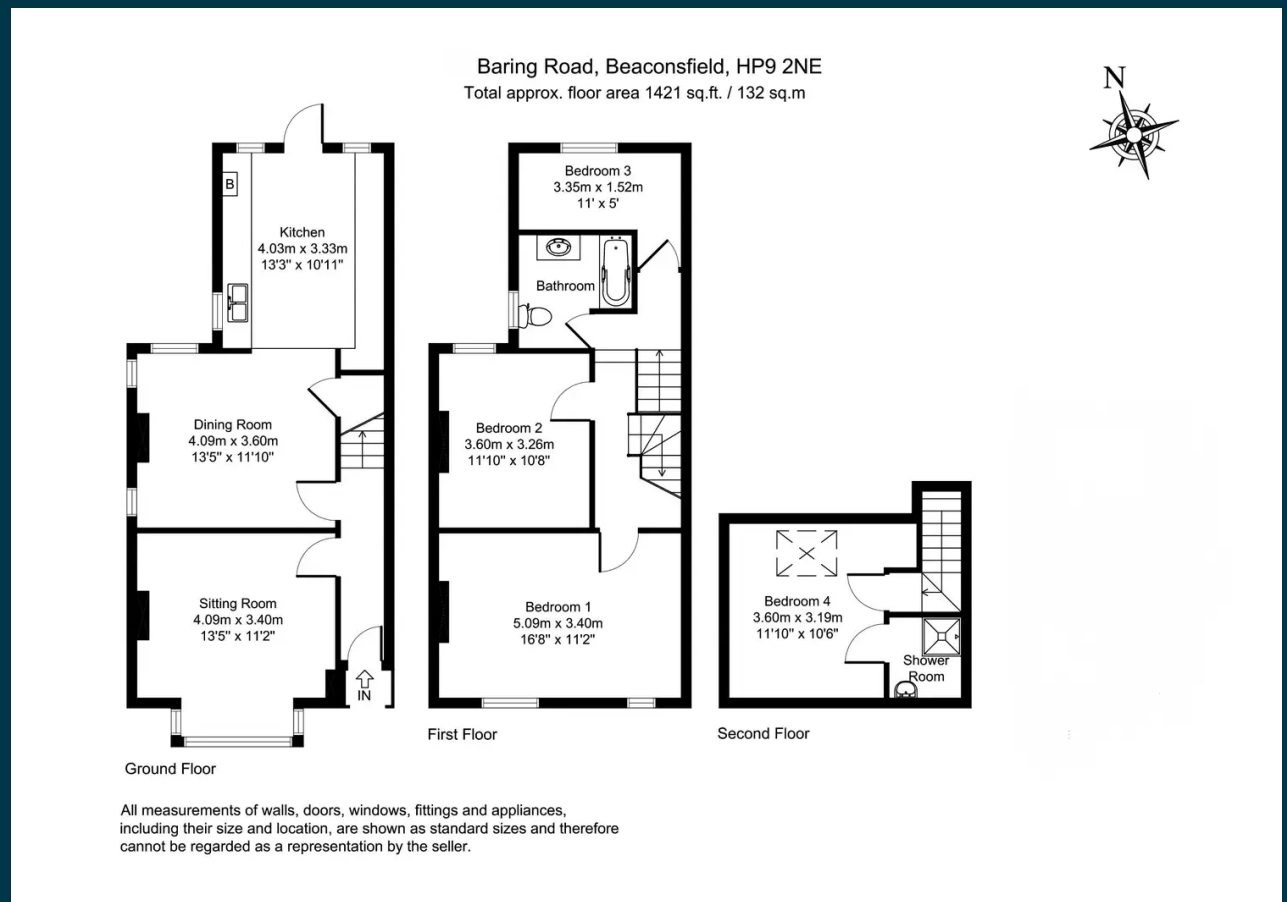

01494 680018
info@ashingtonpage.co.uk
www.AshingtonPage.co.uk

