

Frinton Office
 88 Connaught Avenue
 Frinton-on-Sea
 Essex CO13 9PT
 Tel: (01255) 677688

Harwich Office
 147 High Street
 Harwich
 Essex CO12 3AX
 Tel: (01255) 506655

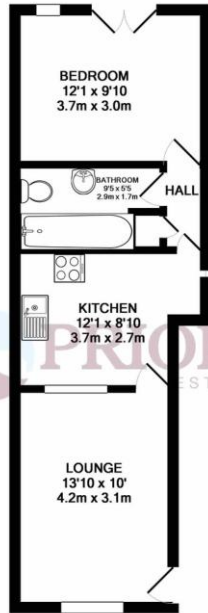

Energy Efficiency Rating		Current	Potential
<i>Very energy efficient - lower running costs</i>			
(92-100)	A		
(81-91)	B		
(69-80)	C		
(55-68)	D		
(39-54)	E		
(21-38)	F		
(1-20)	G		
<i>Not energy efficient - higher running costs</i>			
England, Scotland & Wales		71	74
EU Directive 2002/91/EC			

Council Tax Band
 Council Tax Band A

LOCAL AUTHORITY
 Tendring District Council

OFFICE
 147 High Street
 Harwich
 Essex
 CO12 3AX

T: 01255 506655
E: admin@prioryestates.co.uk
W: www.prioryestates.co.uk

Agents Note: Whilst every care has been taken to prepare these particulars, they are for guidance purposes only. All measurements are approximate, are for general guidance purposes only and whilst every care has been taken to ensure their accuracy they should not be relied upon and potential tenant: are advised to recheck the measurements.



Stour View Court
 Stour Road, Harwich

Rent: £600 pcm
 Energy Efficiency Rating C





Property Description

Priory Estates are delighted to offer this one bedroom ground floor flat, situated in Harwich. With just a short walk to Dovercourt Railway Station which provides links to Colchester and London Liverpool Street, this property also benefits from spacious accommodation, a balcony and off road parking. Available from the middle of April on an unfurnished basis. *Please note these photos are from a previous listing*



Accommodation

KITCHEN - 12'1" x 8' 10" (3.68m x 2.69m)

LIVING ROOM - 13' 10" x 10' 00" (4.22m x 3.05m)

BEDROOM - 12' 1" x 9' 10" (3.68m x 3m)

BATHROOM - 9' 5" x 5' 5" (2.87m x 1.65m)

Features

Spacious Accommodation
Double Glazed
Off Street Parking
Electric Heating
Short Walk to Local Amenities
Balcony



Financial Requirements

A minimum of one month's rent, plus a deposit of £690 is required in cleared funds prior to the commencement of the tenancy.

Term

A minimum of 6 months under an Assured Shorthold Tenancy Agreement, with an extension to the contract should both parties agree.

Restrictions

Certain Restrictions have been placed on this property, please ask for details.