



10 Birfield Road, Loudwater
£400,000



10 Birfield Road

Loudwater, High Wycombe

An end of terrace home in need of updating in this popular location close to Junction 3 of the M40. Entrance hall, Sitting room, Dining room, Kitchen, Three bedrooms, Bathroom, Gas central heating, Double glazing, Garden, Off road parking for two cars.

Council Tax band: D

Tenure: Freehold

Entrance hall

Stairs to first floor with under stairs storage cupboard, radiator

Sitting room

With feature fireplace, window to front, opening to Dining room

Dining room

With sliding patio doors to garden, radiator

Kitchen

Fitted with a range of eye and base level units incorporating stainless steel sink unit with mixer tap and drainer, space for oven with extractor over, built in fridge/freezer, built in dishwasher, space and plumbing for washing machine, part tiled walls, door to garden, window to rear





First floor

Landing

Airing cupboard housing Vaillant gas fired central heating boiler, built in storage cupboard

Bedroom 1

Radiator, built in double wardrobe, window to front

Bedroom 2

Radiator, recessed storage area, window to rear

Bedroom 3

Radiator, window to front

Bathroom

Suite comprising panelled bath with Triton shower over, low level W.C., wash hand basin, tiled walls, radiator, window to rear

Front garden/Parking

A driveway provides parking for two cars

Rear garden

The rear garden is enclosed by panelled fencing with rear gated access. The garden extends to 54' x 22'.



Approximate Gross Internal Area
 Ground Floor = 37.1 sq m / 399 sq ft
 First Floor = 36.7 sq m / 395 sq ft
 Total = 73.8 sq m / 794 sq ft

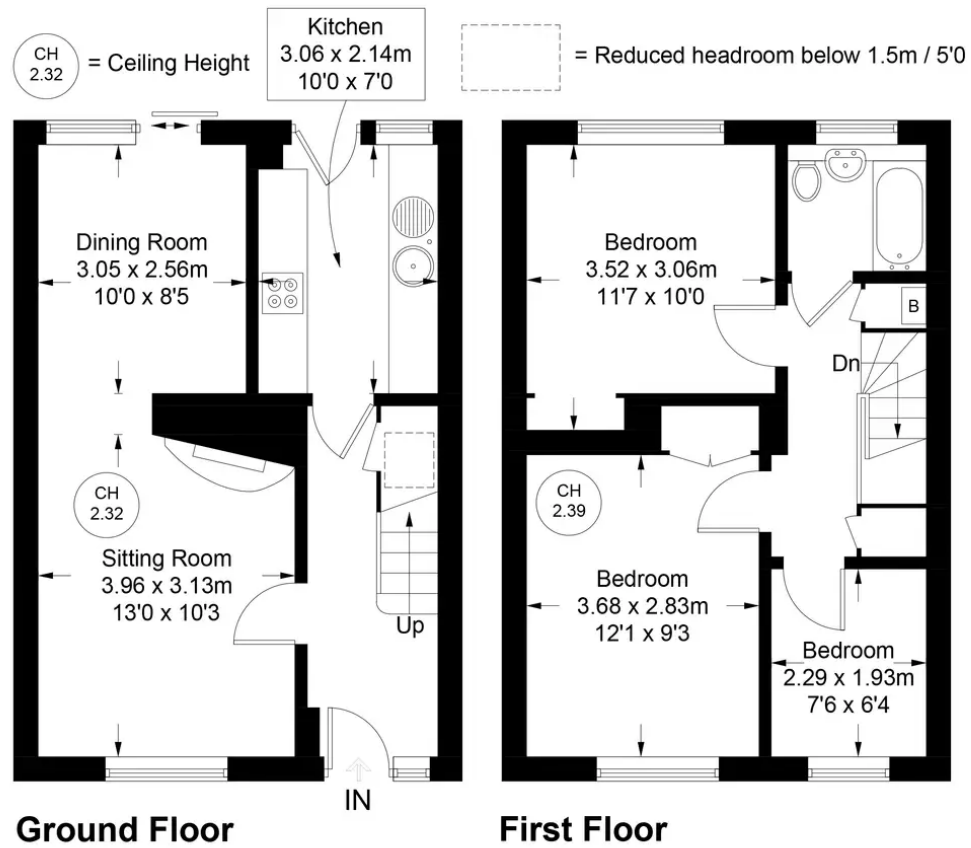

Floor Plan produced for Robertsons by Media Arcade ©.
 Illustration for identification purposes only. Window and door openings are approximate. Whilst every attempt is made to assure accuracy in the preparation of this plan, please check all dimensions, shapes and compass bearings before making any decisions reliant upon them.



Robertsons