



Flat, 22 East Main Street, Broxburn

Offers Over £67,000



Flat

22 East Main Street, Broxburn

Immaculate 1-bed flat in prime location with modern kitchen and main door entry. Perfect for investors or first-time buyers. Close to amenities and transport links. Stylish and well-maintained. Council tax banding A. Contact us today for a viewing!

Council Tax band: A

- One Bedroom
- First Floor Flat
- Modern Kitchen
- Walk In Condition
- Close To All Amenities
- Main Door Entry
- Fully Compliant With Renting Regulations
- Ideal for Investors
- Great For First Time Buyers
- Council Tax Banding A



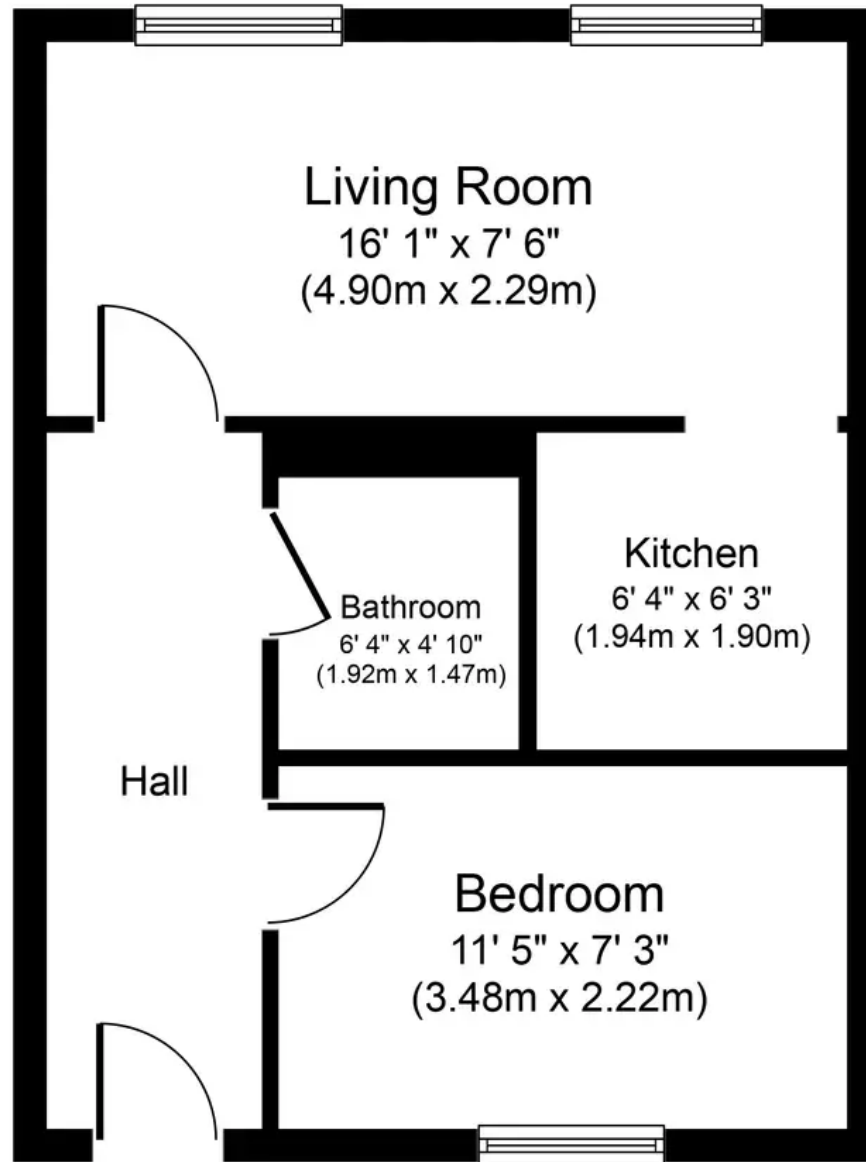

Approximate Floor Area
351 sq. ft.
(32.6 sq. m.)

Whilst every attempt has been made to ensure the accuracy of the floor plan contained here, measurements of doors, windows, rooms and any other items are approximate and no responsibility is taken for any error, omission, or mis-statement. The measurements should not be relied upon for valuation, transaction and/or funding purposes. This plan is for illustrative purposes only and should be used as such by any prospective purchaser or tenant. The services, systems and appliances shown have not been tested and no guarantee as to their operability or efficiency can be given.



KnightBain Estate Agents

Knightbain, 4 Greendykes Road, Broxburn - EH52 5AG

01506 852000

info@knightbain.co.uk

www.knightbain.co.uk/

