

Elms Road

Coton-in-the-Elms, Swadlincote, DE12 8HD



Could this be the perfect family home for you?
Situating in the ever popular pretty village of
Coton-in-the-Elms with countryside walks on
your doorstep together with a village primary
school and a popular pub.

£240,000

John German

Conveniently placed for the nearby centres of Burton-on-Trent, Lichfield, Tamworth and Ashby de la Zouch together with transport links via the A/M42 and A38.

The house stands on a lovely garden plot with gated access to a block paved driveway with adjacent lawned front garden. Side access leads to the large rear garden which comprises of extensive lawns with planted display borders, paved path, mature trees and shrubs. The garden backs onto fields enjoying a lovely rural backdrop. There is also a very useful wooden cabin (10 x 20ft) at the bottom of the garden which would make an ideal office space/workshop/summer house.

A front entrance door opens into the hallway with stairs to the first floor and a door into the good sized lounge with a focal point fire surround.

Next is the large dining kitchen enjoying a dual aspect offering space for appliances and room for a dining table. The property has the benefit of an Ideal Logic combi boiler that is energy efficient.

Off the kitchen is a useful guest's cloakroom/WC.

Completing the ground floor is a character sitting room with tiled fire surround with open fire and large doors out to the rear garden. This room could make an ideal home office if required or additional sitting room.

On the first floor are three truly good sized bedrooms served by a family bathroom featuring a bath with overhead shower, pedestal wash basin and WC.

Tenure: Freehold (purchasers are advised to satisfy themselves as to the tenure via their legal representative).

Property construction: Brick

Parking: Drive

Electricity supply: Mains

Water supply: Mains

Sewerage: Mains

Heating: Gas

(Purchasers are advised to satisfy themselves as to their suitability).

Broadband type: TBC

See Ofcom link for speed: <https://checker.ofcom.org.uk/>

Mobile signal/coverage: See Ofcom link <https://checker.ofcom.org.uk/>

Local Authority/Tax Band: South Derbyshire District Council / Tax Band B

Useful Websites: www.gov.uk/government/organisations/environment-agency
www.southderbyshire.gov.uk

Our Ref: JGA/14032024

The property information provided by John German Estate Agents Ltd is based on enquiries made of the vendor and from information available in the public domain. If there is any point on which you require further clarification, please contact the office and we will be pleased to check the information for you, particularly if contemplating travelling some distance to view the property. Please note if your enquiry is of a legal or structural nature, we advise you to seek advice from a qualified professional in their relevant field.



Ground Floor

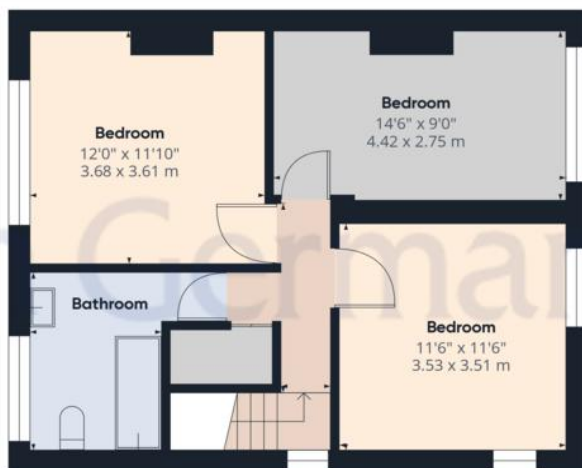

Floor 1

John German 

Approximate total area⁽¹⁾

1057.92 ft²
98.28 m²

Reduced headroom

1.27 ft²
0.12 m²

(1) Excluding balconies and terraces

 Reduced headroom (below 1.5m/4.92ft)

While every attempt has been made to ensure accuracy, all measurements are approximate, not to scale. This floor plan is for illustrative purposes only.

GIRAFFE 360





Score	Energy rating	Current	Potential
92+	A		
81-91	B		83 B
69-80	C	70 C	
55-68	D		
39-54	E		
21-38	F		
1-20	G		



John German
129 New Street, Burton-On-Trent, Staffordshire, DE14
3QW

01283 512244
burton@johngerman.co.uk

Agents' Notes

These particulars do not constitute an offer or a contract neither do they form part of an offer or contract. The vendor does not make or give and Messrs. John German nor any person employed has any authority to make or give any representation or warranty, written or oral, in relation to this property. Whilst we endeavour to make our sales details accurate and reliable, if there is any point which is of particular importance to you, please contact the office and we will be pleased to check the information for you, particularly if contemplating travelling some distance to view the property. None of the services or appliances to the property have been tested and any prospective purchasers should satisfy themselves as to their adequacy prior to committing themselves to purchase.

Referral Fees

Mortgage Services - We routinely refer all clients to APR Money Limited. It is your decision whether you choose to deal with APR Money Limited. In making that decision, you should know that we receive on average £60 per referral from APR Money Limited.

Conveyancing Services - If we refer clients to recommended conveyancers, it is your decision whether you choose to deal with this conveyancer. In making that decision, you should know that we receive on average £150 per referral.

Survey Services - If we refer clients to recommended surveyors, it is your decision whether you choose to deal with this surveyor. In making that decision, you should know that we receive up to £90 per referral.

Ashbourne | Ashby de la Zouch | Barton under Needwood
Burton upon Trent | Derby | East Leake | Lichfield
Loughborough | Stafford | Uttoxeter

JohnGerman.co.uk Sales and Lettings Agent