





This two bedroom split level flat offers spacious living areas, presenting a promising renovation opportunity and producing abundant natural light throughout. In need of modernising the property features a well proportioned layout, potential for contemporary upgrades and convenient access to Heathrow Airport. To the ground floor there is a kitchen, lounge and access to a garden. Upstairs there is two good sized bedrooms, a separate wc and bathroom.

The property also offers a garage located in a block, perfect for buyers looking to add their personal touch and create a stylish updated living space.

Lease: 64 years remaining

Ground Rent: £10.00 p.a.

Service Charge: £1,650 p.a.



# Cranelodge Road, Hounslow

Approximate Gross Internal Area  
904 sq ft - 84 sq m

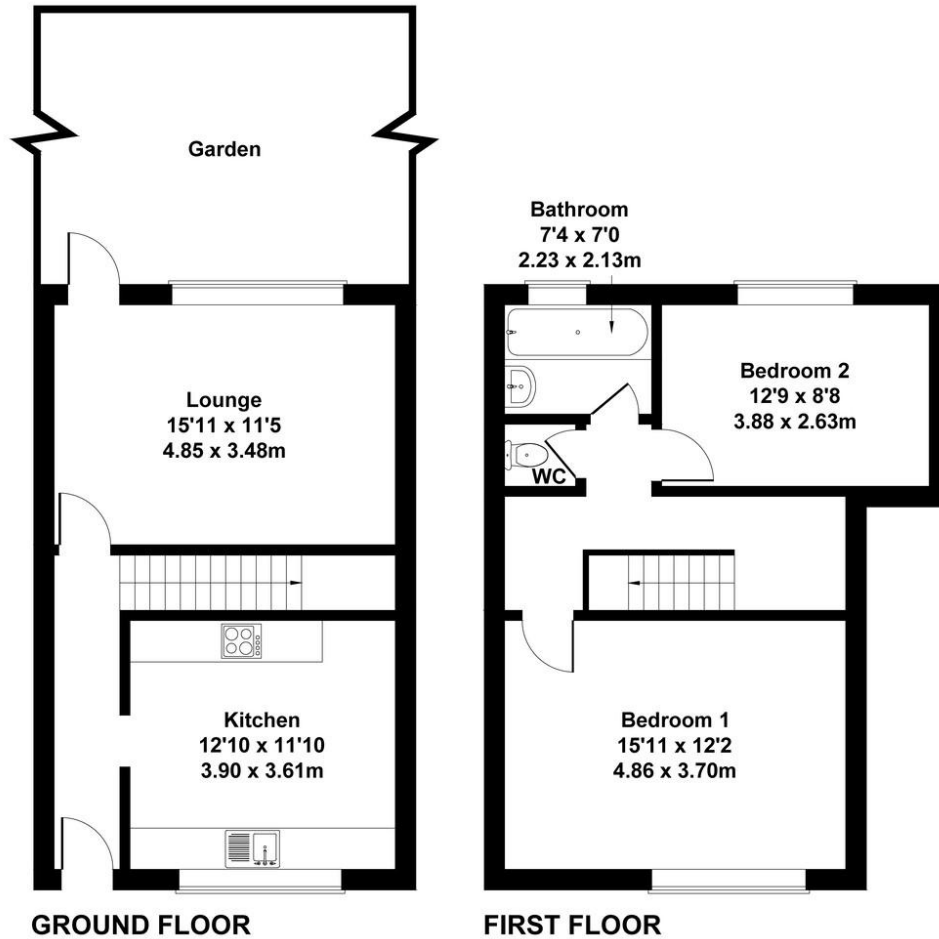

%epcGraph\_c\_1\_381%

Not to Scale. Produced by The Plan Portal 2024  
For Illustrative Purposes Only.

