



Vickers Way | Hounslow | TW4 5EE

£240,000

A well-presented and spacious one-bedroom purpose-built ground floor flat, situated a short walk from Staines Road, providing good access to shops and various transport links/routes. The accommodation comprises of large double bedroom, recently refurbished bathroom suite, great-size reception room leading through to a fitted kitchen. Other benefits include, private parking, communal gardens and security phone entry system.

## Tenure

Leasehold (155 years)

Service Charge £1,400 (inc. ground rent)

Estimated Rental Income £1,300 pcm (6.37% yield)

## Council Tax Band

C

## Viewing Arrangements

Strictly by appointment

## Contact Details

20 High Street

Whitton

Twickenham

TW2 7LT

0208 894 3646

whitton@shawandcoestates.com

www.shawandcoestates.com



# Sheridan Court, Vickers Way, Hounslow

Approximate Gross Internal Area

474 sq ft - 44 sq m

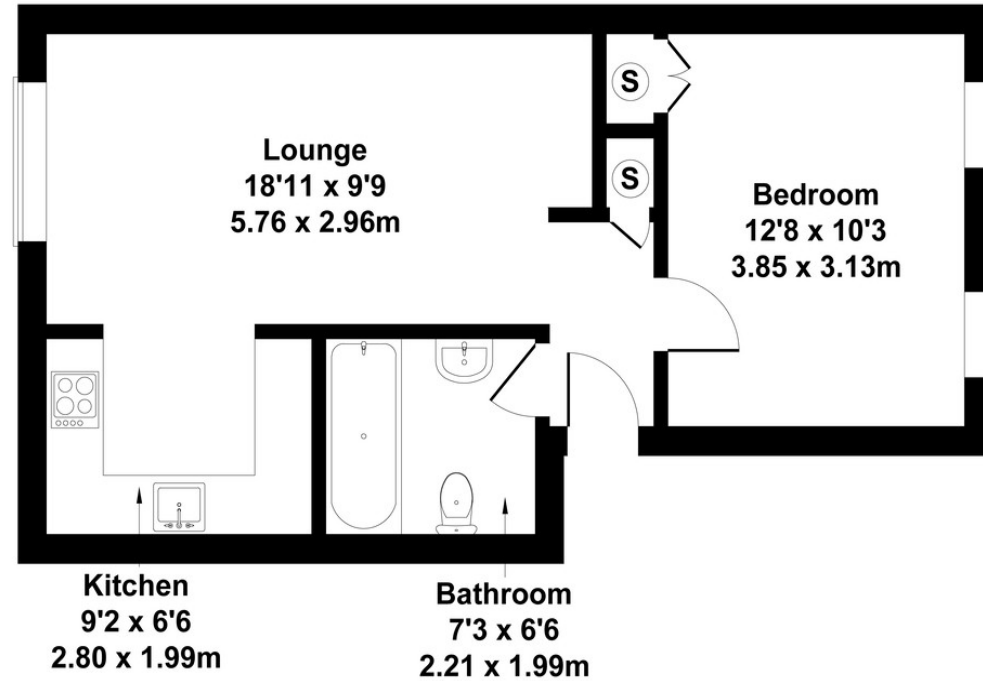

Not to Scale. Produced by The Plan Portal 2023  
For Illustrative Purposes Only.



Score	Energy rating	Current	Potential
92+	A		
81-91	B		
69-80	C	70 C	77 C
55-68	D		
39-54	E		
21-38	F		
1-20	G		

Agents Note: Whilst every care has been taken to prepare these particulars, they are for guidance purposes only. All measurements are approximate are for general guidance purposes only and whilst every care has been taken to ensure their accuracy, they should not be relied upon and potential buyers/tenants are advised to recheck the measurements