

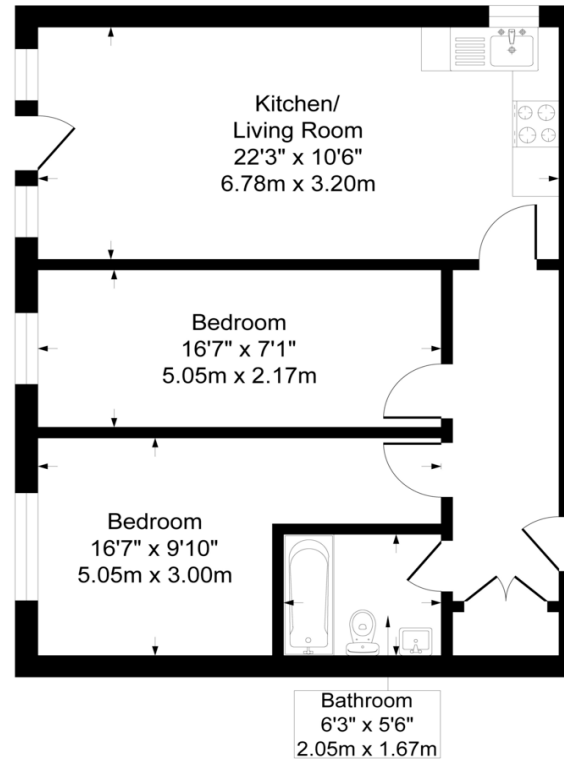



Score	Energy rating	Current	Potential
92+	A		
81-91	B		
69-80	C	80 c	80 c
55-68	D		
39-54	E		
21-38	F		
1-20	G		

**Approximate Gross Internal Area  
633 sq ft - 59 sq m**



Although every attempt has been made to ensure accuracy, all measurements are approximate.  
This floorplan is for illustrative purposes only and not to scale.  
Measured in accordance with RICS Standards.



With no onward chain comes this well kept two-bedroom ground floor flat with private allocated parking. Spacious throughout there is an open plan kitchen/lounge, two double bedrooms, storage space and a three-piece bathroom. Centrally located the flat is within easy reach of all amenities and also a short distance to Hounslow Overground station.

Ideal for first time buyers, viewings are highly recommended.