

For Sale 3 bed house



- › 3 BEDROOM LINKED DETACHED HOUSE
- › 1442 SQ FT/ 134 SQ MT
- › THROUGH RECEPTION
- › STUDY
- › FITTED KITCHEN

DREAMVIEW ESTATES HAVE BEEN INSTRUCTED TO LIST THIS DETACHED HOUSE OF SOME 1442 SQ FT/134 SQ MT SITUATED IN A VERY POPULAR RESIDENTIAL LOCATION IN HENDON AND CLOSE TO BRENT CROSS AND HENDON CENTRAL STATIONS THE HOUSE OFFERS POTENTIAL TO EXTEND INTO THE LOFT AS OTHER NEARBY





Photo 1 of 1

Denehurst Gardens, NW4 3QS

Approx Gross Internal Area = 134 sq m / 1442 sq ft

Garden = 89 sq m / 958 sq ft

Total = 223 sq m / 2400 sq ft



First Floor

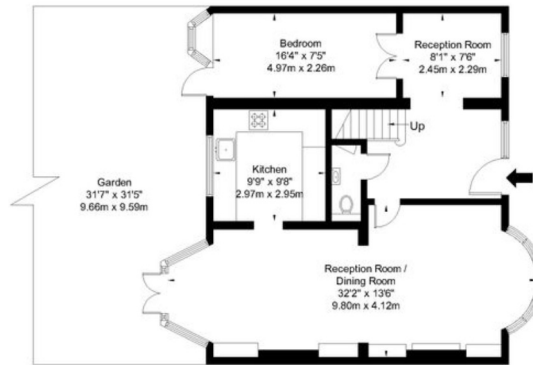

Ground Floor

Ref:

Copyright **BLEU
PLAN**

The Floor plan is not to scale and measurements and areas shown are approximate and therefore should be used for illustrative purposes only. The plan has been prepared in accordance with the RICS code of Measuring Practice and whilst we have confidence in the information produced it must not be relied on. If there is any aspect of particular importance, you should carry out or commission your own inspection of the property.

Copyright @ BLEUPLAN

DENEHURST GARDENS, HENDON, NW4 3QS

*DREAMVIEW ESTATES HAVE BEEN INSTRUCTED TO LIST THIS DETACHED HOUSE OF SOME 1442 SQ FT/134 SQ MT SITUATED IN A VERY POPULAR RESIDENTIAL LOCATION IN HENDON AND CLOSE TO BRENT CROSS AND HENDON CENTRAL STATIONS

*THIS FAMILY HOME IS SET OUT OVER 2 FLOORS WITH 3 BEDROOMS AND 2 BATHROOMS (1 EN SUITE) ON THE FIRST FLOOR

*THE GROUND FLOOR PROVIDES 2 MAIN INTERCOMMUNICATING RECEPTION ROOMS, A STUDY, ROOM, KITCHEN ALONG WITH A CLOAKROOM

*OUTSIDE THERE IS A LARGE REAR GARDEN

*THE HOUSE OFFERS POTENTIAL TO EXTEND INTO THE LOFT AS OTHER NEARBY HOUSE HAVE DONE AND THE GROUND FLOOR ALL UNDER PERMITTED DEVELOPMENT

*ASKING PRICE £950,000 FREEHOLD

*COUNCIL TAX BAND F

*EPC BAND E

*VIEWING IS VERY STRICTLY BY APPOINTMENT ONLY

*PLEASE CALL DREAMVIEW ESTATES ON 020 8455 0055



34 Golders Green Road, London NW11 8LL

murray@dreamviewestates.co.uk

020 8455 0055

