



34 Oakmead Green, Epsom
Epsom

Guide Price **£370,000**



34 Oakmead Green

Epsom, Epsom

Lovely 2-bed bungalow ideal for over 60s in a peaceful cul-de-sac. Spacious lounge-dining room, fitted kitchen, two bedrooms & renovated shower room. Double glazing, parking, patios & summerhouse. Convenient location with nearby amenities & transport links. A comfortable retirement home.

Council Tax band: D

Tenure: Leasehold

EPC Energy Efficiency Rating: E

EPC Environmental Impact Rating:

- Two Bedrooms Bungalow
- Over 60's Retirement Home
- Secluded Cul-de-sac With Communal Gardens
- L Shaped Lounge-Dining Room
- Full Double Glazing
- Fitted Kitchen
- Own Patios and Summerhouse
- Residents & Visitors Parking
- Periphery of Epsom Town Centre
- Corner Shop and Bus Stops Close-by



Oakmead Green, Epsom, KT18

Approximate Area = 673 sq ft / 62.5 sq m

For identification only - Not to scale

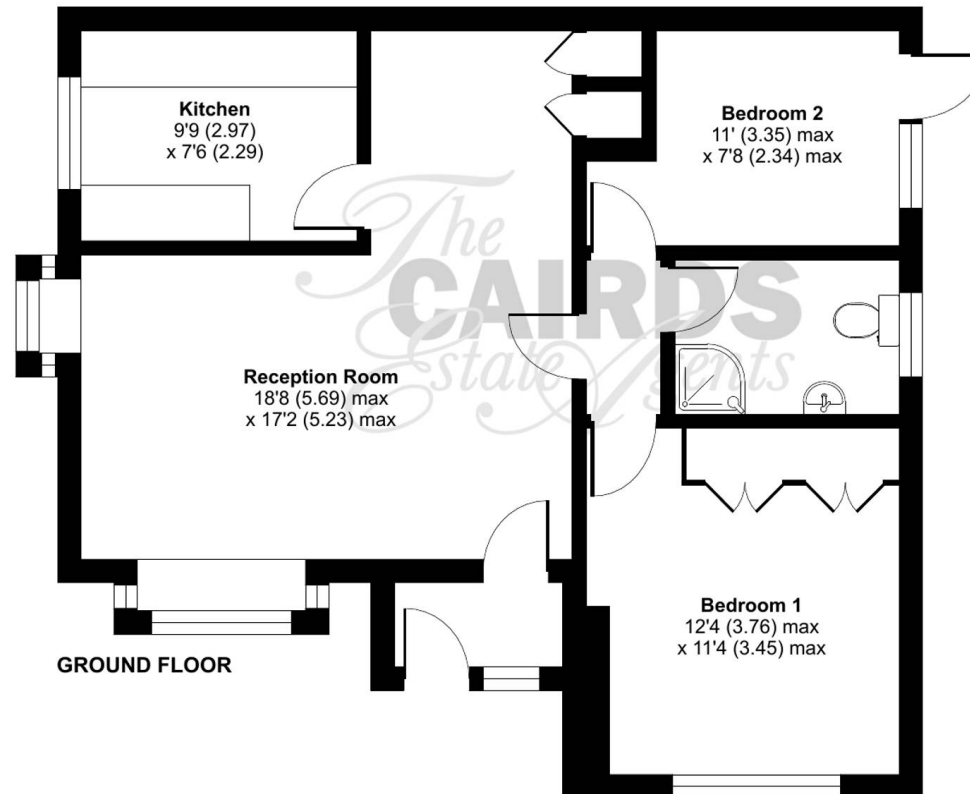

Floor plan produced in accordance with RICS Property Measurement Standards incorporating International Property Measurement Standards (IPMS2 Residential). ©nlcheom 2024. Produced for Cairds. REF: 1078964

