



27 Ty Bala , Saltney

OFFERS OVER
£140,000





This top floor apartment which offers light and spacious accommodation with a pleasant outlook from the good sized open plan lounge/dining kitchen area.

The apartment which would make a great first time buy or ready made investment benefits from recently having been re-decorated throughout in neutral tones with new carpets and flooring also renewed.

Offering two double bedrooms with westerly views off a bright hallway with a useful storage cupboard. The main bathroom is immaculately kept with a pristine white suite with a shower over the bath.

The living space being over 19ft wide offers a Juliet balcony before opening into a fitted kitchen with a range of white gloss fitted units with integrated cooking appliances and a washing machine.

The apartment is warmed by gas fired central heating via a combination boiler with UPVC double glazing throughout.

NO CHAIN.





FINER POINTS

- * Top floor apartment recently re-decorated apartment
- * Walking distance to a range of shops, supermarkets and a regular bus service to the City
- * Within easy travelling distance to Broughton Retail Park with its cinema & restaurants
- * Ideal first time home or easy to maintain investment property
- * Lower than average service charge at £1242.24 per annum
- * Allocated parking space with further visitor parking and on road parking

These particulars are intended to give a fair and substantially correct overall description for the guidance of intending purchasers and do not constitute an offer or part of a contract. Prospective purchasers ought to seek their own professional advice. All descriptions, dimensions, areas, reference to condition and necessary permissions for use and occupation and other details are given in good faith and are believed to be correct, but any intending purchasers should not rely on them as statements or representations of fact but must satisfy themselves by inspection or otherwise as to the correctness of each of them. All measurements are approximate.

Tenure: Leasehold

Local Authority: Flintshire County Council

Council Tax: Band C

Viewings: By appointment only

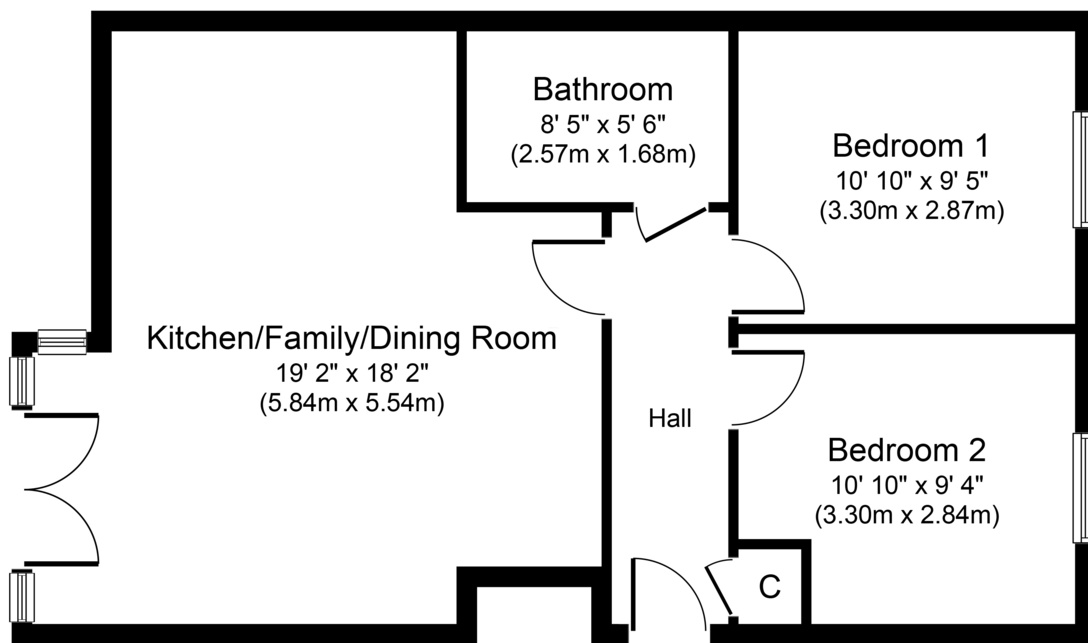

Approximate Floor Area
605 sq. ft.
(56.2 sq. m.)

Whilst every attempt has been made to ensure the accuracy of the floor plan contained here, measurements of doors, windows, rooms and any other items are approximate and no responsibility is taken for any error, omission, or mis-statement. The measurements should not be relied upon for valuation, transaction and/or funding purposes. This plan is for illustrative purposes only and should be used as such by any prospective purchaser or tenant. The services, systems and appliances shown have not been tested and no guarantee as to their operability or efficiency can be given.

Copyright V360 Ltd 2024 | www.houseviz.com

Office Address

11 Grosvenor Street
Chester, Cheshire
CH1 2DD

01244 313900

sales@curranshomes.co.uk

CURRANS
homes