

FOR SALE



Mexbrough Road, Bolton-On-Deerne
Guide Price £85,000

MARTIN&CO



Mexbrough Road, Bolton-On-Dearne

2 Bedrooms, 1 Bathroom

Guide Price £85,000

- Two bedrooms
- No chain
- Dining kitchen
- Garden to rear
- Commuter links

GUIDE PRICE £85,000 - £90,000. We have a fantastic two bedroom mid terrace property available, and it's offered with no chain. This property is a great opportunity for both private buyers and investors.

Conveniently situated, it provides easy access to commuter links, local amenities, and public transport links. As you enter, you'll find a front entrance porch leading into a spacious lounge with a front facing window. The inner hall leads you to the first floor landing via the stairs.

The dining kitchen is well-equipped with a range of fitted wall and base units, including an oven, hob, and extractor hood. Moving upstairs, you will find two bedrooms and a modern family bathroom, featuring a white three-piece suite and stylish tiling.

To the rear of the property, there is a patio-style garden where you can relax and enjoy some fresh air.

ENTRANCE PORCH With a front facing entrance door and door into the lounge.

LOUNGE A good size lounge with front facing window.



INNHER HALL With stairs rising to the first floor landing.

DINING KITCHEN With a range of fitted wall and base units, wall units include extractor hood. Base units are set beneath contrasting worktops which include a single bowl sink, oven, hob, plumbing for washing machine, tiled splash backs, rear facing window and rear facing entrance door.

LANDING

BEDROOM ONE A double size room with front facing window.

BEDROOM TWO A single size room with rear facing window.

BATHROOM With a white three piece suite which comprises of a low flush w.c, wash hand basin, bath, modern tiling and rear facing window.

OUTSIDE To the rear of the property is a patio style garden.







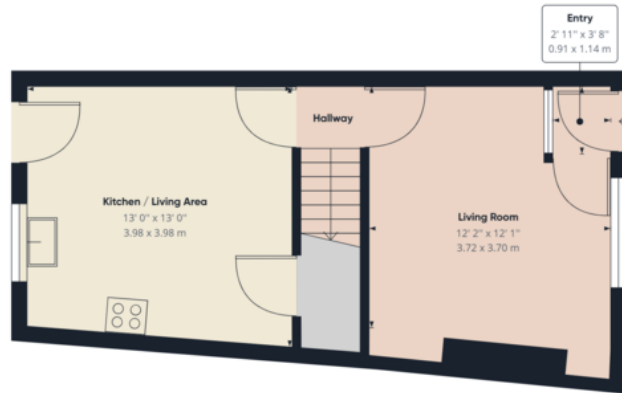

Ground Floor Building 1

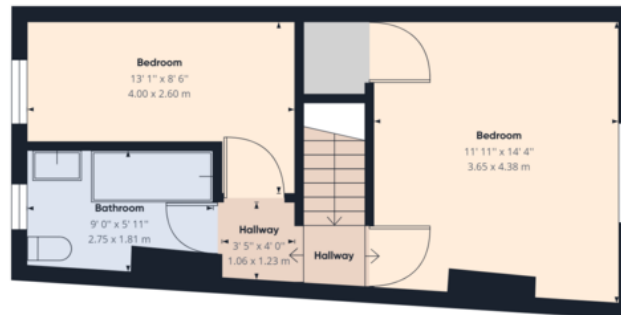

Approximate total area⁽¹⁾
695.86 ft²
64.65 m²

(1) Excluding balconies and terraces

While every attempt has been made to

Martin & Co Rotherham

5 Worry Goose Lane • Whiston • Rotherham • S60 4AA
T: 01709 544982 • E: rotherham@martinco.com

01709 544982

<http://www.martinco.com>



Accuracy: References to the Tenure of a Property are based on information supplied by the Seller. The Agent has not had sight of the title documents. A Buyer is advised to obtain verification from their Solicitor. Items shown in photographs including but not limited to carpets, fixtures and fittings are not included unless specifically mentioned within the sales particulars. They may however be available by separate negotiation. Buyers must check the availability of any property and make an appointment to view before embarking on any journey to see a property. No person in the employment of the agent has any authority to make any representation about the property, and accordingly any information given is entirely without responsibility on the part of the agents, sellers(s) or lessors(s). Any property particulars are not an offer or contract, nor form part of one. **Sonic / Laser Tape:** Measurements taken using a sonic / laser tape measure may be subject to a small margin of error. **All Measurements:** All Measurements are Approximate. **Services Not tested:** The Agent has not tested any apparatus, equipment, fixtures and fittings or services and so cannot verify that they are in working order or fit for the purpose. A Buyer is advised to obtain verification from their Solicitor or Surveyor.