

FOR SALE



Woodside Walk, Greasbrough
Asking Price Of £100,000

MARTIN&CO



Woodside Walk, Greasbrough

3 Bedrooms, 1 Bathroom

Asking Price Of £100,000

- Three bedrooms
- End townhouse
- Spacious
- Downstairs w.c
- Gardens

Situated on this popular development viewing is a must to appreciate this spacious three bedroom end townhouse. Offered with no chain involved, would suit an investor or private buyer. The property gives access to transport links, schools and local amenities. In brief the property comprises of entrance hall, downstairs w.c. Dining kitchen with fitted wall and base units, Lounge with feature fire surround and doors to the garden. First floor landing three bedrooms and shower room. Outside garden areas to front, side and rear.

ENTRANCE HALL With stairs rising to the first floor landing, access to the dining kitchen, cloak room and front facing entrance door.

CLOAKROOM With a low flush w.c and front facing window.

DINING KITCHEN A generous size room which has a range of fitted wall and base units in beech effect, wall units include extractor hood. Base units are set beneath worktops which include a single bowl sink, plumbing for washing machine, cooker point, tiled splash backs and front facing window.

LOUNGE With coving to the ceiling and laminate



flooring. The focal point of the room is the feature fire surround housing the gas fire, rear facing patio doors open to the rear garden.

LANDING

BEDROOM ONE With fitted wardrobes and front facing window.

BEDROOM TWO With fitted wardrobes and rear facing window.

BEDROOM THREE With a rear facing window.

SHOWER ROOM With a white three piece suite which comprises of a low flush w.c, wash hand basin, shower cubicle, tiled splash backs and front facing window.

OUTSIDE To the rear of the property is a paved patio, covered seating area and borders. To the front is a lawn which extends to the side.





%epcGraph_c_1_544%



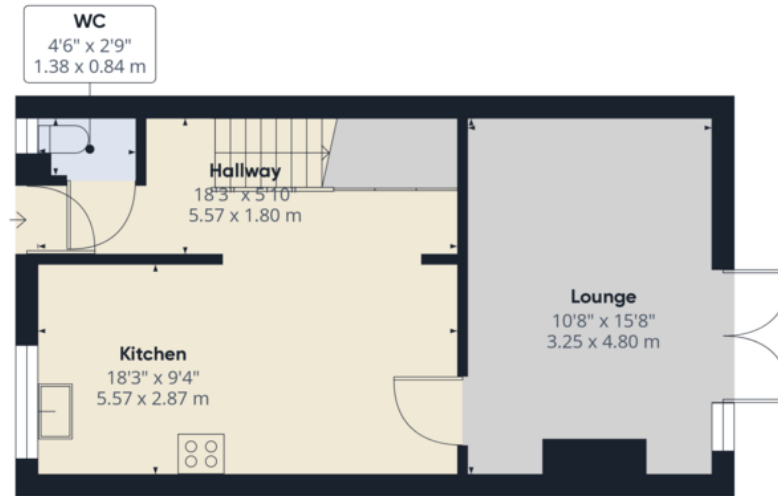

Ground Floor

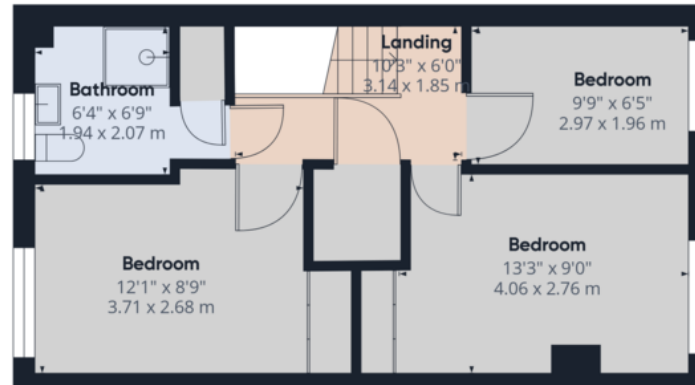

Approximate total area⁽¹⁾
873.75 ft²
81.17 m²

(1) Excluding balconies and terraces

While every attempt has been made to

Martin & Co Rotherham

5 Worry Goose Lane • Whiston • Rotherham • S60 4AA
T: 01709 544982 • E: rotherham@martinco.com

01709 544982

<http://www.martinco.com>



Accuracy: References to the Tenure of a Property are based on information supplied by the Seller. The Agent has not had sight of the title documents. A Buyer is advised to obtain verification from their Solicitor. Items shown in photographs including but not limited to carpets, fixtures and fittings are not included unless specifically mentioned within the sales particulars. They may however be available by separate negotiation. Buyers must check the availability of any property and make an appointment to view before embarking on any journey to see a property. No person in the employment of the agent has any authority to make any representation about the property, and accordingly any information given is entirely without responsibility on the part of the agents, sellers(s) or lessors(s). Any property particulars are not an offer or contract, nor form part of one. **Sonic / Laser Tape:** Measurements taken using a sonic / laser tape measure may be subject to a small margin of error. **All Measurements:** All Measurements are Approximate. **Services Not tested:** The Agent has not tested any apparatus, equipment, fixtures and fittings or services and so cannot verify that they are in working order or fit for the purpose. A Buyer is advised to obtain verification from their Solicitor or Surveyor.