



Alaska Buildings, Grange Road, SE1

London

£625,000



Building 800

Alaska Buildings, London

A charming two double bedroom flat in the popular Alaska Building development. Featuring wood flooring and wonderful natural light plus access to communal gardens.

Council Tax band: E

Tenure: Leasehold

EPC Energy Efficiency Rating: D

EPC Environmental Impact Rating: C

- 24 hour concierge
- Spacious living space with great natural light
- Modern fitted and equipped kitchen
- Communal gardens with ornamental pond
- Second Floor
- Beautifully presented interior
- Secure and gated Alaska Building development
- Secure parking spaces available rent
- Opposite Bermondsey Spa Gardens
- Superbly appointed bathroom refurbished in 2023



Grange Road, London, SE1

Approximate Area = 639 sq ft / 59.4 sq m

For identification only - Not to scale

DANIEL COBB

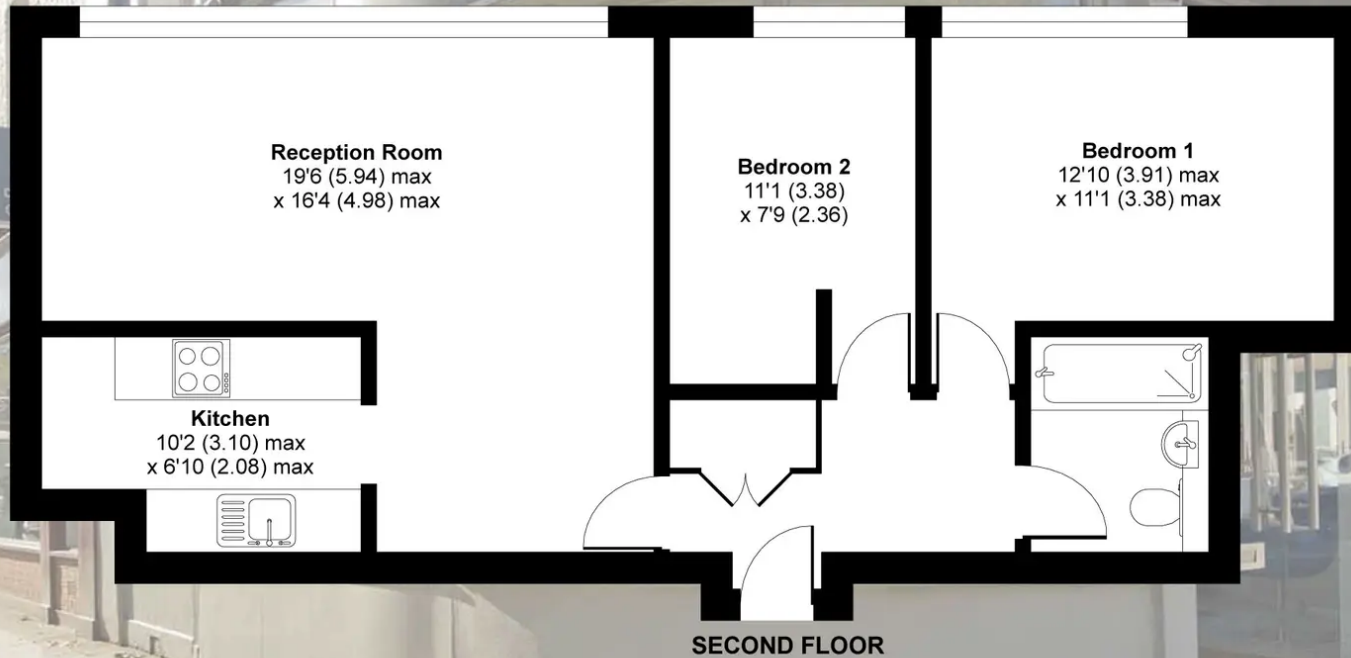

Floor plan produced in accordance with RICS Property Measurement Standards incorporating International Property Measurement Standards (IPMS2 Residential). © nichecom 2024. Produced for Daniel Cobb. REF: 1073102



Daniel Cobb

Daniel Cobb Estate Agents, 82-84 Bermondsey Street – SE1 3UD

020 7357 0026 • londonbridge@danielcobb.co.uk • www.danielcobb.co.uk/