

To Let 4 bed flat

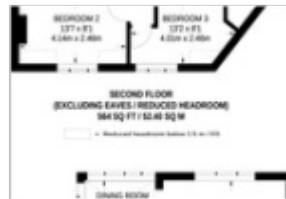

- › 4 BEDROOMS
- › FIRST FLOOR CONVERSION
- › SUIT SHARERS
- › CLOSE TO SHOPS AND STATION

STUNNING REFURBISHED 4 BEDROOM, 2 BATHROOM DUPLEX FLAT WITH PARKING IN GOLDERS GREEN AND ONLY MINUTES FROM THE STATION AND SHOPS. THE FLAT ALSO HAS A LARGE RECEPTION ROOM, CONSERVATORY, GUEST W/C AND A PARKING SPACE PLUS THERE IS A SMALL COMMUNAL GARDEN AVAILABLE





---

FINCHLEY ROAD GOLDERS GREEN, NW11 7PE

DREAMVIEW ESTATES ARE DELIGHTED TO BRING TO MARKET THIS MODERN NREFURBISHED DUPLEX FLAT IN GOLDERS GREEN.

THE FLAT BENEFITS FROM 4 BEDROOMS, 2 BATHROOMS (ONE EN SUITE), GUEST W/C, LARGE RECEPTION ROOM AND FULLY FITTED KITCHEN WITH EAT IN CONSERVATORY.

THE FLAT IS WITHIN 5 MINUTES WALKING DISTANCE FROM GOLDERS GREEN UNDERGROUND STATION AND COMES WITH 1 PARKING SPACE.

AVAILABLE 13/05/23



34 Golders Green Road, London NW11 8LL

[murray@dreamviewestates.co.uk](mailto:murray@dreamviewestates.co.uk)

020 8455 0055

best  
agent