



Crispin Close, New Romney

New Romney

£500,000

14 Crispin Close

New Romney, New Romney

Council Tax band: E

Tenure: Freehold

- Three Bedroom
- Ensuite to Master
- Driveway
- Central Location
- Modern House
- Car Charging Point
- Open Plan Living







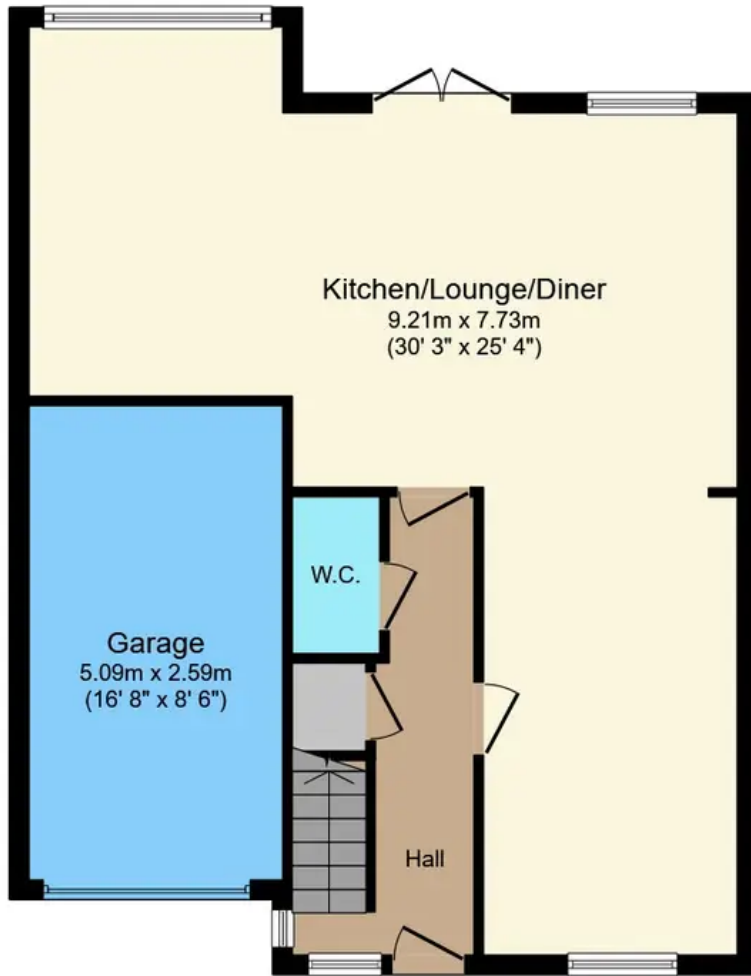

Ground Floor

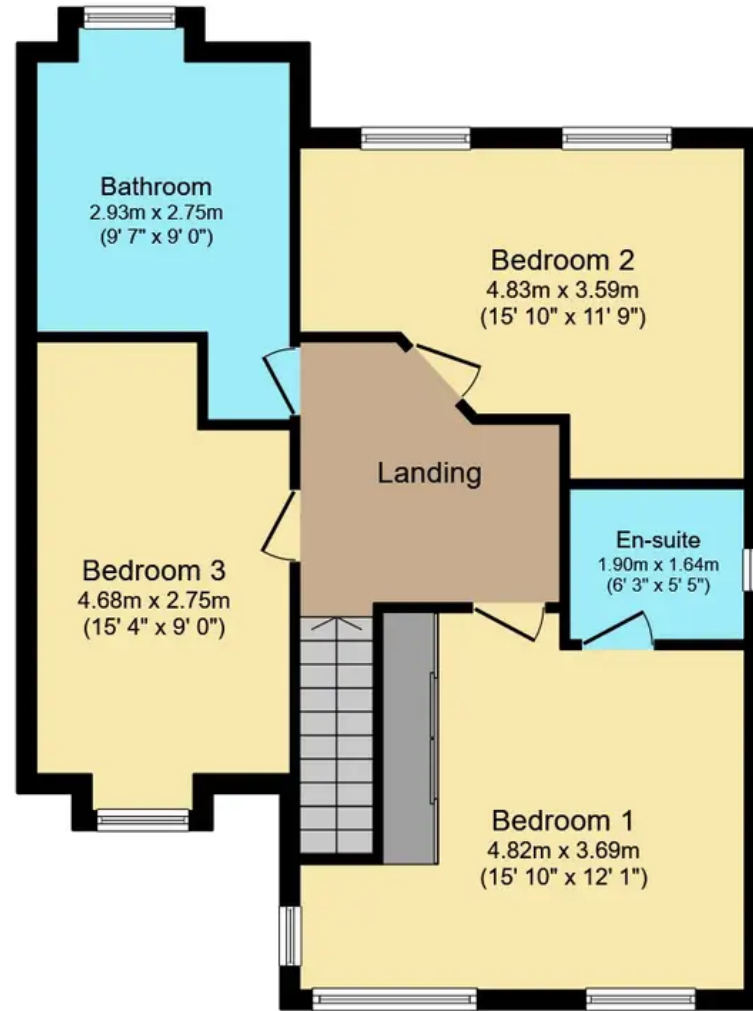

First Floor

Total floor area 136.9 sq.m. (1,474 sq.ft.) approx

This floor plan is for illustrative purposes only. It is not drawn to scale. Any measurements, floor areas (including any total floor area), openings and orientation are approximate. No details are guaranteed, they cannot be relied upon for any purpose and they do not form part of any agreement. No liability is taken for any error, omission or misstatement. A party must rely upon its own inspection(s).

Powered by www.focalagent.com

These particulars are intended to give a fair and reliable description of the property but no responsibility for any inaccuracy or error can be accepted and do not constitute an offer or contract. We have not tested any services or appliances (including central heating if fitted) referred to in these particulars and purchasers are advised to satisfy themselves as to the working order and condition, if a property is unoccupied at any time there may be reconnection charges for any switched off/disconnected or drained services or appliances. All measurements are approximate.



Andrew & Co Estate Agents - New Romney

01797 362898

newromney@andrewandco.co.uk

