



15 Lakeside Gardens Chapel Road, Hothfield
£220,000

15 Lakeside Gardens Chapel Road

Hothfield, Ashford

Charming large 1-bed apartment with living space of 71.5 sqm/769.4 sqft for over 55's. Well-presented interiors & spacious bedroom. Communal gardens, study, lounge, restaurant. Emergency call system, laundry, housekeeping available. Transport service to Ashford & beyond. Close-knit community & independent living.

Council Tax band: B

Tenure: Leasehold

- Large One Bedroom Apartment 71.5 sqm / 769.4 sqft
- Over 55's only
- Independent living
- On site communal areas & gardens
- Study
- Well presented
- On site restaurant
- Lifts
- Emergency Call System – each apartment has an emergency call system which operates 24 hours a day.
- Housekeeping – Residents can benefit from an hour of cleaning each week for a small additional charge.



Hallway

Lounge / Diner

21' 11" x 18' 2" (6.69m x 5.54m)

Kitchen

8' 6" x 8' 0" (2.58m x 2.44m)

Study

8' 10" x 11' 6" (2.68m x 3.50m)

Bedroom

12' 6" x 8' 10" (3.82m x 2.70m)

Shower Room



COMMUNAL GARDEN







Ground Floor

Approx. 71.5 sq. metres (769.4 sq. feet)

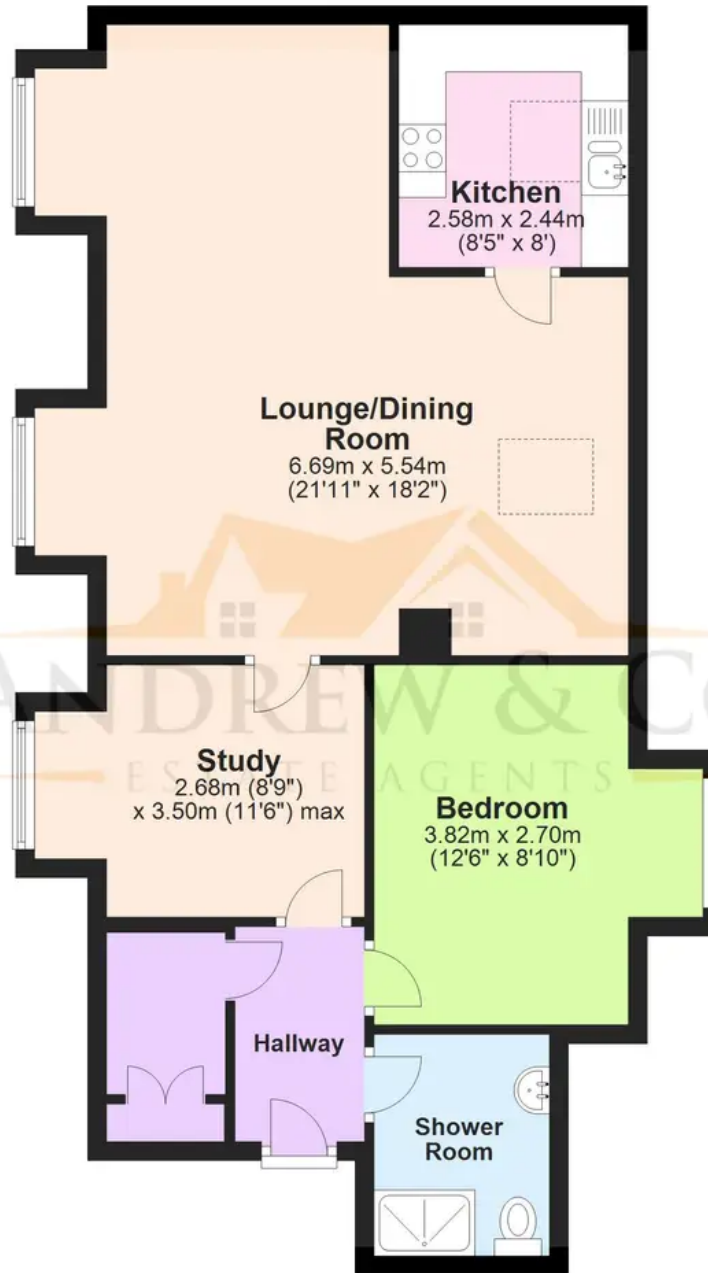

Total area: approx. 71.5 sq. metres (769.4 sq. feet)

Plans are for layout purposes only and are not drawn to scale, with any doors, windows and other internal features merely intended as a guide.
Plan produced using PlanUp.

These particulars are intended to give a fair and reliable description of the property but no responsibility for any inaccuracy or error can be accepted and do not constitute an offer or contract. We have not tested any services or appliances (including central heating if fitted) referred to in these particulars and purchasers are advised to satisfy themselves as to the working order and condition, if a property is unoccupied at any time there may be reconnection charges for any switched off/disconnected or drained services or appliances. All measurements are approximate.

Andrew & Co Estate Agents - Ashford

01233 632383

info@andrewandco.co.uk

