



Coast Drive, Lydd On Sea

Romney Marsh

Guide Price £260,000

Coast Drive

Lydd On Sea, Romney Marsh

Spacious two bed apartment with sea views. Large living room, galley kitchen, shower room, garden, and utility area. Close to shops, bus route, and beach. Ideal for coastal lifestyle.

Tenure: Leasehold

- First Floor
- Two Bedroom Apartment
- Large Bright Living Room
- Sea Views
- Galley Style Kitchen
- Shower Room
- Rear Garden
- Utility Area





Entrance Hall

Living Room

13' 11" x 20' 1" (4.24m x 6.11m)

Kitchen

7' 4" x 6' 5" (2.24m x 1.95m)

Utility Area

Bedroom

12' 0" x 10' 8" (3.65m x 3.26m)

Bedroom

11' 6" x 7' 7" (3.50m x 2.31m)

Shower Room

5' 6" x 6' 1" (1.67m x 1.86m)





First Floor

Approx. 62.5 sq. metres (673.1 sq. feet)

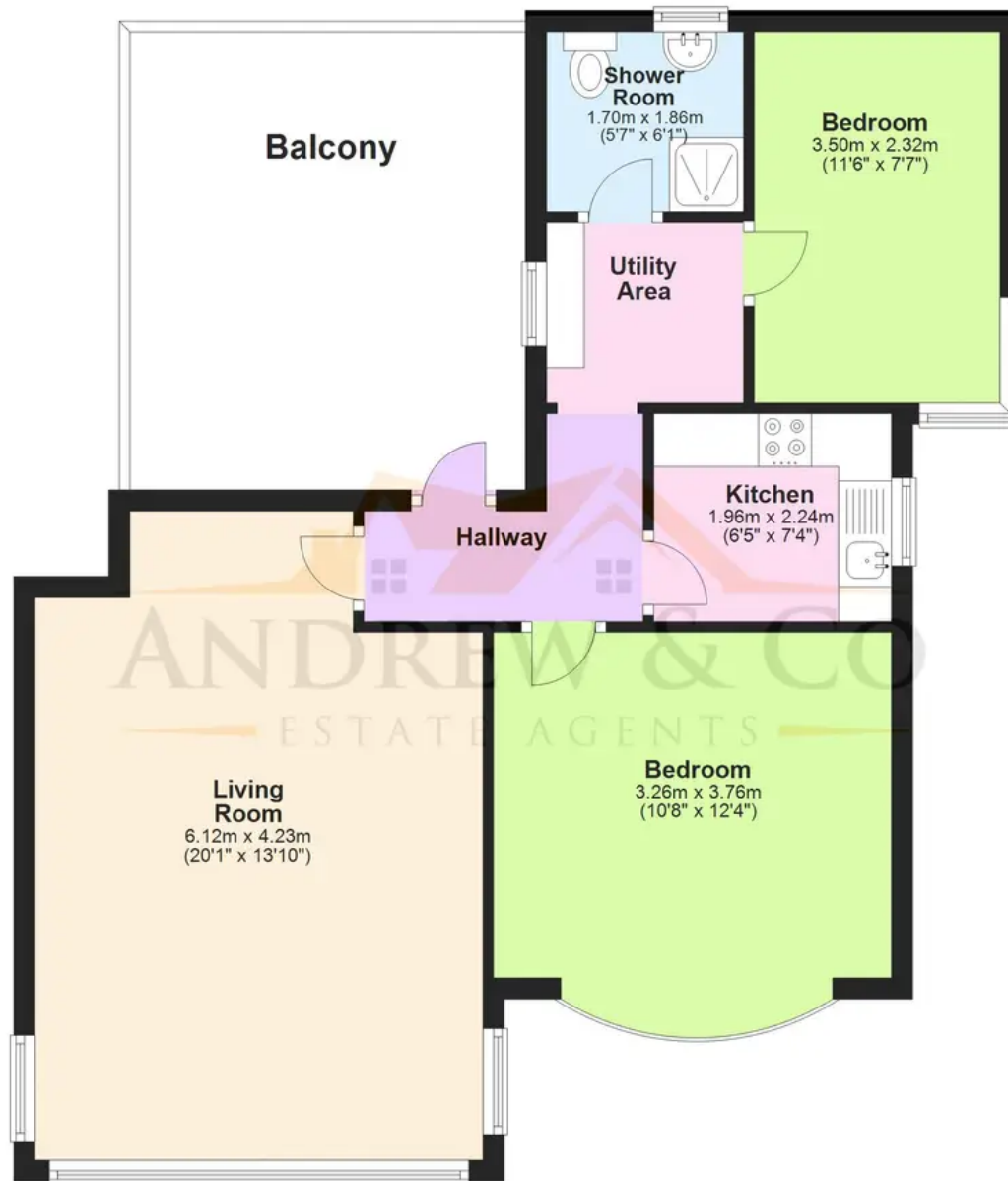

Total area: approx. 62.5 sq. metres (673.1 sq. feet)

Plans are for layout purposes only and not drawn to scale, with any doors, windows and other internal features merely intended as a guide.
Plan produced using PlanUp.

These particulars are intended to give a fair and reliable description of the property but no responsibility for any inaccuracy or error can be accepted and do not constitute an offer or contract. We have not tested any services or appliances (including central heating if fitted) referred to in these particulars and purchasers are advised to satisfy themselves as to the working order and condition, if a property is unoccupied at any time there may be reconnection charges for any switched off/disconnected or drained services or appliances. All measurements are approximate.



Andrew & Co Estate Agents - New Romney

01797 362898

newromney@andrewandco.co.uk

