



Tartane Lane, Dymchurch

Romney Marsh

£310,000

12 Tartane Lane

Dymchurch, Romney Marsh

Spacious Three bedroom terraced house in sought-after location. Large living space, well-appointed bedrooms, open-plan design, courtyard garden & close to beach. Potential for off-street parking. Chain-free. Ideal for comfortable & convenient living.

Council Tax band: C

Tenure: Freehold

- Three Double Bedrooms
- Mid Terrace Home
- Large Living Space
- Dining Area
- Courtyard Style Garden
- Large Bathroom
- Close to Sandy Beach
- Walking Distance to Village Centre Shops





Entrance Hall

Living Space

12' 8" x 23' 5" (3.85m x 7.14m)

Kitchen

10' 3" x 8' 3" (3.13m x 2.51m)

Wc

Garden Room

5' 1" x 7' 3" (1.56m x 2.21m)

Landing

Bedroom

9' 3" x 11' 5" (2.81m x 3.48m)

Bedroom

9' 3" x 11' 8" (2.81m x 3.56m)

Bedroom

8' 7" x 8' 6" (2.62m x 2.59m)

Bathroom





Ground Floor

Approx. 47.3 sq. metres (508.7 sq. feet)

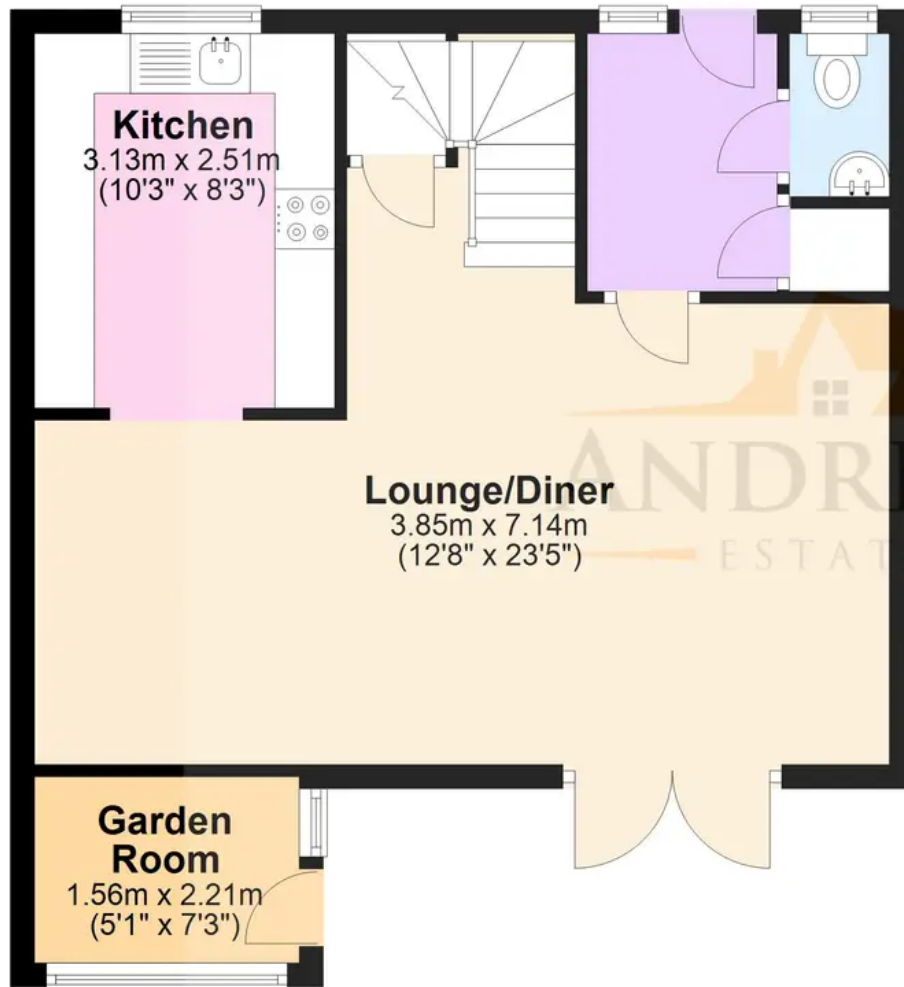

First Floor

Approx. 44.6 sq. metres (479.7 sq. feet)

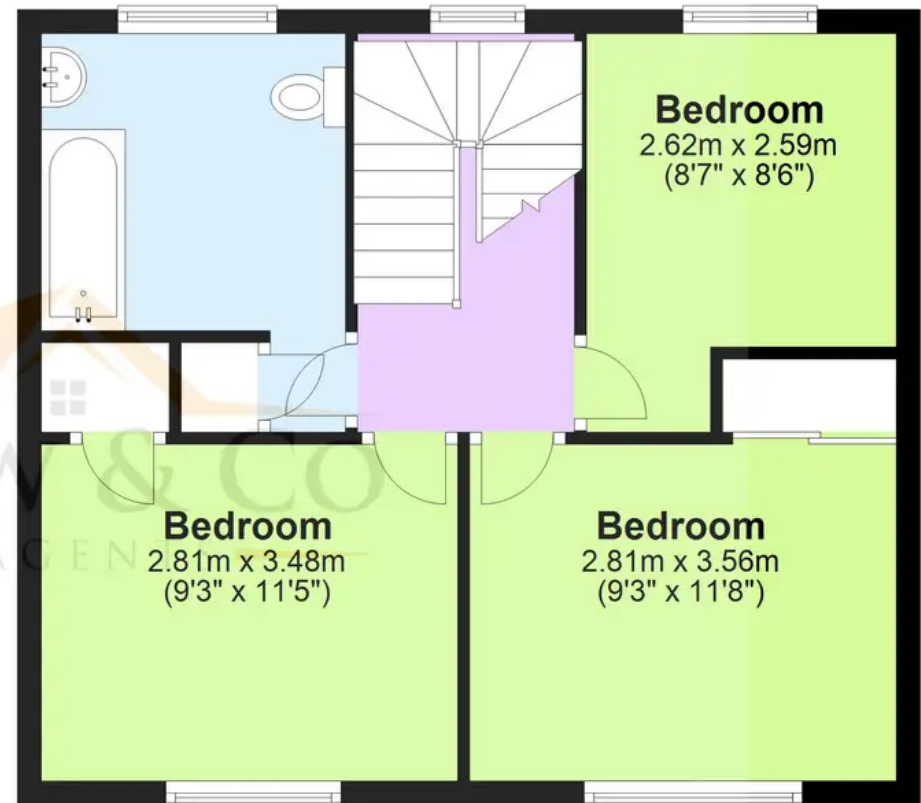

Total area: approx. 91.8 sq. metres (988.4 sq. feet)

Plans are for layout purposes only and not drawn to scale, with any doors, windows and other internal features merely intended as a guide.

Plan produced using PlanUp.

These particulars are intended to give a fair and reliable description of the property but no responsibility for any inaccuracy or error can be accepted and do not constitute an offer or contract. We have not tested any services or appliances (including central heating if fitted) referred to in these particulars and purchasers are advised to satisfy themselves as to the working order and condition, if a property is unoccupied at any time there may be reconnection charges for any switched off/disconnected or drained services or appliances. All measurements are approximate.



Andrew & Co Estate Agents - New Romney

01797 362898

newromney@andrewandco.co.uk

