



Coast Drive, Greatstone

New Romney

In Excess of £400,000

# 107 Coast Drive

Greatstone, New Romney

Impressive four bed semi-detached house with sea views. Stylish interior, spacious rooms, well-appointed kitchen & dining area. Enclosed garden, beach access. Conveniently close to amenities. A unique opportunity for a coastal lifestyle.

Council Tax band: D

Tenure: Freehold

- Four Bedroom
- Semi Detached Home
- Sea Views
- Recently Decorated
- Kitchen / Diner
- Large Living Room
- Close to Local Shops
- Chain Free





**Entrance Hall**

**Living Room**

16' 9" x 18' 7" (5.11m x 5.67m)

**Kitchen/Diner**

16' 4" x 11' 11" (4.97m x 3.63m)

**Utility Room**

5' 2" x 9' 1" (1.58m x 2.76m)

**WC**

**Landing**

**Bedroom**

12' 8" x 10' 7" (3.86m x 3.23m)

**Bedroom**

12' 7" x 9' 4" (3.84m x 2.85m)

**Bedroom**

12' 8" x 8' 7" (3.85m x 2.62m)

**Bedroom**

8' 10" x 10' 0" (2.70m x 3.06m)

**Bathroom**

8' 8" x 9' 1" (2.63m x 2.76m)





## Ground Floor

Approx. 58.5 sq. metres (629.6 sq. feet)



## First Floor

Approx. 58.5 sq. metres (629.6 sq. feet)

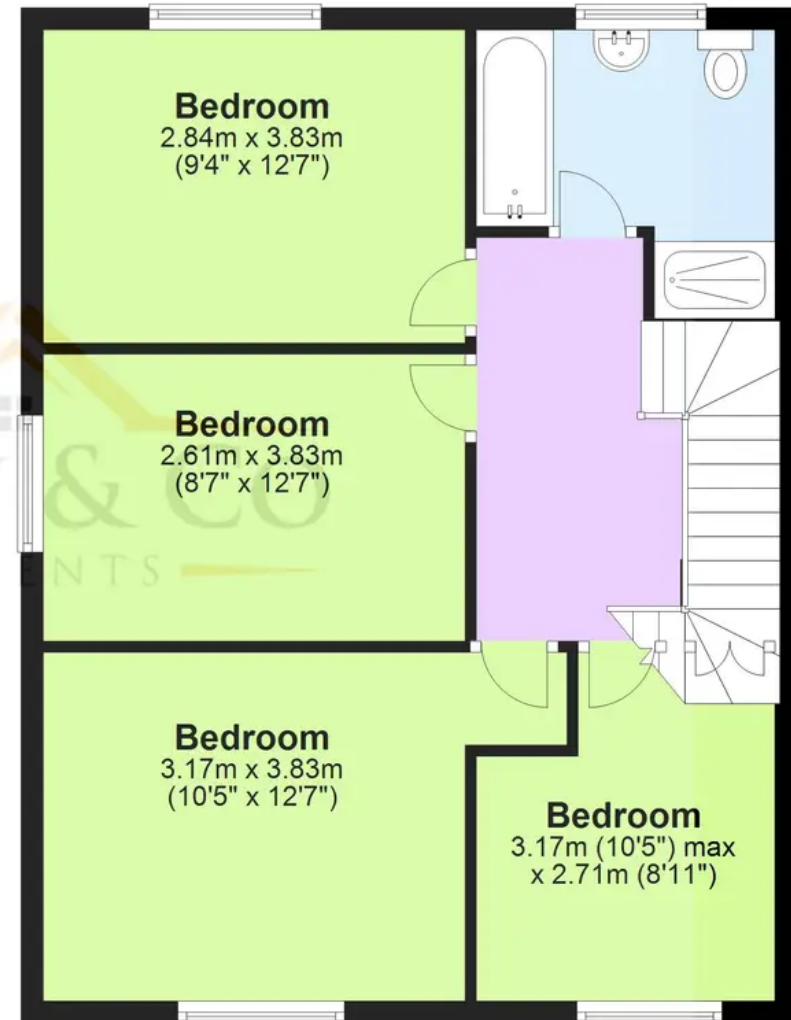

Total area: approx. 117.0 sq. metres (1259.2 sq. feet)

Plans are for layout purposes only and not drawn to scale, with any doors, windows and other internal features merely intended as a guide.

Plan produced using PlanUp.

These particulars are intended to give a fair and reliable description of the property but no responsibility for any inaccuracy or error can be accepted and do not constitute an offer or contract. We have not tested any services or appliances (including central heating if fitted) referred to in these particulars and purchasers are advised to satisfy themselves as to the working order and condition, if a property is unoccupied at any time there may be reconnection charges for any switched off/disconnected or drained services or appliances. All measurements are approximate.



**Andrew & Co Estate Agents - New Romney**

01797 362898

[newromney@andrewandco.co.uk](mailto:newromney@andrewandco.co.uk)

