



**Heaton House,
43a Front Road, Woodchurch, Kent TN26 3SA**

Heaton House, 43a Front Road, Woodchurch TN26 3SA Guide Price : £650,000

This deceptively spacious 4 bedroom / 2 bathroom detached house with enclosed garden, gated driveway with off-street parking for several cars and detached garage, is located in the centre of the beautiful and very sought after village of Woodchurch, just a short walk from all the amenities on offer.

The light, bright accommodation is presented in good order and has a modern feel. On the ground floor there is a cloakroom, open plan kitchen / breakfast / family room, spacious sitting room with fireplace and wood burner, and separate dining room which has bi-folding doors to the garden. To the first floor, there is a modern bathroom and four bedrooms, the principal having good amounts of built-in storage and en-suite shower room.

Outside, a shared driveway leads to a gated and very secure off-street parking area for several cars at the back of the house, where there is also a detached brick built garage. To the front of the property are two garden areas laid mainly to lawn, one of which is very private, perfect for summer relaxation, especially since there is the added bonus of a hot tub.

- Deceptively spacious 4 bed / 2 bath detached house
- Light, bright well-presented accommodation throughout
- Good size open plan kitchen / breakfast / family room
- Spacious sitting room with fireplace and woodburning stove
- Two separate enclosed garden areas, one with hot tub
- Gated drive for off street parking / detached garage
- Located in village centre close to all local amenities
- Wide choice of good local schools including Grammars
- Nearby towns of Tenterden & Ashford 4 and 8 miles distant
- High speed rail link to St Pancras from Ashford

SITUATION: The property is situated in a very convenient position in the centre of the thriving village of Woodchurch famous for its beautiful village green. Amenities include a general store, newsagent and post office, two village pubs, butcher, garage, Doctor's Surgery, Church and Primary School. More comprehensive shopping and leisure / health facilities can be found in the nearby towns of Tenterden and Ashford (about 4 and 8 miles distant). There are a number of active clubs and societies in Woodchurch catering for all ages and the village is surrounded by beautiful countryside where there are many good walks to enjoy. There is a good selection of schools within the area, both state and independent, and Woodchurch is within the catchment for the well-regarded Ashford Grammars. The area is well served for transport links. Ashford International Station offers the high-speed service to London St Pancras (a journey of about 40 minutes).

www.warnergray.co.uk

info@warnergray.co.uk Tel : 01580 766044

Warner Gray



The front door opens into an **ENTRANCE LOBBY** that gives access to the sitting room, dining room and cloakroom.

SITTING ROOM 17'2 x 15'8. This large room has a light, bright, homely feel and is perfect for family relaxation. A brick fireplace with wood burner makes a cosy focal point for those colder days and evenings. French doors give access to the gated parking area at the back of the house and an internal door connects this space with the kitchen. Staircase to first floor.

KITCHEN / BREAKFAST / FAMILY ROOM 17'3 x 17'2. This good size L-shaped open plan room, with its modern shaker style kitchen, breakfast and sitting areas, makes a very practical and sociable family living space. There are a range of fitted kitchen units with worktops and sink with drainer and mixer tap. Electric hob with extractor above and built-in oven below. Space for American style fridge / freezer, washing machine, dryer, dishwasher and additional under counter fridge.

DINING ROOM 13'11 x 9'7. This generous dining room takes a large table and chairs. Bi-fold doors at one end open this space onto the garden beyond and a roof lantern brings in lots of natural light.

CLOAKROOM Handily positioned just off of the entrance lobby and comprising a WC and wash basin.

Turned stairs from the ground floor sitting room lead to a **FIRST FLOOR LANDING** where there is access to all the bedrooms, bathroom and loft.

BEDROOM 1 18'0 x 9'5. A good size double bedroom with **EN-SUITE** comprising an enclosed shower with sliding door and wash basin with storage cupboard below. Built-in wardrobes to one wall with mirrored sliding doors. Window to front.

BEDROOM 2 9'8 x 9'6. Double bedroom with window to the rear.

BEDROOM 3 8'3 x 7'9. Third bedroom with window to the front.

BEDROOM 4 8'1 x 7'9. Fourth bedroom with window to the rear. This would also make an ideal study or home office.

BATHROOM Modern suite comprising panelled bath with shower over, pedestal wash basin and WC. Built-in airing cupboard housing hot water cylinder.

OUTSIDE To the front of the property is a deceptively large garden, currently divided into two areas, both laid mainly to lawn with mature shrubs and hedging. Behind the mature hedge, which runs alongside the gravel path to the front door, is a very private well screened garden area where there is a hot tub which we understand is included in the sale. A shared driveway to the side of the property leads to a gated area at the back of the house providing off road parking for a number of vehicles. This property also benefits from a detached brick GARAGE. The famous Woodchurch village green is only a short walk away and there are many wonderful countryside walks literally on the doorstep.

SERVICES : Mains: water, electricity, gas and drainage. EPC Rating: tba. Local Authority: Ashford Borough Council. LOCATION FINDER : what3words: ///dramatic.arrives.panoramic



Ground Floor

Approx. 62.7 sq. metres (675.0 sq. feet)

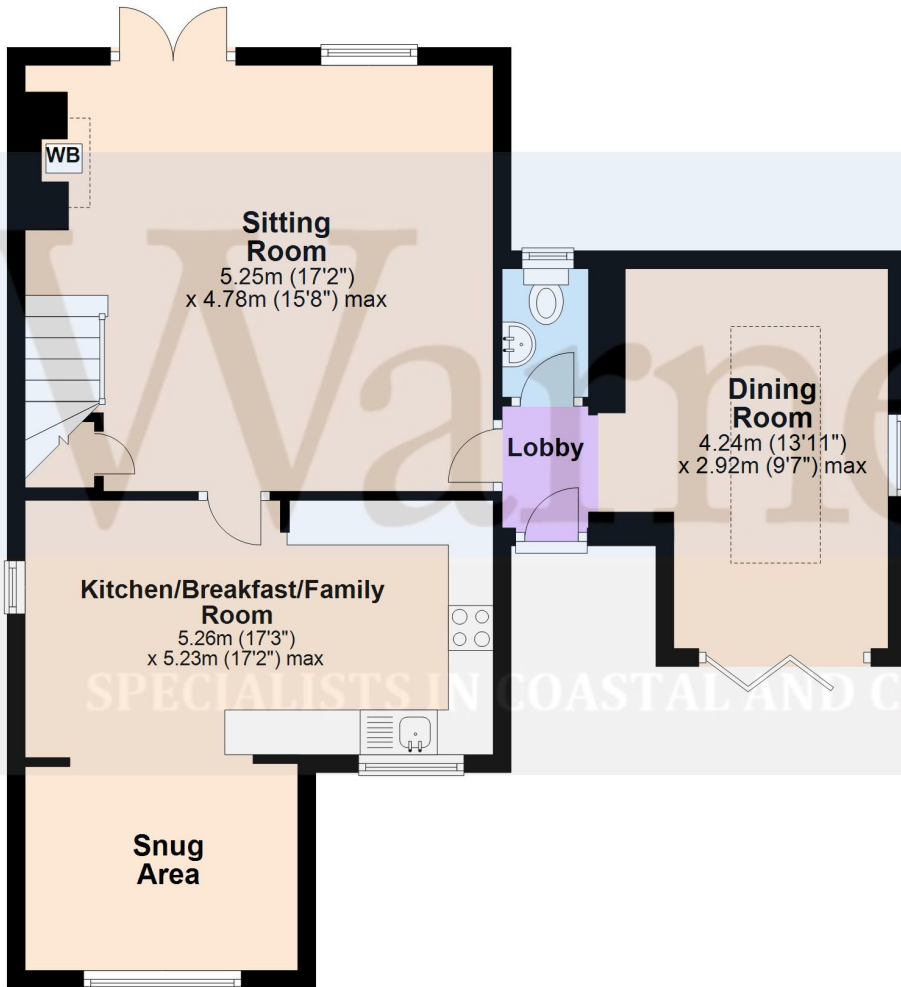

First Floor

Approx. 50.3 sq. metres (541.8 sq. feet)

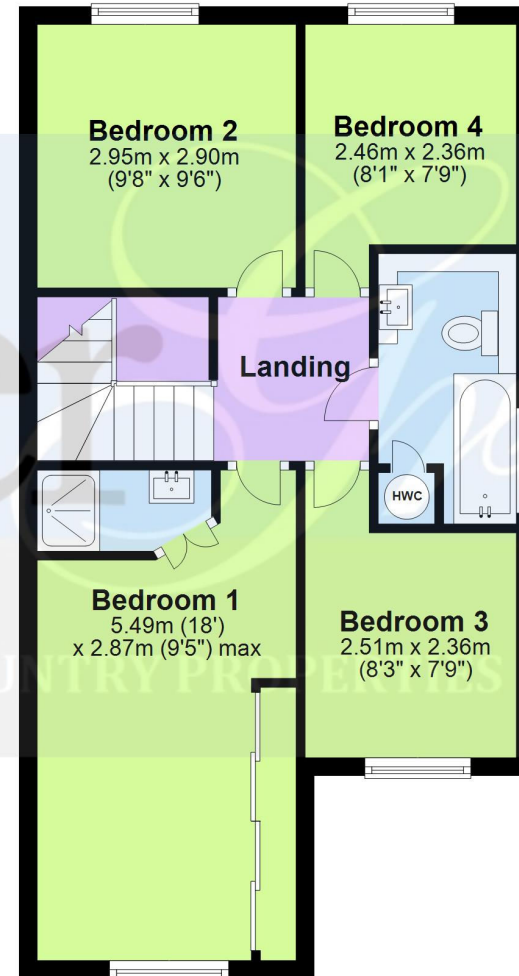

Garage

Approx. 16.5 sq. metres (177.5 sq. feet)

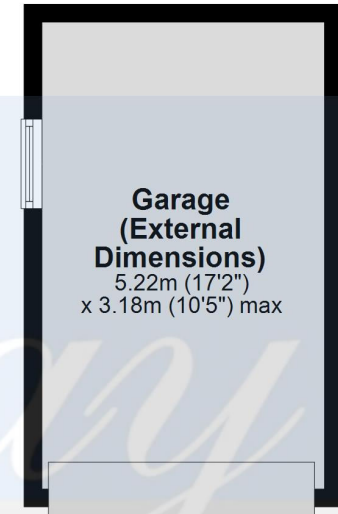

Total area: approx. 129.5 sq. metres (1394.3 sq. feet)

Plans are for layout purposes only and are not drawn to scale, with any doors, windows and other internal features merely intended as a guide.
Plan produced using PlanUp.



All measurements are approximate. These particulars are produced in good faith, but are intended to be a general guide only and do not constitute any part of an offer or contract. No person in the employment of WarnerGray, their clients and any joint agents have any authority to make any representation of warranty whatsoever in relation to the property. Photographs are reproduced for general information only and do not imply that any item is included for sale with the property. WarnerGray advises purchasers to satisfy themselves by inspection of the property. It should not be assumed that the property has all the necessary planning, building regulations or other consents regarding alterations.



